

F.A. RTE.	SECTION	COUNTY	TOTAL SHEETS	SHEET NO.
337	19R-1	LAKE	800	270
STA.		TO STA.		
FED. ROAD DIST. NO.		ILLINOIS FED. AID PROJECT		

60997

PIPE NO.	M2A	M2	M3	M4	M5	M6	M7	M8	M9	M10	M11	M12	M13	M14	M15	M18	M19	M51	M21	M22	M29	M30	M31	M32	M50	M51
SIZE (mm)	300	1050	300	1050	300	1050	300	1050	300	1050	300	300	1050	300	300	300	300	900	300	300	300	300	300	300	900	900
LENGTH (m)	2.4	2.6	5.2	24.2	3.3	28.5	3.2	35.5	1.7	32.5	1.7	1.0	24.5	3.2	3.7	9.9	9.9	21.2	12.1	12.1	3.0	2.6	17.8	1.7	20.5	21.2
TYPE	3	3	1	3	1	3	1	3	1	2	1	1	2	2	1	1	1	3.0	1	1	1	1	1	3.0	3.0	
T.B.F. (CU. M.)																										

*WM WATER MAIN REQUIREMENTS

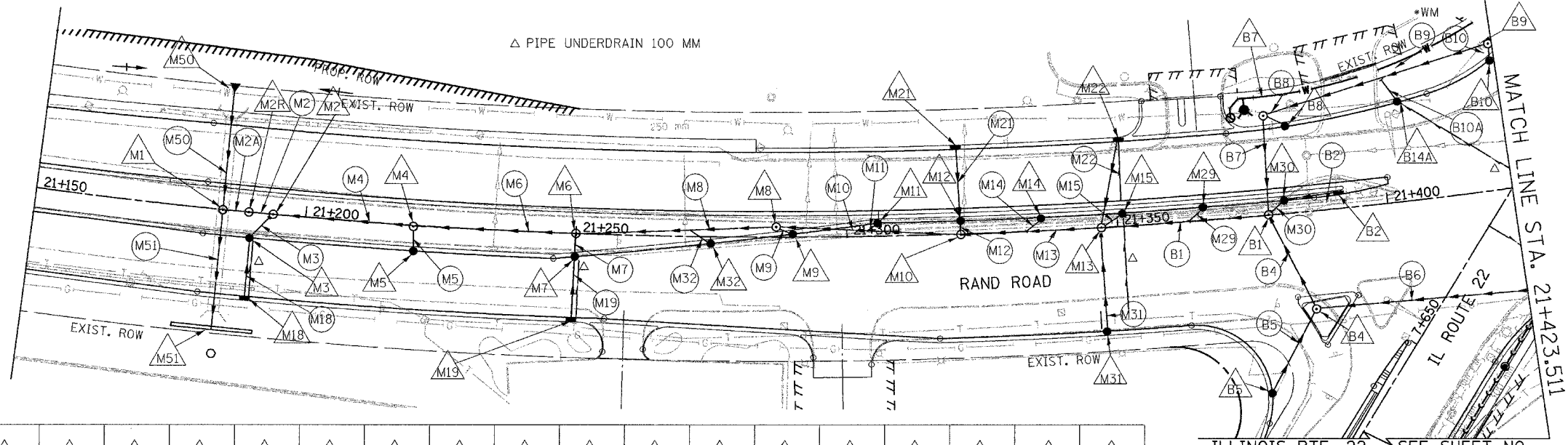

FOR STR. NO'S B1-B10 & PIPES NO'S B2-B10 SEE SHEET NO. 260

STR. NO.	M1	M2	M3	M4	M5	M6	M7	M8	M9	M10	M11	M12	M13	M14	M15	M18	M19	M2R	M21
STA.	21+185.0	21+194.0	21+190.0	21+220.0	21+220.0	21+250.0	21+250.0	21+287.0	21+190.0	21+321.0	21+306.0	21+321	21+347.0	21+336.0	21+351.0	21+190.0	21+250.0	21+189.5	21+321.0
OFF. (m)	0.0 RT	0.00	4.75RT	0.00	4.75 RT	0.00	4.27RT	2.00LT	0.64LT	0.00	2.45LT	2.45LT	0.00	2.45 LT	2.45 LT	15.55RT	15.55RT	0.00 RT	15.55 LT
TYPE	MH-A	MH-A	CB-A	MH-A	CB-A	MH-A	CB-A	MH-A	CB-A	MH-A	CB-A	CB-A	MH-A	CB-A	CB-A	INL-A	INL-A	O.C.S.	INL-A
DIA. (m)	2.1	2.1	1.2	1.5	1.2	1.5	1.2	1.5	1.2	1.5	1.2	1.5	1.2	1.2	1.2	0.6	0.6	1.8	0.6
F&G	T-1-CL	T-1-CL	T-24	T-1-CL	T-24	T-1-CL	T-24	T-1-CL	T-24	T-1-CL	T-24	T-24	T-1-CL	T-24	T-24	T-24	T-24	T-1-CL	T-24
RIM EL.	259.290	259.577	259.054	259.386	258.821	259.239	258.693	258.629	258.459	258.345	258.368	258.308	258.241	258.248	258.188	259.334	258.981	258.929	258.135
INV. N	255.827	255.827	259.054	259.386	258.821	259.239	258.693	258.629	258.459	258.345	258.368	258.308	258.241	258.248	258.188	259.334	258.981	258.929	258.135
INV. S	254.658	257.950	258.000	257.770	257.800	259.239	257.700	257.700	257.700	257.370	255.046	255.176	255.274	257.200	256.880	255.100	257.800	254.682	257.100
INV. E	254.658	254.692	258.000	254.790	254.904	254.904	254.790	255.046	255.046	255.046	255.046	255.176	255.274	257.200	256.880	255.100	257.800	254.682	257.100
INV. W	254.658	254.692	258.000	254.790	254.904	254.904	254.790	255.046	255.046	255.046	255.176	255.274	257.200	256.880	255.100	257.800	254.682	257.100	257.100

STR. NO.	M22	M29	M30	M31	M32	M50	M51
STA.	21+351.0	21+366.0	21+381.0	21+347	21+275.0	21+185.0	21+185.0
OFF. (m)	15.55 LT	2.45LT	2.45 LT	19.15 RT	1.27 RT	21.5 LT	22.25 RT
TYPE	INL-A	CB-A	CB-A	CB-A	CB-A	FES	HEAD-WALL
DIA. (m)	0.6	1.2	1.2	1.2	1.2	900 MM	
F&G	T-24	T-24	T-24	T-24	T-24		
RIM EL.	257.976	258.128	258.068	258.521	258.538	256.800	254.573
INV. N	257.976	258.128	258.068	258.521	258.538	256.800	254.573
INV. S	257.000			257.500	257.500		
INV. E	257.000			257.500	257.500		
INV. W	257.000	257.100	257.000				

U.S. ROUTE 12 (RAND ROAD)

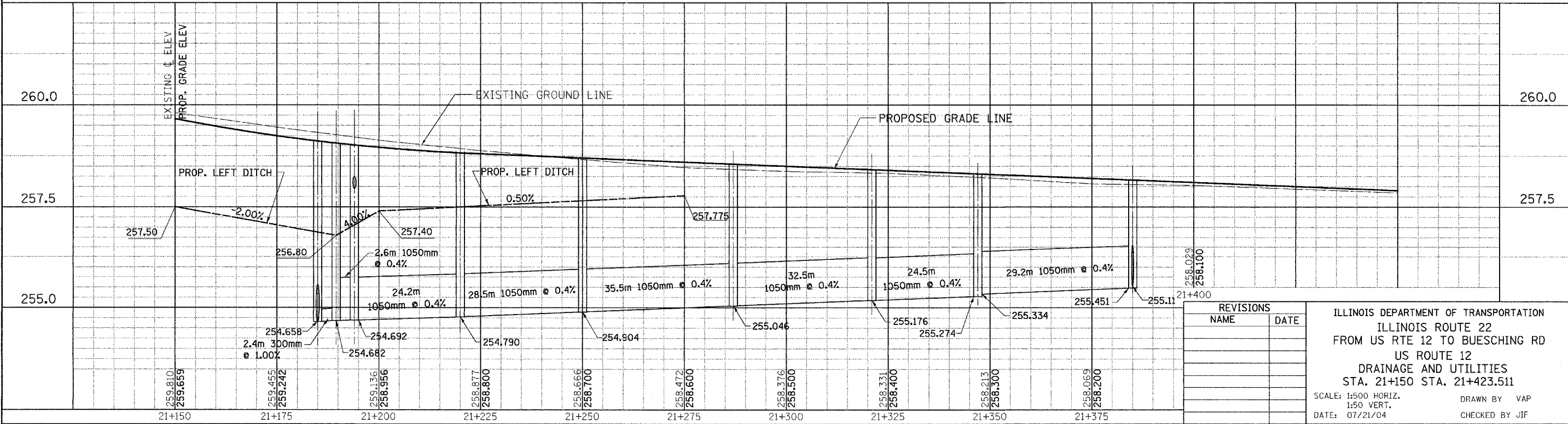

REVISIONS	
NAME	DATE

ILLINOIS DEPARTMENT OF TRANSPORTATION
 ILLINOIS ROUTE 22
 FROM US RTE 12 TO BUESCHING RD
 US ROUTE 12
 DRAINAGE AND UTILITIES
 STA. 21+150 STA. 21+423.511
 SCALE: 1:500 HORIZ.
 1:50 VERT.
 DATE: 07/21/04
 DRAWN BY VAP
 CHECKED BY JIF

DATE: _____
 BY: _____
 ORIGINAL SURVEY PLOTTED _____
 SURVEY PLOTTED _____
 NOTE BOOK _____
 TEMPLATE _____
 AREAS CHECKED _____
 NO. _____

DATE: _____
 BY: _____
 ORIGINAL SURVEY PLOTTED _____
 SURVEY PLOTTED _____
 NOTE BOOK _____
 TEMPLATE _____
 AREAS CHECKED _____
 NO. _____