

F.A. RTE.	SECTION	COUNTY	TOTAL SHEETS	SHEET NO.
337	19R-1	LAKE	800	272
STA.		TO STA.		
FED. ROAD DIST. NO.		ILLINOIS FED. AID PROJECT		

60997

PIPE NO.	(N1)	(P1)	(P2)	(P3)	(P4)	(P5)	(P6)	(P7)	(P8)	(P9)	(P16A)	(P5A)	(P8A)	(P11)	(P12)
SIZE (mm)	750	750	300	300	375	300	300	300	300	300	300	300	300	300	300
LENGTH (m)	28.5	20.8	3.2	14.4	38.4	3.1	12.4	33.8	2.4	28.8	2.7	11.7	1.9	12.2	11.7
TYPE	2	2	1	1	2	1	1	2	1	2	1	1	1	1	1
T.B.F. (CU. M.)											N/A				

PIPE NO.	(N1A)	(N1B)	(N1C)	(N7A)	(N9A)	(N9B)	(N9C)	(N10A)	(N18A)	(N22A)	(N27A)	(N32A)
SIZE (mm)	750	300	300	300	300	300	300	300	300	300	300	300
LENGTH (m)	21.0	2.7	9.9	9.9	1.7	3.8	3.8	9.9	9.9	9.9	9.9	9.9
TYPE	2	1	1	1	1	1	1	1	1	1	1	1
T.B.F. (CU. M.)												

FINAL SURVEYED BY: DATE: ORIGINAL SURVEYED BY: DATE: SURVEY PLOTTED BY: DATE: NOTE BOOK TEMPLATE NO. AREAS CHECKED: NO.

FOR LEGEND SEE SHEET NO.

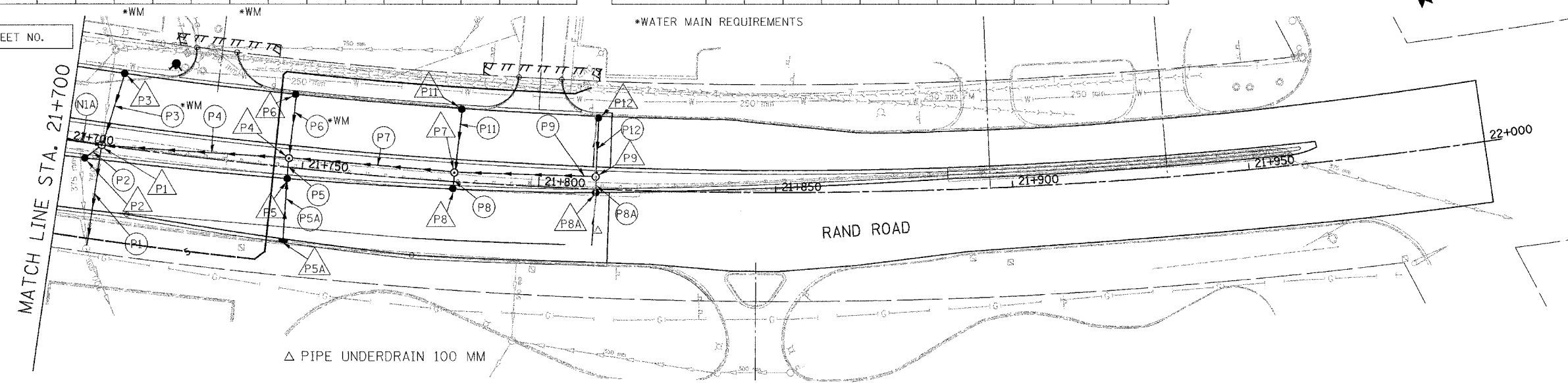

STR. NO.	(P1)	(P2)	(P3)	(P4)	(P5)	(P6)	(P7)	(P8)	(P9)	(P5A)	(P8A)	(P11)	(P12)
STA.	21+707.5	21+704.0	21+710.0	21+747.0	21+747.0	21+747.0	21+782.0	21+782.0	21+812.0	21+747.0	21+782.0	21+782.0	21+812.0
OFF. (m)	0.00	3.25 RT	15.65LT	2.00 LT	2.34 RT	15.55 LT	2.00 LT	1.58 RT	2.57LT	15.13RT	0.6RT	15.48LT	15.42LT
TYPE	MH-A	CB-A	CB-A	MH-A	CB-A	CB-A	MH-A	CB-A	MH-A	INL-A	CB-A	CB-A	CB-A
DIA. (m)	1.5	1.2	1.2	1.2	1.2	1.2	1.2	1.2	1.2	0.6	1.2	1.2	1.2
F&G	T-1-CL	T-24	T-24	T-1-CL	T-24	T-24	T-1-CL	T-24	T-1-CL	T-24	T-24	T-24	T-24
RIM EL.	258.074	257.798	257.623	258.730	258.538	258.293	258.320	259.177	259.913	258.805	259.721	258.944	259.503
INV. N	256.457	256.700		257.200	257.500		257.800	258.100	258.400	257.800	258.700		
INV. S	254.450		256.600	257.470	257.600	257.300	258.070		258.600		257.900	258.500	
INV. E	256.067			256.900			257.675						
INV. W	254.836			256.840			257.600		258.103				

STR. NO.	(N1A)	(N1B)	(N1C)	(N7A)	(N9A)	(N9B)	(N9C)	(N10A)	(N18A)	(N22A)	(N27A)	(N32A)
STA.	21+685.0	21+685.0	21+685.0	21+636.0	21+600.0	21+595.0	21+605.0	21+600.0	21+571.0	21+540.0	21+509.0	21+478.0
OFF. (m)	0.00	3.7RT	14.5RT	15.55RT	0.5LT	0.1RT	1.13LT	15.55RT	15.55RT	15.55RT	15.55RT	15.55RT
TYPE	MH-A	CB-A	INL-A	INL-A	CB-A	INL-A	INL-A	INL-A	INL-A	INL-A	INL-A	INL-A
DIA. (m)	1.5	1.2	0.6	0.6	1.2	0.6	0.6	0.6	0.6	0.6	0.6	0.6
F&G	T-1-CL	T-24	T-24	T-24	T-24	T-24	T-24	T-24	T-24	T-24	T-24	T-24
RIM EL.	258.180	257.645	257.926	257.725	257.276	257.269	257.287	257.340	257.697	257.821	257.945	258.069
INV. N	256.056	256.600	256.700	256.500	256.017			256.131	256.600	256.500	256.800	257.000
INV. S	256.573	256.600			256.017				256.600			
INV. E	254.959				256.017	256.055						
INV. W	255.019				256.017		256.055					

PROPOSED U.S. ROUTE 12 (RAND ROAD)

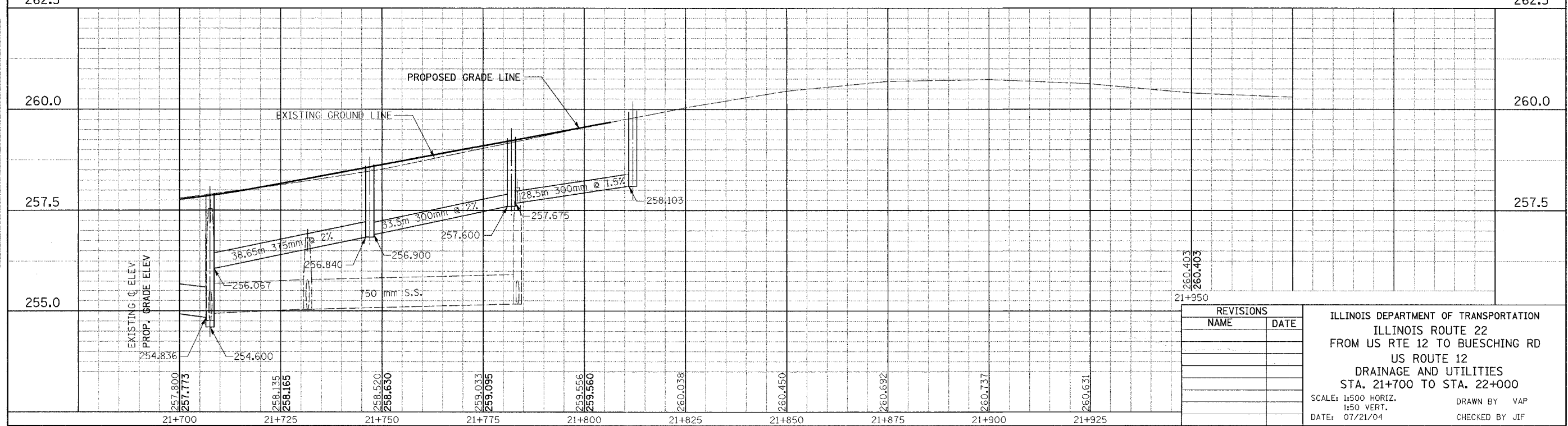

ORIGINAL SURVEYED BY: DATE: SURVEY PLOTTED BY: DATE: NOTE BOOK TEMPLATE NO. AREAS CHECKED: NO.

REVISIONS	
NAME	DATE

ILLINOIS DEPARTMENT OF TRANSPORTATION  
 ILLINOIS ROUTE 22  
 FROM US RTE 12 TO BUESCHING RD  
 US ROUTE 12  
 DRAINAGE AND UTILITIES  
 STA. 21+700 TO STA. 22+000  
 SCALE: 1:500 HORIZ. DRAWN BY VAP  
 1:50 VERT. CHECKED BY JIF  
 DATE: 07/21/04