

F.A. RTE.	SECTION	COUNTY	TOTAL SHEETS	SHEET NO.
337	19R-1	LAKE	800	339
STA.		TO STA.		
FED. ROAD DIST. NO.		ILLINOIS FED. AID PROJECT		

#60997

NOTES:

1. THE LOCATION OF THE LONGITUDINAL CONSTRUCTION JOINTS MAY VARY, DEPENDING ON THE STAGE CONSTRUCTION OF THE PAVEMENT.
2. SIDE STREET PAVEMENT JOINTS SHALL LINE UP WITH THE CONTRACTION AND CONSTRUCTION JOINTS ON THE MAINLINE PAVEMENT TO AVOID MID-PANEL CRACKING.
3. WHEN MORE THAN FIVE LANES OF PAVEMENT WILL BE CONSTRUCTED ADJACENT TO ONE ANOTHER AT INTERSECTIONS, NO. 20 SMOOTH DOWEL BARS SHALL BE SUBSTITUTED FOR NO. 20 DEFORMED EPOXY COATED BARS FOR LONGITUDINAL CONSTRUCTION JOINTS.
4. ALL ELEVATIONS NOTED ON THIS SHEET ARE 250 m + THE ELEVATION SHOWN ON THE DRAWING.

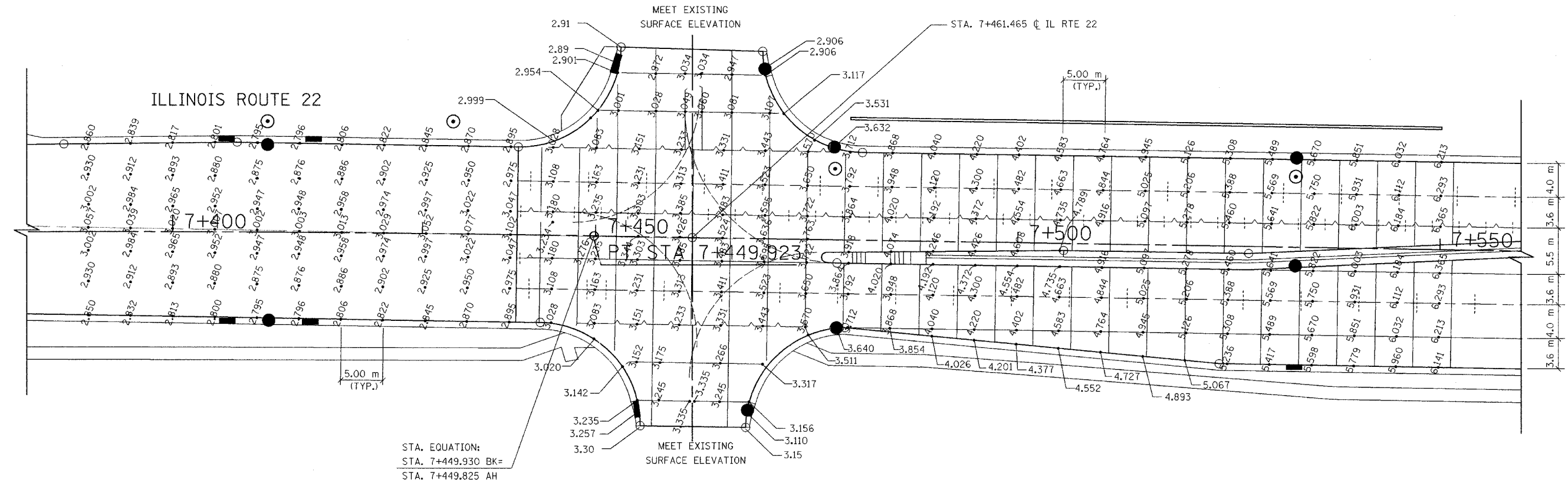
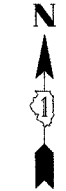

LEGEND

- LONGITUDINAL CONSTRUCTION JOINT WITH TIE BARS
- LONGITUDINAL CONSTRUCTION JOINT WITH DOWEL BARS
- SAWED LONGITUDINAL JOINT WITH TIE BARS
- PROP. ELEVATION @ 5 M INTERVALS
- PROP. INLET OR CATCH BASIN

REVISIONS	
NAME	DATE
REVISED GEOMETRY	11/24/04
FROM STA. 6+922.366 TO	
STA. 7+440.820	

ILLINOIS DEPARTMENT OF TRANSPORTATION
 ILLINOIS ROUTE 22
 FROM US RTE 12 TO BUESCHING RD
 INTERSECTION DETAILS
 IL RTE 22 & SHOPPING CENTER

SCALE : 1:250 DESIGNED BY VAP
 DATE : 07/21/04 CHECKED BY NAP