

F.A. RTE.	SECTION	COUNTY	TOTAL SHEETS	SHEET NO.
337	19R-1	LAKE	800	340
STA.		TO STA.		
FED. ROAD DIST. NO.		ILLINOIS FED. AID PROJECT		

#60997

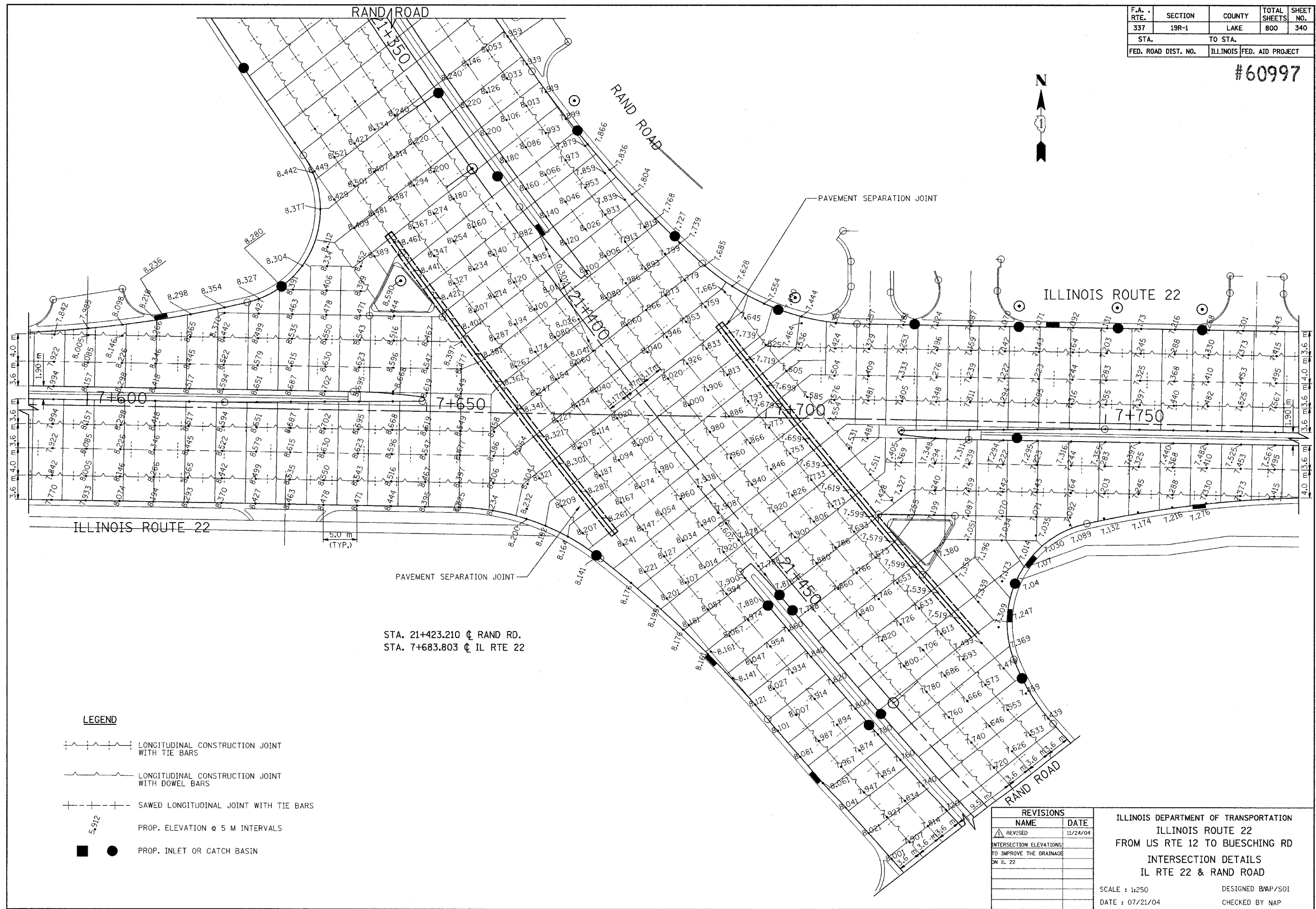

STA. 21+423.210  $\phi$  RAND RD.  
 STA. 7+683.803  $\phi$  IL RTE 22

**LEGEND**

- LONGITUDINAL CONSTRUCTION JOINT WITH TIE BARS
- LONGITUDINAL CONSTRUCTION JOINT WITH DOWEL BARS
- SAWED LONGITUDINAL JOINT WITH TIE BARS
- PROP. ELEVATION @ 5 M INTERVALS
- PROP. INLET OR CATCH BASIN

REVISIONS		
NO.	NAME	DATE
1	REVISED	11/24/04
INTERSECTION ELEVATIONS TO IMPROVE THE DRAINAGE ON IL 22		

ILLINOIS DEPARTMENT OF TRANSPORTATION  
 ILLINOIS ROUTE 22  
 FROM US RTE 12 TO BUESCHING RD  
 INTERSECTION DETAILS  
 IL RTE 22 & RAND ROAD

SCALE : 1:250  
 DATE : 07/21/04

DESIGNED BWP/SOI  
 CHECKED BY NAP