

F.A. RTE.	SECTION	COUNTY	TOTAL SHEETS	SHEET NO.
337	19R-1	LAKE	800	347
STA.		TO STA.		
FED. ROAD DIST. NO.		ILLINOIS FED. AID PROJECT		

60997

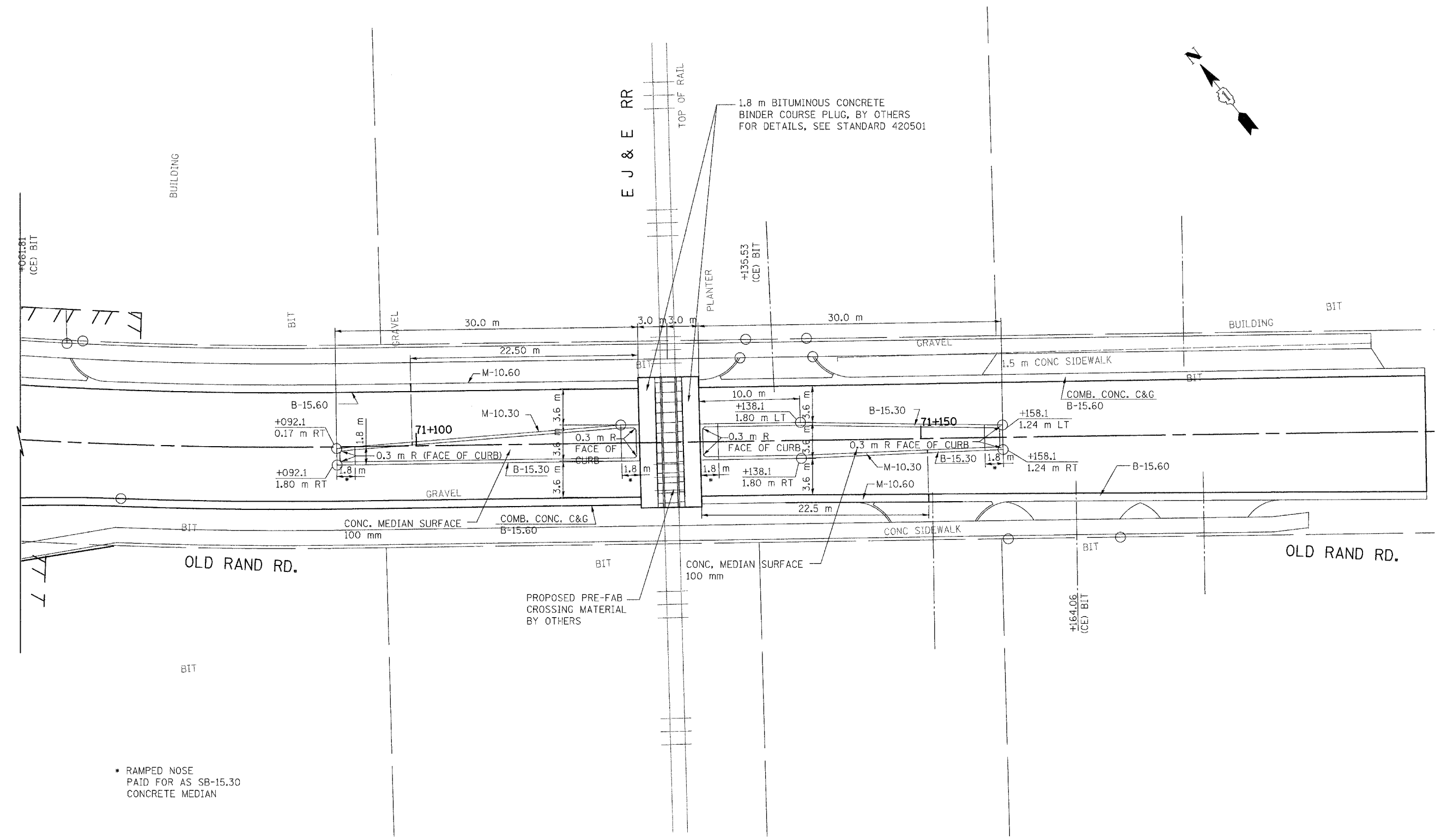

• RAMPED NOSE  
PAID FOR AS SB-15.30  
CONCRETE MEDIAN

OLD RAND ROAD

REVISIONS	
NAME	DATE

ILLINOIS DEPARTMENT OF TRANSPORTATION  
ILLINOIS ROUTE 22  
FROM US RTE 12 TO BUESCHING RD  
OLD RAND ROAD  
DETAIL PLAN AT INTERSECTION  
E J & E R.R. AND OLD RAND ROAD  
SCALE: 1:200  
DATE: 07/21/04  
DRAWN BY: SOI  
CHECKED BY: