

F.A. RTE.	SECTION	COUNTY	TOTAL SHEETS	SHEET NO.
337	19R-1	LAKE	800	382
STA. 9+500		TO STA. 9+800		
FED. ROAD DIST. NO.		ILLINOIS FED. AID PROJECT		

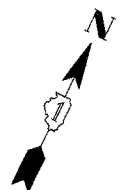

FINAL SURVEY NO.	DATE
SURVEYED	BY
PLOTTED	
TEMPLATE	
AREAS CHECKED	
NO.	

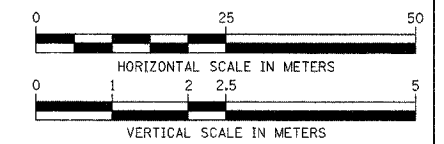
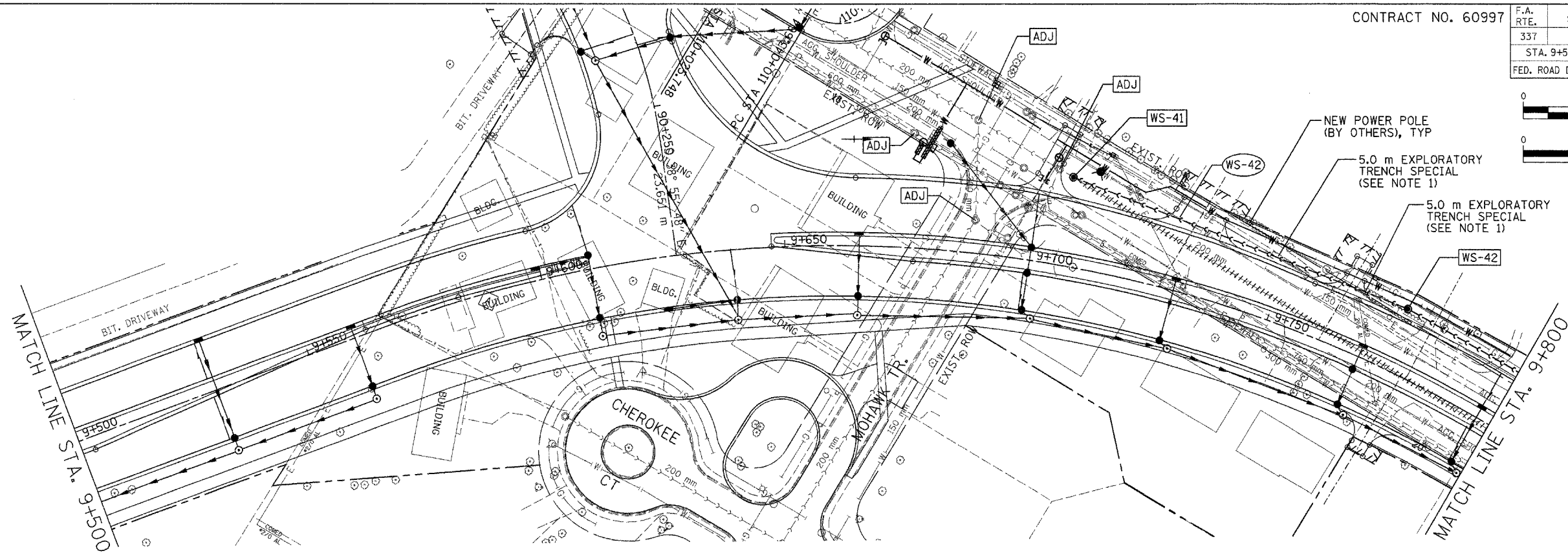

LEGEND

[ADJ]	STRUCTURE TO BE ADJUSTED
[F]	STRUCTURE TO BE FILLED
[R]	STRUCTURE TO BE REMOVED
[REC]	STRUCTURE TO BE RECONSTRUCTED
----	PIPE ABANDONMENT (OR REMOVAL WHERE REQ'D)

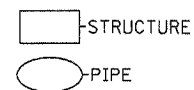

WS-41
 SAN. MH 1.2M DIA.
 W/ FR, LID & CHIMNEY SEAL
 STA. 9+705.9
 18.2 m LT
 RIM=270.63
 INV(E)=266.657 (PROP)
 INV(W)=266.657 (EX)
 PLUG AND ABANDON EX. SEWER TO EAST

WS-42
 SAN. MH 1.2M DIA.
 W/ FR, LID & CHIMNEY SEAL
 STA. 9+775.1
 13.0 m LT
 RIM=270.10
 INV(E,W)=266.855

NOTES:

- CONTRACTOR TO VERIFY EXISTING ELECTRIC AND TELEPHONE DUCT BANK LOCATIONS AND ELEVATIONS PRIOR TO CONSTRUCTING SEWER. THIS WORK SHALL BE PAID FOR AS EXPLORATION TRENCH, SPECIAL.
- EXISTING SANITARY SERVICES SHALL BE REPLACED FROM THE RELOCATED SEWER MAIN TO THE PROPERTY LINE. FOR BIDDING PURPOSES, IT HAS BEEN ASSUMED THAT THERE WILL BE A TOTAL OF 90 m OF 150 mm DUCTILE IRON SANITARY SEWER (AUGERED) FOR THE SERVICES SOUTH OF ROUTE 22 AND 20 m OF 150 mm PVC SANITARY SEWER FOR SERVICES TO THE NORTH OF ROUTE 22.

ORIGINAL SURVEY NO.	DATE
SURVEYED	BY
PLOTTED	
TEMPLATE	
AREAS CHECKED	
NO.	

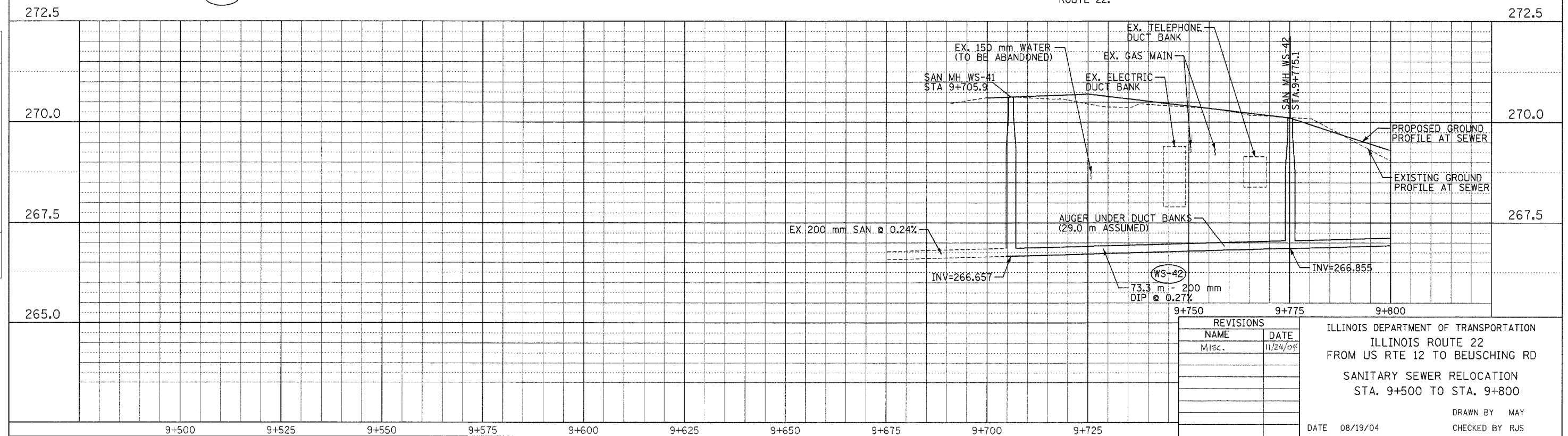

REVISIONS	
NAME	DATE
Misc.	11/24/04

ILLINOIS DEPARTMENT OF TRANSPORTATION
 ILLINOIS ROUTE 22
 FROM US RTE 12 TO BEUSCHING RD
 SANITARY SEWER RELOCATION
 STA. 9+500 TO STA. 9+800

DATE 08/19/04
 DRAWN BY MAY
 CHECKED BY RJS