

F.A. RTE.	SECTION	COUNTY	TOTAL SHEETS	SHEET NO.
337	19R-1	LAKE	800	471
STA. 21+490		TO STA. 22+000		
FED. ROAD DIST. NO.		ILLINOIS FED. AID PROJECT		

60997

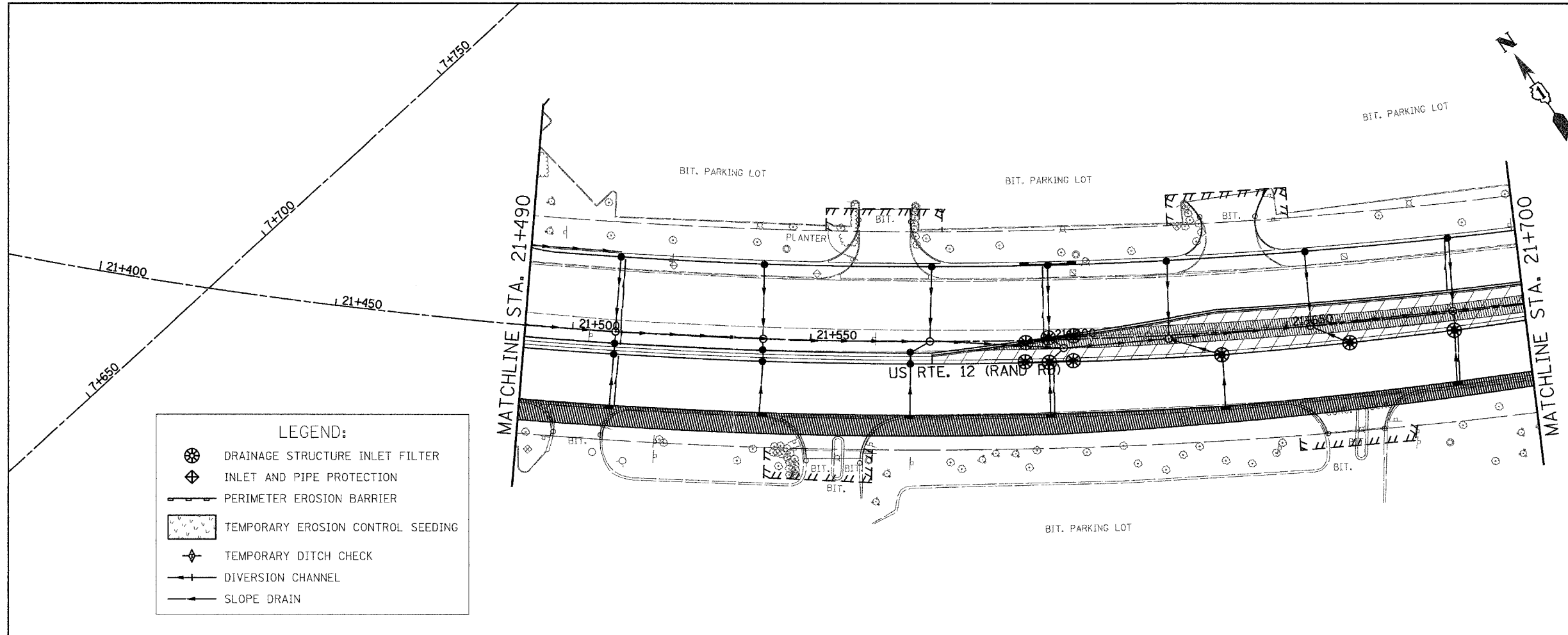

**LEGEND:**

- DRAINAGE STRUCTURE INLET FILTER
- INLET AND PIPE PROTECTION
- PERIMETER EROSION BARRIER
- TEMPORARY EROSION CONTROL SEEDING
- TEMPORARY DITCH CHECK
- DIVERSION CHANNEL
- SLOPE DRAIN

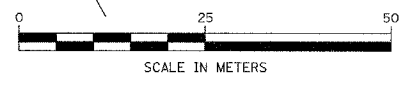
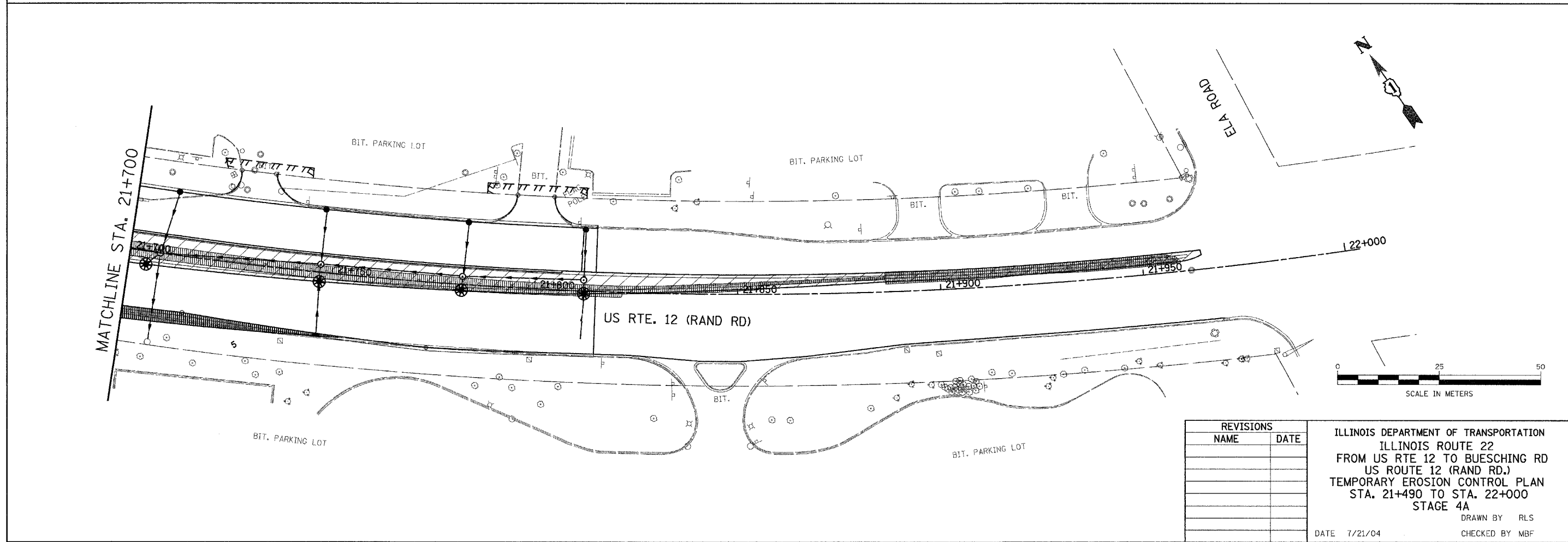

REVISIONS	
NAME	DATE

ILLINOIS DEPARTMENT OF TRANSPORTATION  
 ILLINOIS ROUTE 22  
 FROM US RTE 12 TO BUESCHING RD  
 US ROUTE 12 (RAND RD.)  
 TEMPORARY EROSION CONTROL PLAN  
 STA. 21+490 TO STA. 22+000  
 STAGE 4A  
 DRAWN BY RLS  
 CHECKED BY MBF  
 DATE 7/21/04