

F.A. RTE.	SECTION	COUNTY	TOTAL SHEETS	SHEET NO.
337	19R-1	LAKE	800	487
STA. 9+900		TO STA. 10+200		
FED. ROAD DIST. NO.	ILLINOIS	FED. AID PROJECT		

60997

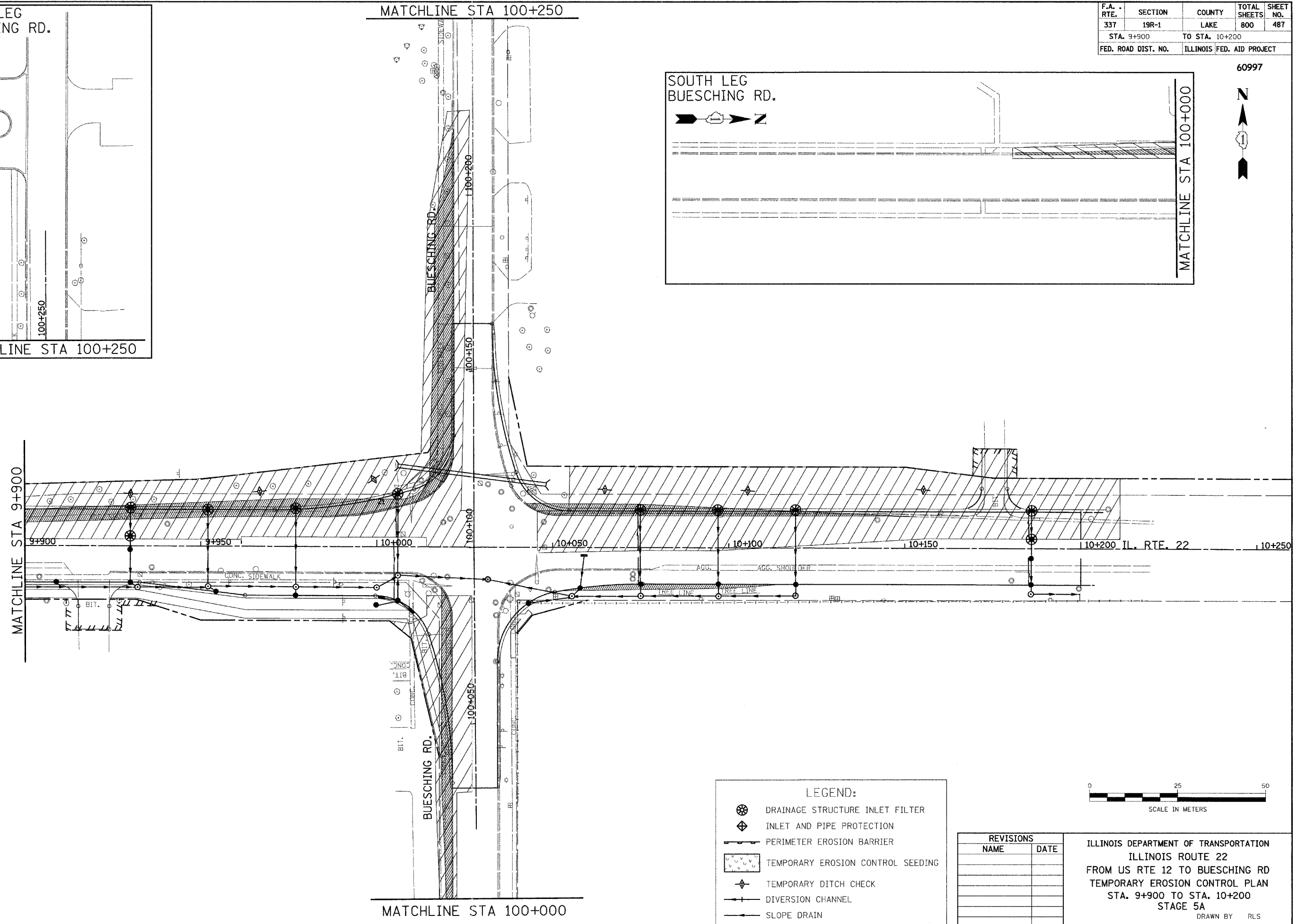
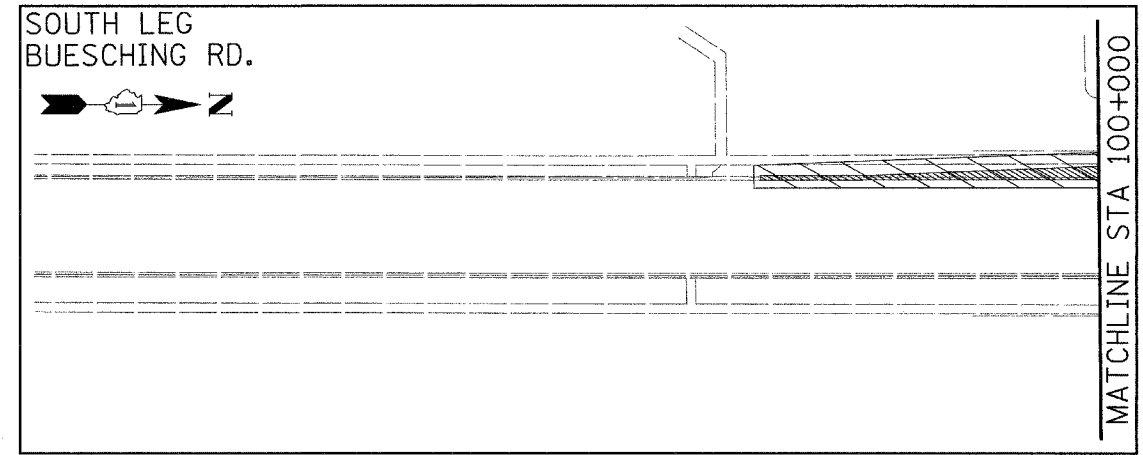
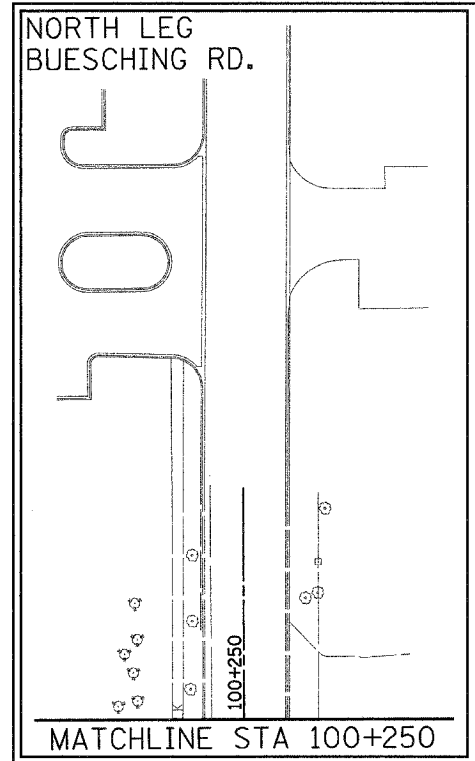
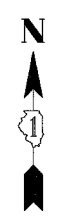

LEGEND:

- DRAINAGE STRUCTURE INLET FILTER
- INLET AND PIPE PROTECTION
- PERIMETER EROSION BARRIER
- TEMPORARY EROSION CONTROL SEEDING
- TEMPORARY DITCH CHECK
- DIVERSION CHANNEL
- SLOPE DRAIN

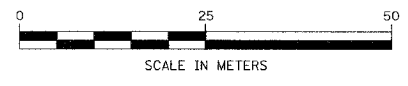

REVISIONS	
NAME	DATE

ILLINOIS DEPARTMENT OF TRANSPORTATION  
ILLINOIS ROUTE 22  
FROM US RTE 12 TO BUESCHING RD  
TEMPORARY EROSION CONTROL PLAN  
STA. 9+900 TO STA. 10+200  
STAGE 5A  
DRAWN BY RLS  
CHECKED BY MBF  
DATE 7/21/04