

F.A.I. RTE.	SECTION	COUNTY	TOTAL SHEETS	SHEET NO.
55	2002-022 K	WILL	172	29
STA. 10+00		TO STA. 22+96.05		
FED. ROAD DIST. NO.		ILLINOIS	FED. AID PROJECT	
CONTRACT NO. 62389				

END ILLINOIS ROUTE 53
IMPROVEMENT
STA 1466+96

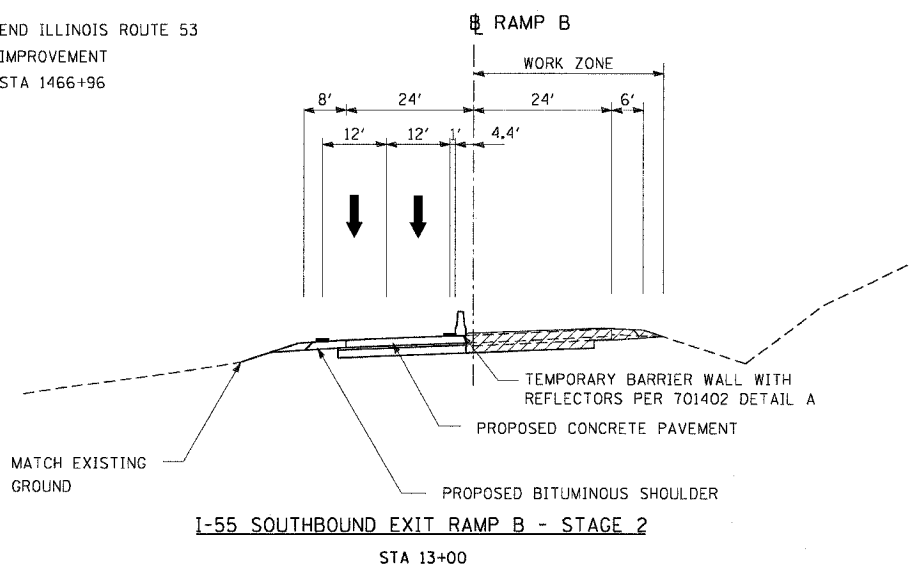

I-55 SOUTHBOUND EXIT RAMP B - STAGE 2
STA 13+00

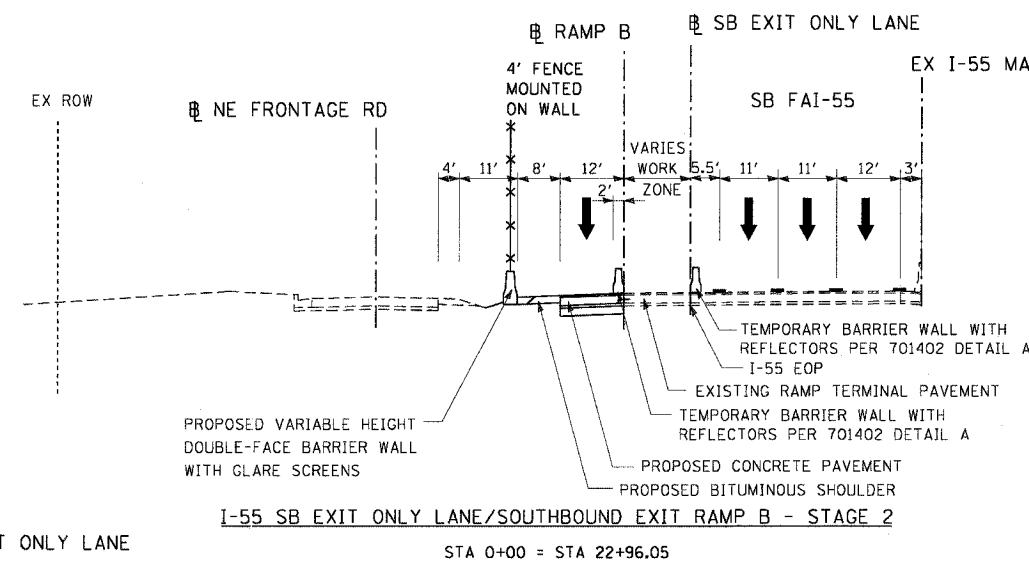

I-55 SB EXIT ONLY LANE/SOUTHBOUND EXIT RAMP B - STAGE 2
STA 0+00 = STA 22+96.05

SEQUENCE OF STAGING

- FOR DETAILS NOT SHOWN, SEE IDOT HIGHWAY STANDARDS IN THE PLANS.
- STAGE 2
STAGE 2A
PLACE TRAFFIC CONTROL AS SHOWN. MAINTAIN TRAFFIC CONTROL ON I-55, PLACING SB EXITING TRAFFIC ONTO AUXILIARY LANE. SHIFT TRAFFIC LANES ON NB AND SB IL-53 TO CONSTRUCT MEDIAN IMPROVEMENTS. CONSTRUCT SB EXIT RAMP B.
STAGE 2B
REMOVE TEMPORARY PAVEMENT AND PLACE REMAINING IL RTE 53 MEDIAN AND ISLAND IMPROVEMENTS. CONSTRUCT EXIT RAMP D NORTH WIDENING, ENTRANCE RAMP A NORTH WIDENING.
- STAGE 2C
UPON COMPLETION OF RAMP B AND AUXILIARY LANE PAVEMENT CONSTRUCTION REMOVE TRAFFIC CONTROL FROM OUTSIDE SHOULDERS. PERFORM IN-MEDIAN WORK FOR OVERHEAD SIGN STRUCTURES IN ACCORDANCE WITH TC-17 SHOULDERS CLOSURES FOR BOTH DIRECTIONS OF I-55

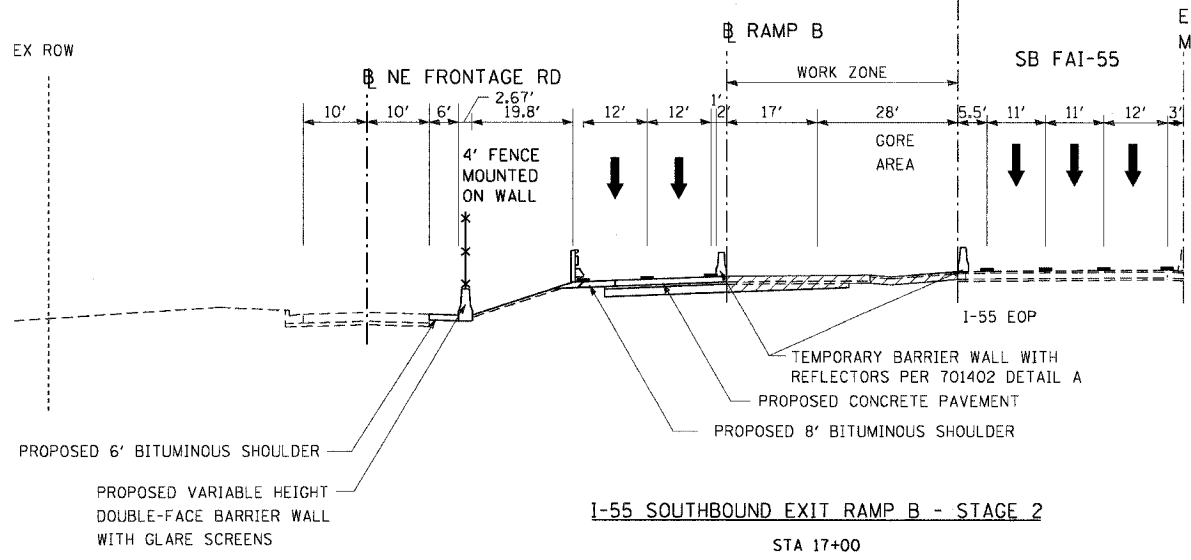

I-55 SOUTHBOUND EXIT RAMP B - STAGE 2
STA 17+00

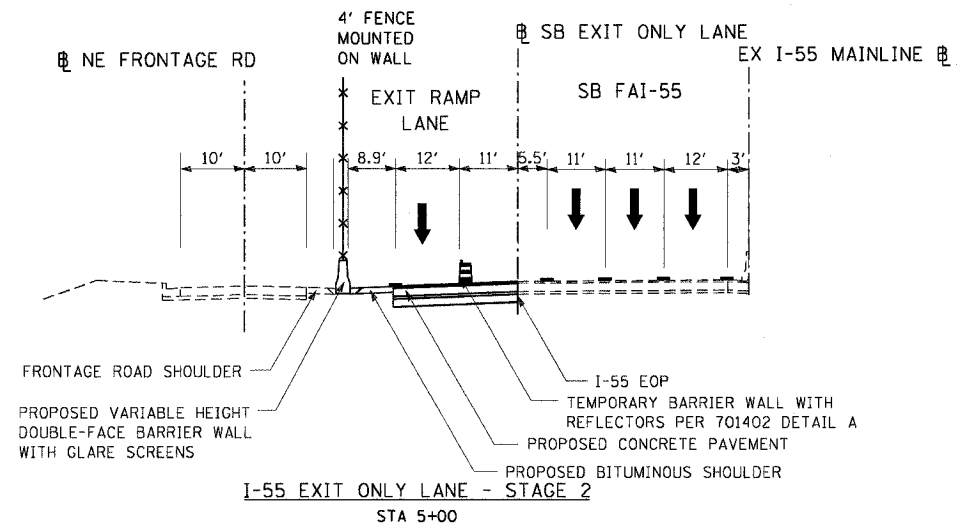

I-55 EXIT ONLY LANE - STAGE 2
STA 5+00

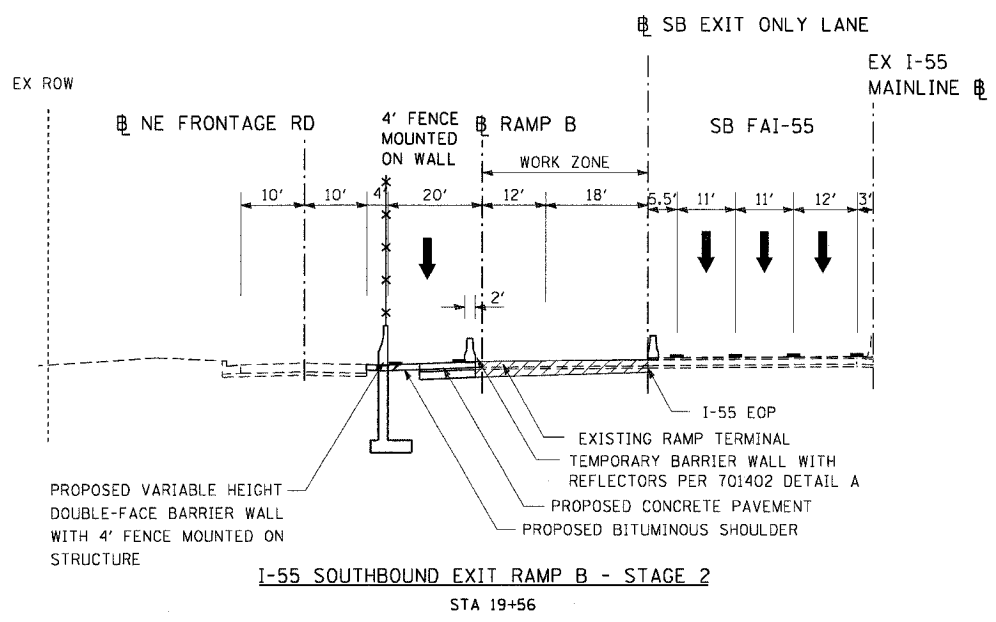

I-55 SOUTHBOUND EXIT RAMP B - STAGE 2
STA 19+56

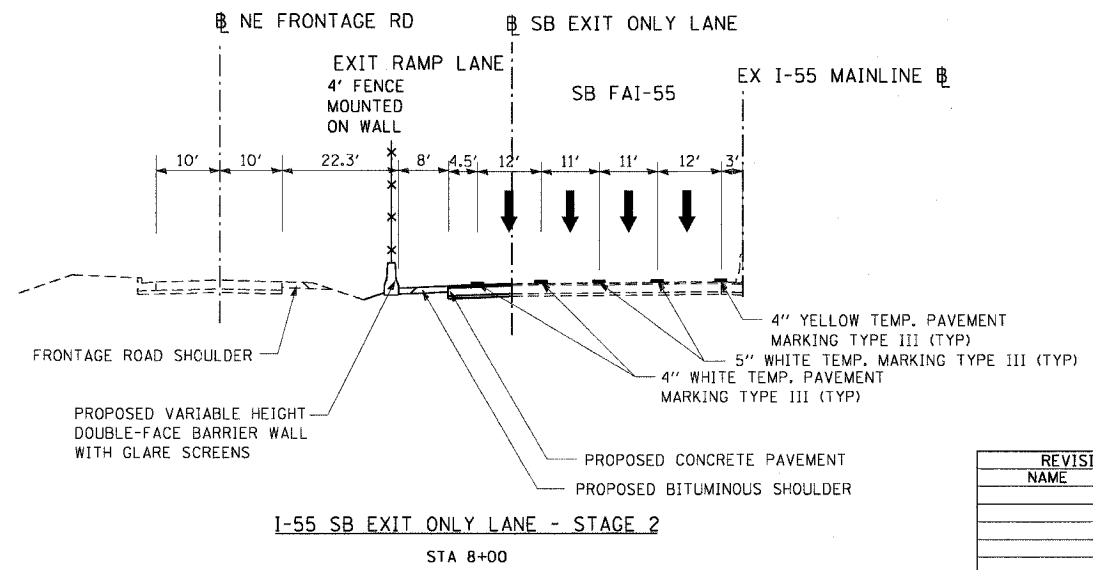

I-55 SB EXIT ONLY LANE - STAGE 2
STA 8+00

DATE	BY
DATE	BY
DATE	BY

DATE	BY
DATE	BY
DATE	BY

REVISIONS	
NAME	DATE

ILLINOIS DEPARTMENT OF TRANSPORTATION
SUGGESTED CONSTRUCTION STAGING
TYPICAL CROSS SECTIONS
RAMP B AND I-55 SB EXIT ONLY LANE
STAGE 2
SCALE: N.T.S.
DATE: 11/8/2004
DRAWN BY: CC
CHECKED BY: RI

DMJM HARRIS
303 East Wacker Drive, Suite 600
Chicago, Illinois, 60601 Phone: 312.321.6101 Fax: 312.396.2392