

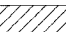





F.A.I. RTE.	SECTION	COUNTY	TOTAL SHEETS	SHEET NO.
55	2002-022 K	WILL	172	33
STA. 10+00		TO STA. 22+96.05		
FED. ROAD DIST. NO.		ILLINOIS	FED. AID PROJECT	
CONTRACT NO. 62389				

LEGEND:

-  ARROWBOARD
-  WORK AREA
-  TEMPORARY PAVEMENT
-  SIGN ON PORTABLE OR PERMANENT SUPPORT
-  FLAGGER WITH CONTROL SIGN
-  DRUM WITH MONO DIRECTIONAL STEADY BURNING LIGHT
-  CONES 700 (28") IN HEIGHT
-  DIRECTION OF TRAFFIC

PLAN	DATE
NO.	
BY	
REVISIONS	
NO.	
DATE	
BY	
REVISIONS	
NO.	
DATE	
BY	

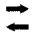
PROFILE	DATE
NO.	
BY	
REVISIONS	
NO.	
DATE	
BY	
REVISIONS	
NO.	
DATE	
BY	

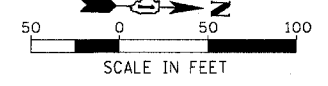
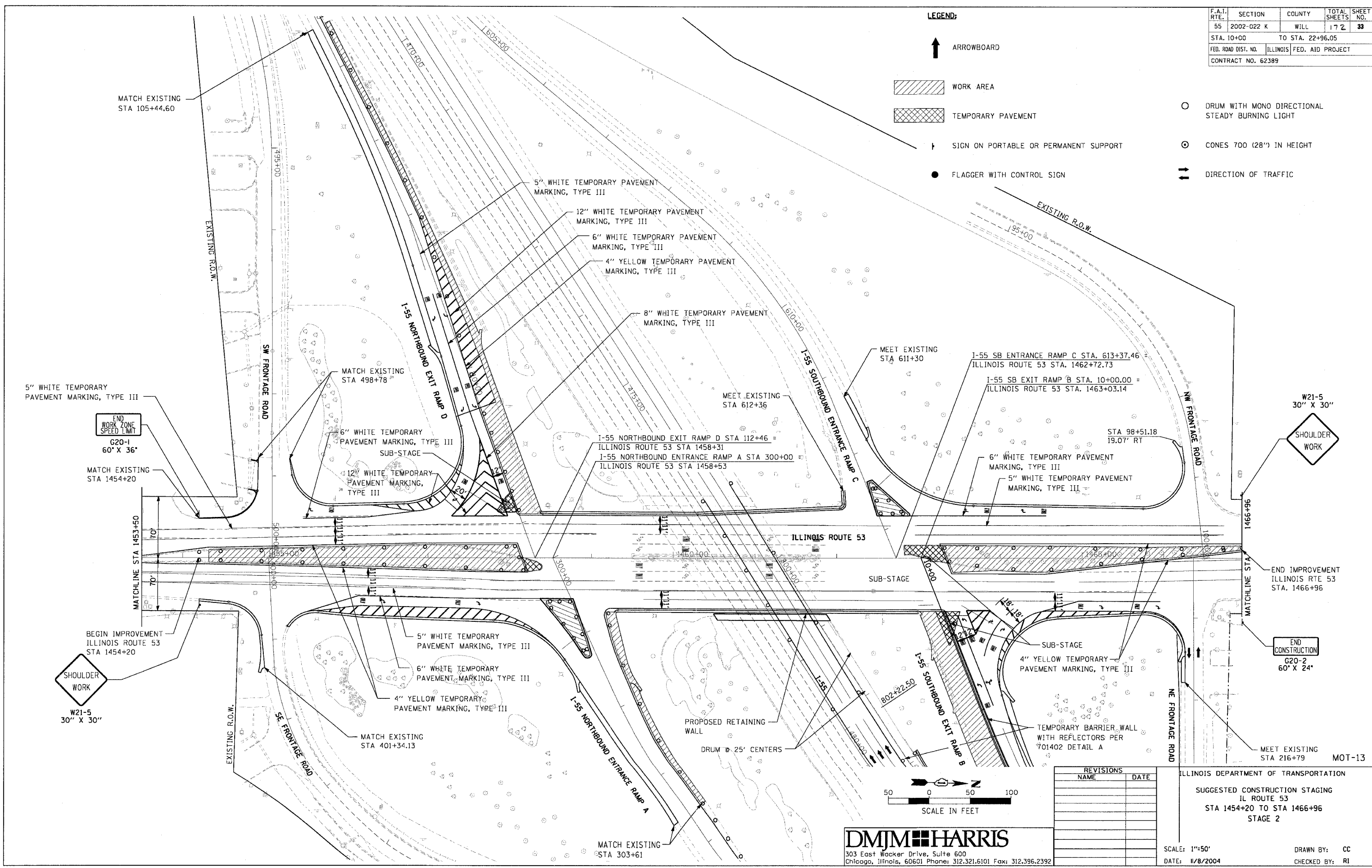

REVISIONS	
NAME	DATE

ILLINOIS DEPARTMENT OF TRANSPORTATION
 SUGGESTED CONSTRUCTION STAGING
 IL ROUTE 53
 STA 1454+20 TO STA 1466+96
 STAGE 2

DMJM HARRIS
 303 East Wacker Drive, Suite 600
 Chicago, Illinois, 60601 Phone: 312.321.6101 Fax: 312.396.2392

SCALE: 1"=50'
 DATE: 11/8/2004
 DRAWN BY: CC
 CHECKED BY: RI