

F.A.I. RTE.	SECTION	COUNTY	TOTAL SHEETS	SHEET NO.
55	2002-022 K	WILL	172	37
STA. 10+00		TO STA. 22+96.05		
FED. ROAD DIST. NO.		ILLINOIS FED. AID PROJECT		
CONTRACT NO. 62389				

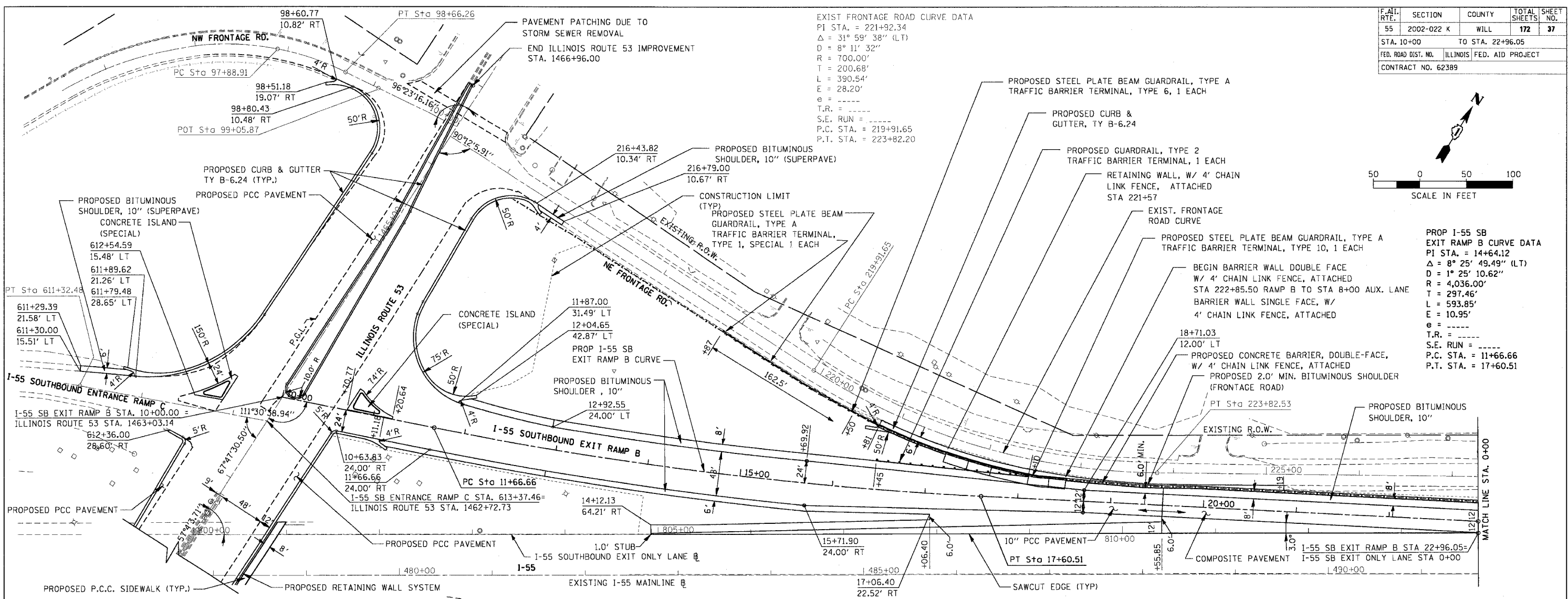
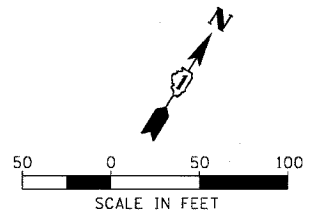

EXIST FRONTAGE ROAD CURVE DATA
 PI STA. = 221+92.34
 $\Delta = 31^\circ 59' 38''$ (L.T)
 $D = 8^\circ 11' 32''$
 $R = 700.00'$
 $L = 200.68'$
 $T = 390.54'$
 $E = 28.20'$
 $e =$
 $T.R. =$
 $S.E. RUN =$
 $P.C. STA. = 219+91.65$
 $P.T. STA. = 223+82.20$

PROP I-55 SB
 EXIT RAMP B CURVE DATA
 PI STA. = 14+64.12
 $\Delta = 8^\circ 25' 49.49''$ (L.T)
 $D = 1^\circ 25' 10.62''$
 $R = 4,036.00'$
 $T = 297.46'$
 $L = 593.85'$
 $E = 10.95'$
 $e =$
 $T.R. =$
 $S.E. RUN =$
 $P.C. STA. = 11+66.66$
 $P.T. STA. = 17+60.51$

DATE	BY	REVISION

DATE	BY	REVISION

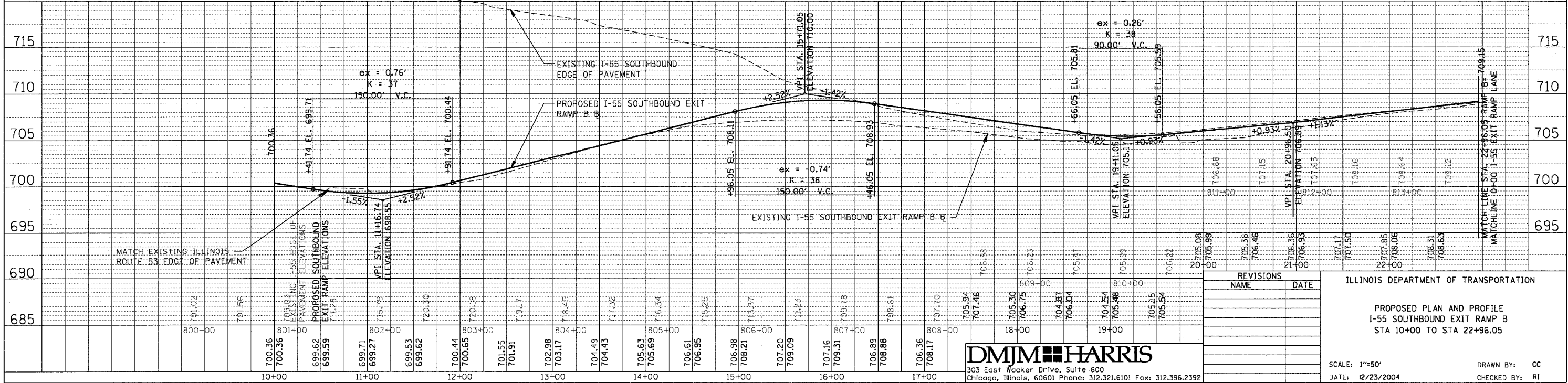

REVISIONS	NAME	DATE

ILLINOIS DEPARTMENT OF TRANSPORTATION
 PROPOSED PLAN AND PROFILE
 I-55 SOUTHBOUND EXIT RAMP B
 STA 10+00 TO STA 22+96.05
 SCALE: 1"=50'
 DATE: 12/23/2004
 DRAWN BY: CC
 CHECKED BY: RI

DMJM HARRIS
 303 East Wacker Drive, Suite 600
 Chicago, Illinois, 60601 Phone: 312.321.6101 Fax: 312.396.2392