

F.A.I. RTE.	SECTION	COUNTY	TOTAL SHEETS	SHEET NO.
55	27 BR	WILL	30	1

CONTRACT NO. 62424

STATE OF ILLINOIS  
DEPARTMENT OF TRANSPORTATION  
DIVISION OF HIGHWAYS

**PROPOSED  
HIGHWAY PLANS**

**FAI 55 / I-55 (EAST FRONTAGE ROAD)  
OVER SUNNYLAND DRAIN  
STRUCTURE NO.: 099-0032  
SECTION: 27BR  
PROJECT: BHI-055-6(213)256  
BRIDGE REHABILITATION  
WILL COUNTY  
C-91-138-02**

FOR INDEX OF SHEETS, SEE SHEET NO. 2

PROJECT LOCATED IN  
UNINCORPORATED PLAINFIELD  
TOWNSHIP

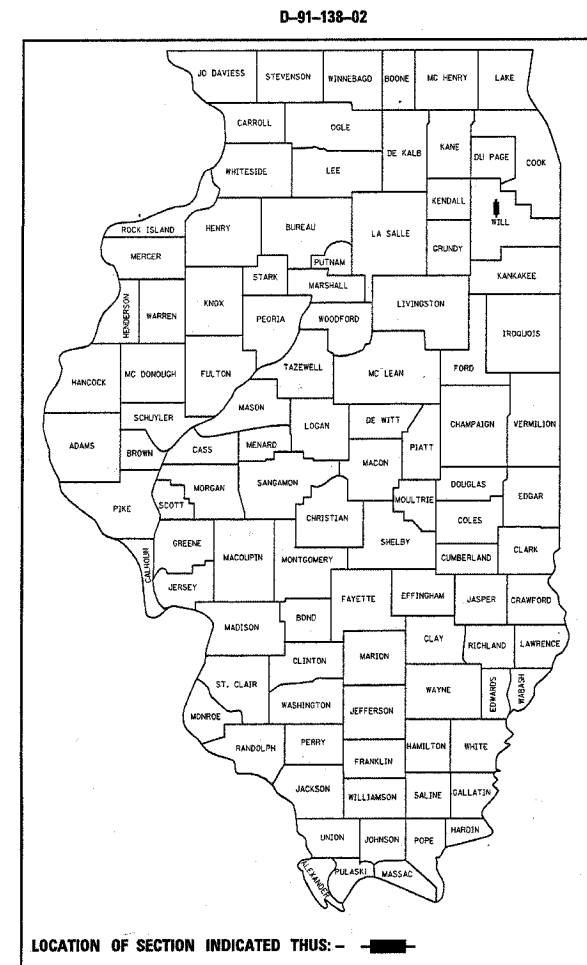

LOCATION OF SECTION INDICATED THUS: —■—

DIST. 1 DESIGN - PLAN PREPARATION ENGINEER: KEN ENG/J.P. CHANG (847) 705-4432

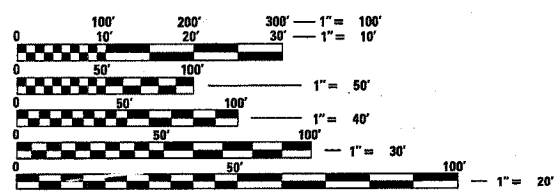

FULL SIZE PLANS HAVE BEEN PREPARED USING STANDARD ENGINEERING SCALES. REDUCED SIZED PLANS WILL NOT CONFORM TO STANDARD SCALES. IN MAKING MEASUREMENTS ON REDUCED PLANS, THE ABOVE SCALES MAY BE USED.

J.U.L.I.E.  
JOINT UTILITY LOCATION INFORMATION FOR EXCAVATION  
1-800-892-0123

CONTRACT NO. 62424

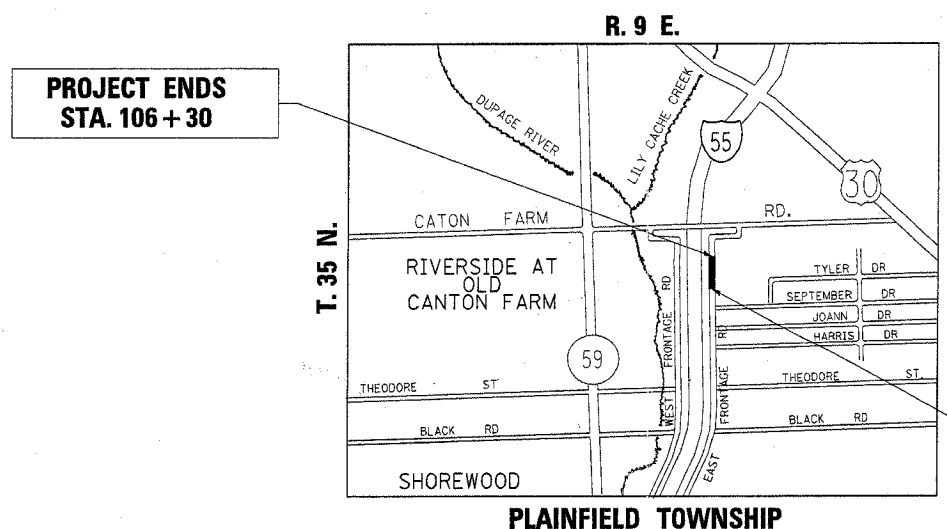

PROJECT ENDS  
STA. 106 + 30

PROJECT BEGINS  
STA. 104 + 00

TRAFFIC DATA:  
1997 ADT - 10,000  
2016 ADT(PROJECTED) - 10,000  
POSTED SPEED LIMIT - 35 MPH

GROSS AND NET LENGTH OF PROJECT - 230 FEET - 0.044 MILE

STATE OF ILLINOIS  
DEPARTMENT OF TRANSPORTATION  
DIVISION OF HIGHWAYS

SUBMITTED *December 29, 20 04*

*Dina O'Keefe*  
DEPUTY DIRECTOR OF HIGHWAYS, REGION ENGINEER

*February 4, 20 05*  
*Mike Hine*  
ENGINEER OF DESIGN AND ENVIRONMENT

*February 4, 20 05*  
*Victor Mader*  
DIRECTOR OF HIGHWAYS, CHIEF ENGINEER

PRINTED BY THE AUTHORITY  
OF THE STATE OF ILLINOIS