

F.A.I. RTE.	SECTION	COUNTY	TOTAL SHEETS	SHEET NO.
90/94	2003-0311	COOK	976	89
STA. 1295+00		TO STA. 1308+00		
FED. ROAD DIST. NO.		ILLINOIS FED. AID PROJECT		

62583

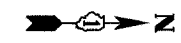

**NOTES:**

- SEE DRAWINGS ME-01 AND ME-02 FOR ELECTRICAL SYMBOLS AND ABBREVIATIONS.
- UNLESS NOTED OTHERWISE, ALL ITEMS AND WORK SHOWN IN HEAVY LINE WEIGHT ON THIS DRAWING ARE PROPOSED NEW ITEMS OF WORK.
- THE EXISTING ROADWAY LIGHTING SYSTEM SHALL REMAIN IN OPERATION UNTIL THE PROPOSED ROADWAY LIGHTING SYSTEM HAS BEEN INSTALLED, ENERGIZED, TESTED, AND ACCEPTED BY THE ENGINEER, UNLESS OTHERWISE DIRECTED BY THE ENGINEER.

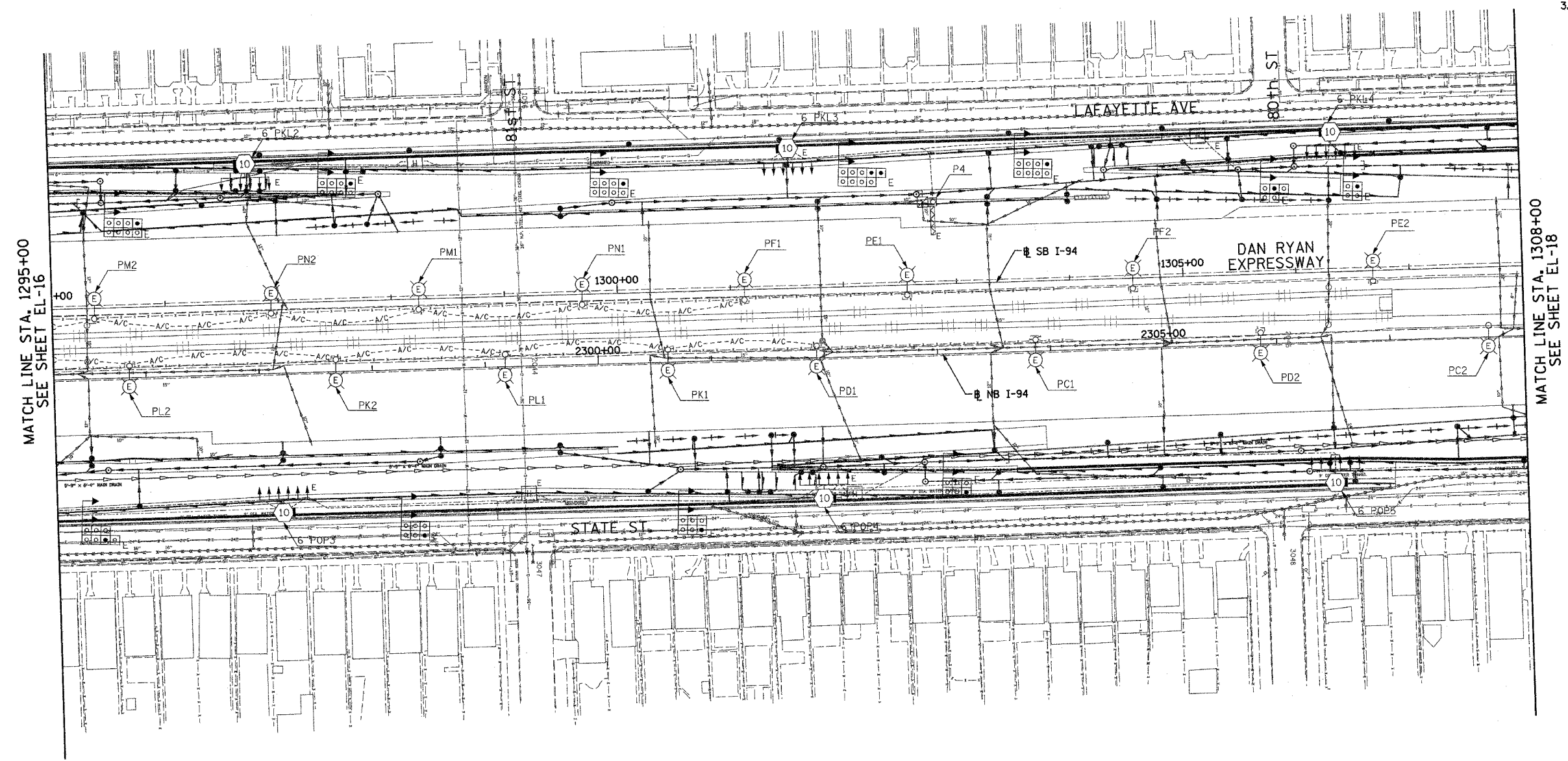

MATCH LINE STA. 1295+00  
SEE SHEET EL-16

MATCH LINE STA. 1308+00  
SEE SHEET EL-18

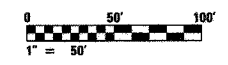

EL-17

NO ELECTRICAL WORK THIS SHEET  
FOR REFERENCE ONLY

**SINGH** 300 W. ADAMS ST.  
CHICAGO, IL 60606  
SINGH & ASSOCIATES, INC. TEL: (312) 629-0240  
CONSULTING ENGINEERS FAX: (312) 629-9449

REVISIONS	
NAME	DATE

ILLINOIS DEPARTMENT OF TRANSPORTATION  
F.A.I. 90/94 (DAN RYAN EXPRESSWAY)  
31st STREET TO I-57

ROADWAY LIGHTING PLANS EXISTING  
CONDITIONS, TEMPORARY AND REMOVAL

SCALE: 1"=50'  
DATE: OCTOBER 29, 2004

DRAWN BY: SP  
CHECKED BY: TM

10/20/2004 6:23 PM