

F.A.I. RTE.	SECTION	COUNTY	TOTAL SHEETS	SHEET NO.
90/94	2003-0311	COOK	976	295
STA. 1426+00.00		TO STA. 1436+00.00		
FED. ROAD DIST. NO. 1		ILLINOIS FED. AID PROJECT		

62583

**NOTES:**

- SEE DRAWINGS ME-01 AND ME-02 FOR ELECTRICAL SYMBOLS AND ABBREVIATIONS.
- SEE DRAWINGS ES-04 & ES-05 FOR HIGH MAST LIGHT TOWER SCHEDULE.
- SEE DRAWING UL-26 FOR THE P. FT. W. & C. RAILROAD UNDERPASS LIGHTING PLANS.

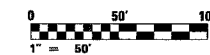
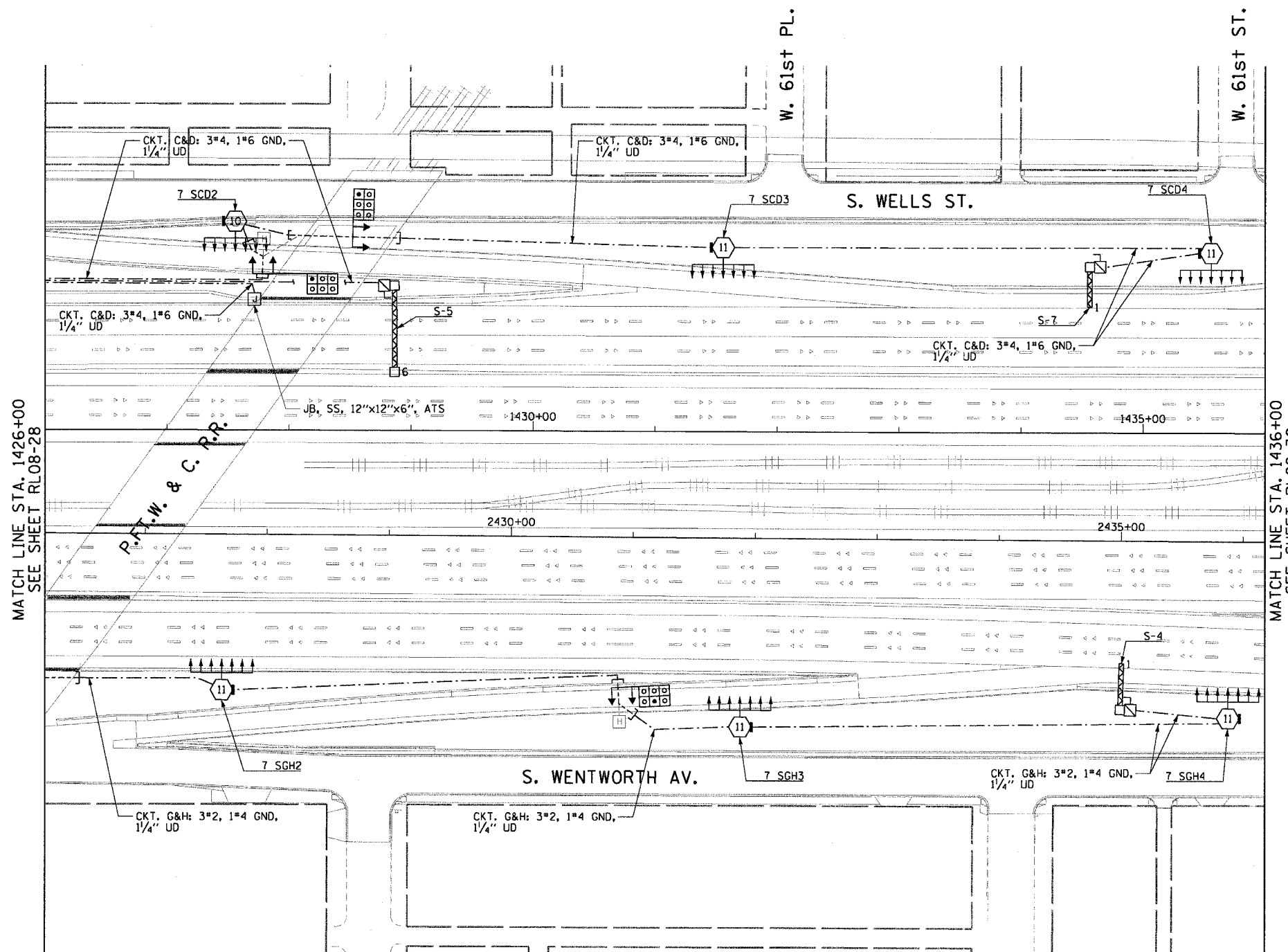

RL08-29

REVISIONS	
NAME	DATE

ILLINOIS DEPARTMENT OF TRANSPORTATION  
 F.A.I. 90/94 (DAN RYAN EXPRESSWAY)  
 31st STREET TO I-57  
**ROADWAY LIGHTING PLANS**  
**FINAL CONDITIONS**

SCALE: 1"=50'      DRAWN BY: CJM  
 DATE: October 29, 2004      CHECKED BY: WDS

**CTE ENGINEERS**  
 CONSOER TOWNSEND ENVIRONMENTAL ENGINEERS, INC.  
 303 EAST WACKER DRIVE, SUITE 600  
 CHICAGO ILLINOIS 60601-5202, PHONE: (312) 938-0300

m:\p40465\elect\16\cont\2b\slr\contract\2\2008-Final\10202922\_08.dwg 11/19/2004 01:05:00 PM