

F.A.I. RTE.	SECTION	COUNTY	TOTAL SHEETS	SHEET NO.
90/94	2003-0311	COOK	976	242
STA. 1506+50.00		TO STA. 1518+00.00		
FED. ROAD DIST. NO. 1		ILLINOIS FED. AID PROJECT		

62583

**NOTES:**

- SEE DRAWINGS ME-01 AND ME-02 FOR ELECTRICAL SYMBOLS AND ABBREVIATIONS.
- SEE DRAWINGS ES-05 AND ES-06 FOR HIGH MAST LIGHT TOWER SCHEDULE.

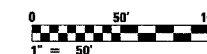
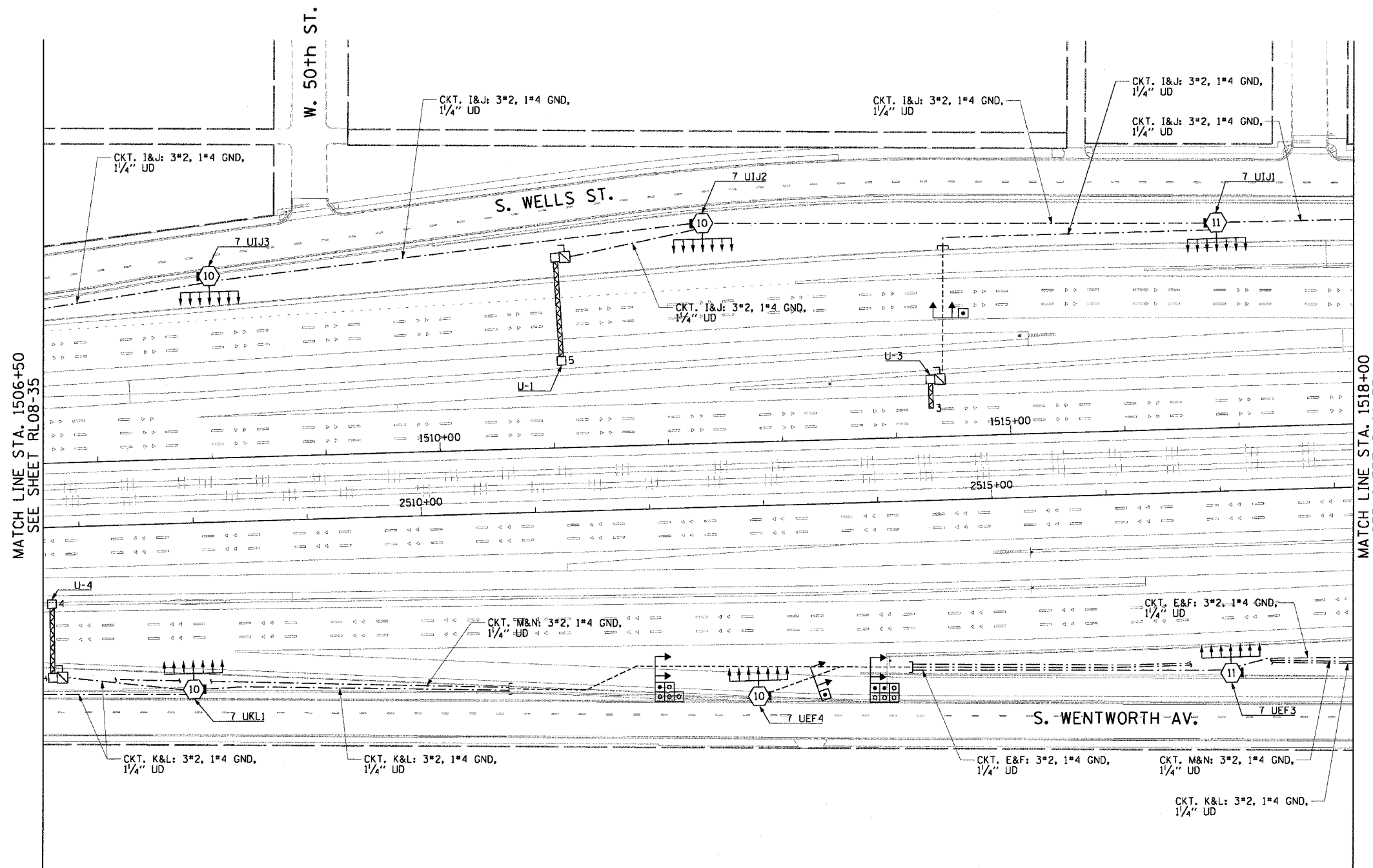

RLO8-36

REVISIONS	
NAME	DATE

ILLINOIS DEPARTMENT OF TRANSPORTATION  
 F.A.I. 90/94 (DAN RYAN EXPRESSWAY)  
 31st STREET TO I-57  
**ROADWAY LIGHTING PLANS  
 FINAL CONDITIONS**  
 SCALE: 1"=50'  
 DATE: October 29, 2004  
 DRAWN BY: CJM  
 CHECKED BY: WDS

**CTE ENGINEERS**  
 CONSOER TOWNSEND ENVIRONMENTAL ENGINEERS, INC.  
 303 EAST WACKER DRIVE, SUITE 600  
 CHICAGO, ILLINOIS 60601-5212, PHONE: (312) 938-0300

11/19/2004 09:05:23 PM