

REVIEWED
 GRADES CHECKED
 ELEM. NOTED
 STRUCTURE NOTATIONS DWG/D
 NO. _____

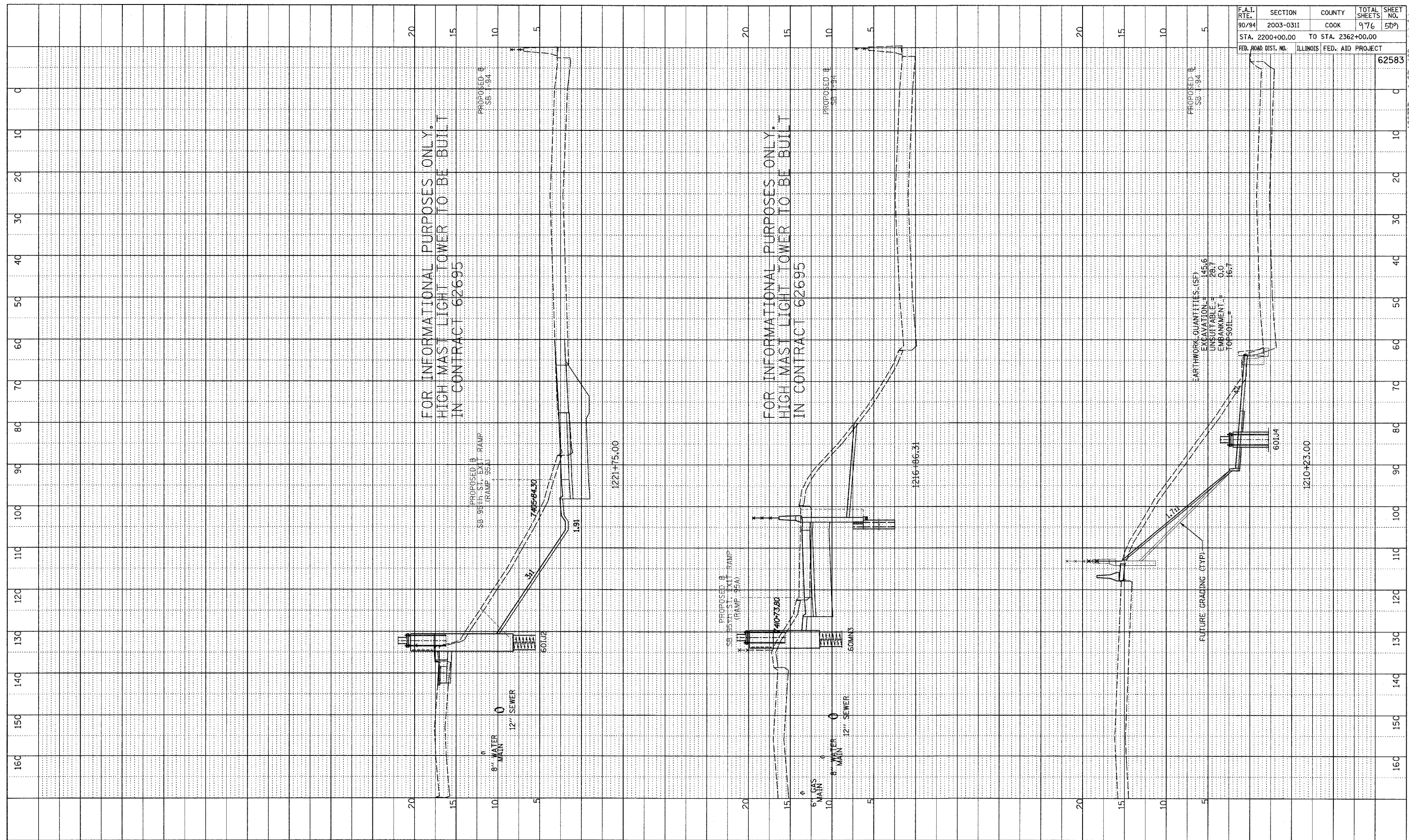

F.A.I. RTE.	SECTION	COUNTY	TOTAL SHEETS	SHEET NO.
90/94	2003-0311	COOK	976	509
STA. 2200+00.00		TO STA. 2362+00.00		
FED. ROAD DIST. NO.	ILLINOIS	FED. AID PROJECT	62583	

TYLIN INTERNATIONAL

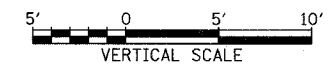
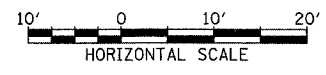

SB I-94 (DAN RYAN EXPRESSWAY)
STA. 1210+23 TO STA. 1221+75

PA02313yroad\02\gpk02\ssrsrb_f.dgn