

PLOTTED
 GRADES CHECKED
 STRUCTURE NOTATIONS OK'D
 NO.

F.A.I. RTE.	SECTION	COUNTY	TOTAL SHEETS	SHEET NO.
90/94	2003-0311	COOK	976	511
STA. 2200+00.00		TO STA. 2362+00.00		
FED. ROAD DIST. NO.	ILLINOIS	FED. AID PROJECT		62583

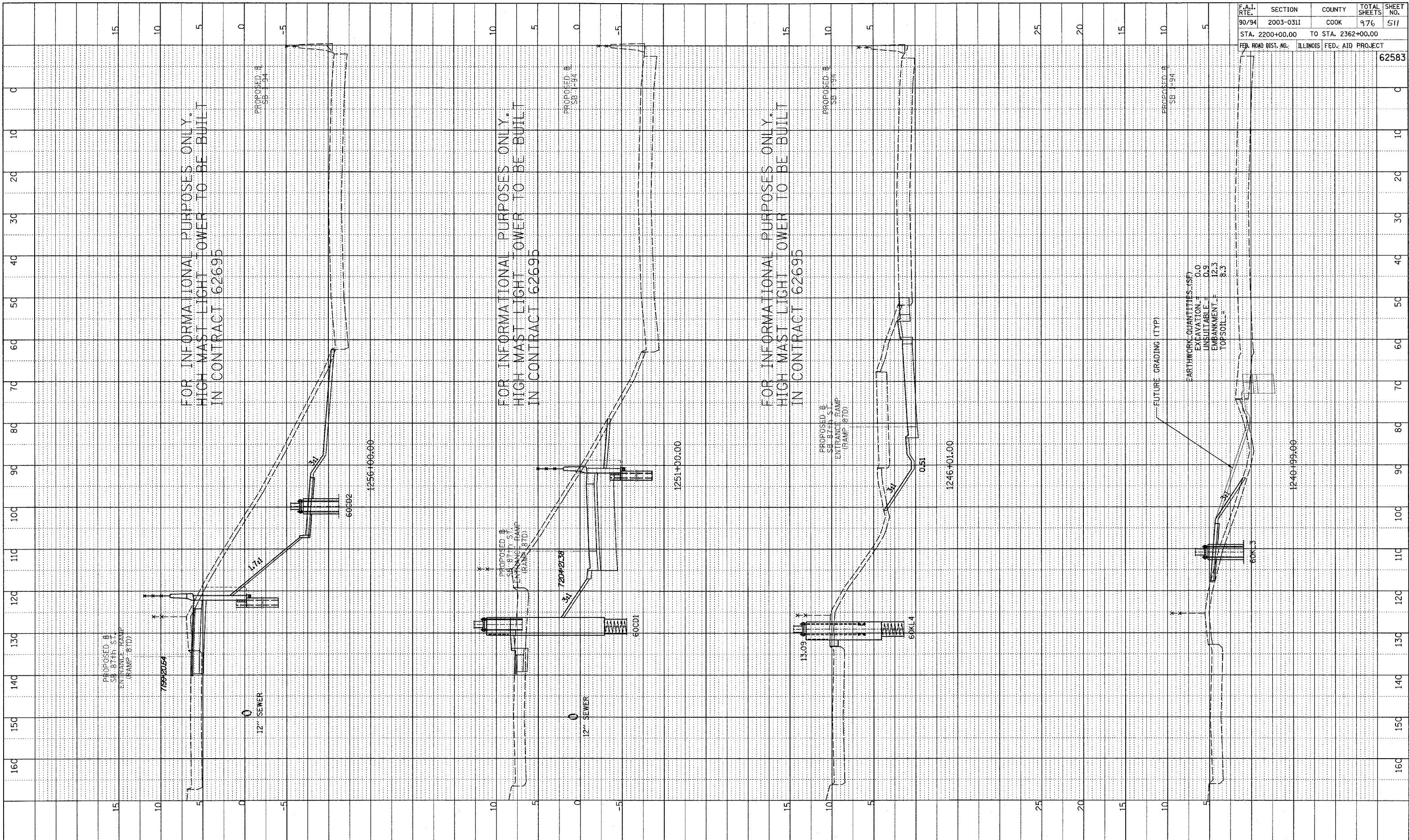

TYLIN INTERNATIONAL

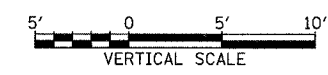
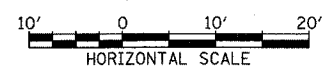

SB I-94 (DAN RYAN EXPRESSWAY)
 STA. 1240+99 TO STA. 1256+00

PA:02373\road\02\gpk02\ssshel_1.dgn