

PLOTTED:
 GRADES CHECKED
 STRUCTURE NOTATIONS OK'D
 NO. _____

F.A.I. RTE.	SECTION	COUNTY	TOTAL SHEETS	SHEET NO.
90/94	2003-0311	COOK	976	516
STA. 2200+00.00 TO STA. 2362+00.00				
FED. ROAD DIST. NO.		ILLINOIS FED. AID PROJECT		62583

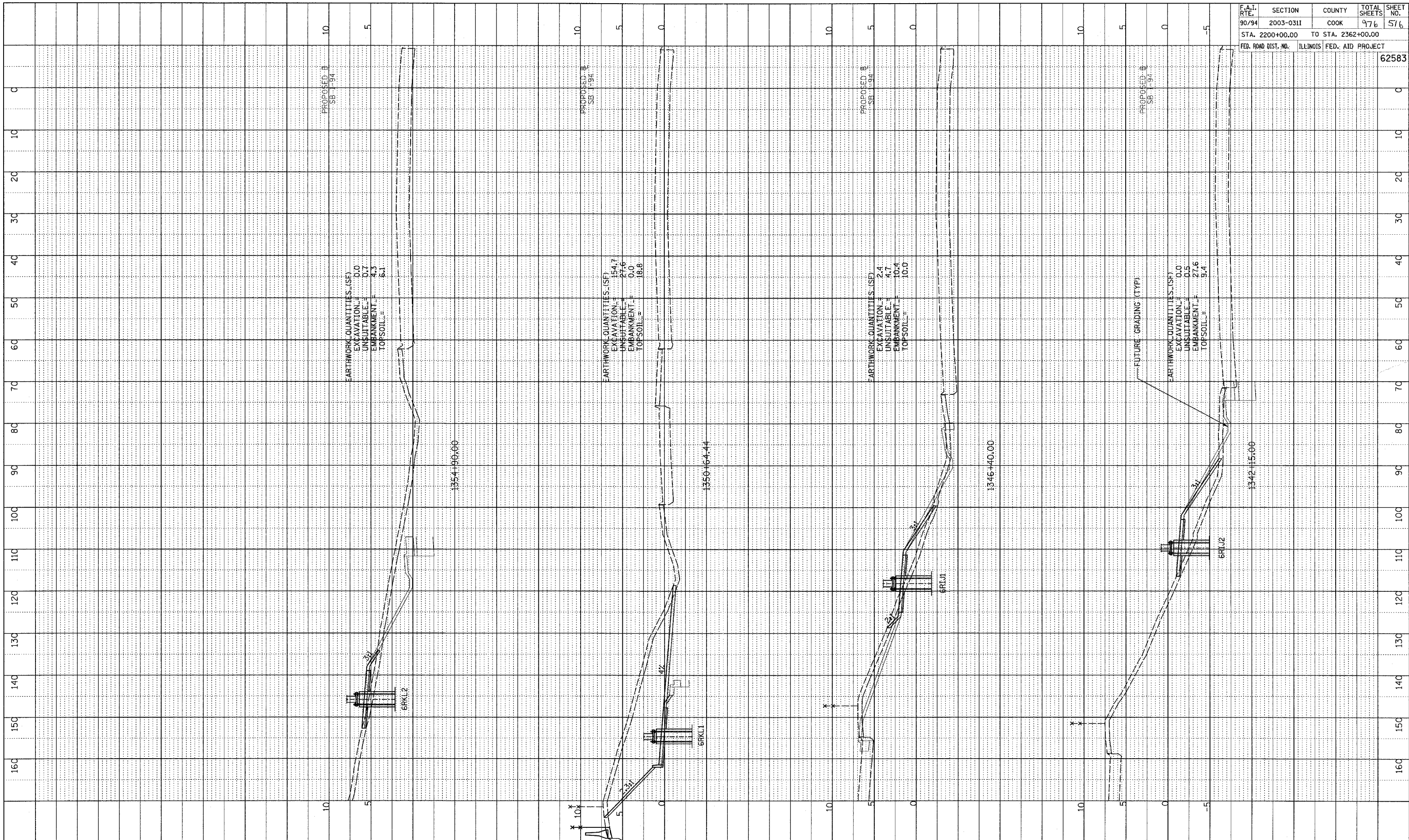

TYLIN INTERNATIONAL

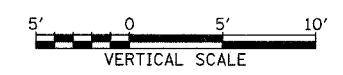
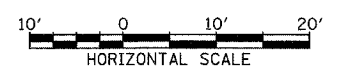

SB I-94 (DAN RYAN EXPRESSWAY)
STA. 1342+15 TO STA. 1354+90