

SECTION	COUNTY	TOTAL SHEETS	SHEET NO.
2003-0311	COOK	976	737
STA. 1376+00	TO STA. 1388+00		
FED. ROAD DIST. NO.	ILLINOIS	FED. AID PROJECT	
62583			

ELECTRIC UTILITY SERVICE CONNECTION, BY OTHERS  
ELECTRIC SERVICE INSTALLATION, 30A, 120V, BY OTHERS  
APPROXIMATELY 210' WEST OF LAFAYETTE AVE.

MODIFY EXISTING SURVEILLANCE CABINET  
CONCRETE FOUNDATION, TYPE 1, BY OTHERS  
PROPOSED SURVEILLANCE CABINET 49, BY OTHERS  
STA. 7102+36, 16RT

CABINET, MODEL 334 EQUIPMENT,  
SYSTEM DETECTOR  
CONCRETE FOUNDATION, TYPE 1  
PROPOSED SURVEILLANCE CABINET 51  
STA. 7112+50, 26RT

(5) 4/C #18  
3" GSC IN TRENCH (SPARE)

HH 2409, TYPE C1  
STA 7112+48  
(5) 4/C #18  
2" GSC IN TRENCH

2/C #2, 1/C #6 GND  
2" GSC IN TRENCH  
2" GSC IN TRENCH (SPARE)

2" GSC IN TRENCH (SPARE)

2" GSC IN TRENCH, BY OTHERS (SPARE)  
2/C #2, 1/C #6 GND  
2" GSC IN TRENCH, BY OTHERS  
2" GSC IN TRENCH, BY OTHERS (SPARE)  
HH 2410, TYPE S1  
STA 7107+95, BY OTHERS

(6) 4/C #18  
2" GSC IN TRENCH  
2" GSC IN TRENCH (SPARE)

HH 2401, TYPE C1  
STA 7104+80, BY OTHERS  
(6) 4/C #18  
4/C #18, BY OTHERS  
2" GSC IN TRENCH, BY OTHERS

HH 2402, TYPE S1  
STA 7104+65, BY OTHERS  
2/C #2, 1/C #6 GND  
2" GSC IN TRENCH  
2" GSC IN TRENCH (SPARE)  
2" GSC IN TRENCH (SPARE)

2/C #2, 1/C #6 GND, BY OTHERS  
2" GSC IN TRENCH, BY OTHERS  
2/C #4, 1/C #6 GND  
2" GSC IN TRENCH, BY OTHERS  
2" GSC IN TRENCH, BY OTHERS  
2/C #4, 1/C #6 GND, BY OTHERS  
2" GSC IN TRENCH (SPARE), BY OTHERS

HH 2403, TYPE S1  
STA 7103+19, BY OTHERS

RAMP METER SIGNAL, BY OTHERS  
ON WALL FOUNDATION, BY OTHERS  
(STA. 7102+75)

HH 2404, TYPE S1  
STA 7102+83, BY OTHERS  
RAMP METER FLASHER, BY OTHERS  
ON WOOD POST, BY OTHERS

3/C #12, BY OTHERS  
2" GSC IN TRENCH, BY OTHERS  
HH 2406, TYPE S1  
STA 7101+95, BY OTHERS  
3" PEC IN TRENCH, BY OTHERS

3" PEC IN TRENCH, BY OTHERS

(4) 4/C #18  
4/C #18, BY OTHERS

2" GSC IN TRENCH, BY OTHERS  
2" GSC IN TRENCH, BY OTHERS  
2" GSC IN TRENCH, BY OTHERS

(2) 3/C #12  
BY OTHERS  
3" GSC IN TRENCH  
BY OTHERS  
(3) 4/C #18  
BY OTHERS  
3" GSC IN TRENCH  
BY OTHERS  
(6) 4/C #18  
4/C #18, BY OTHERS  
3" GSC IN TRENCH  
BY OTHERS  
3" GSC IN TRENCH  
(SPARE) BY OTHERS

4/C #18, 3/C #12  
BY OTHERS  
2" GSC IN TRENCH  
BY OTHERS  
2" GSC IN TRENCH  
(SPARE) BY OTHERS

HH 2405, TYPE C1  
STA 7102+70,  
BY OTHERS

(2) 3/C #12, BY OTHERS  
2" GSC IN TRENCH, BY OTHERS

3/C #12, BY OTHERS  
2" GSC EMBEDDED IN WALL  
BY OTHERS  
RAMP METER SIGNAL ON TYPE  
A FOUNDATION, BY OTHERS  
(STA. 7102+75)  
3" PEC IN TRENCH, BY OTHERS

(6) 4/C #18  
4/C #18, BY OTHERS  
2" GSC IN TRENCH

MATCH LINE STA. 1376+00  
SEE SHEET DET-25

MATCH LINE STA. 1387+80  
SEE SHEET DET-25

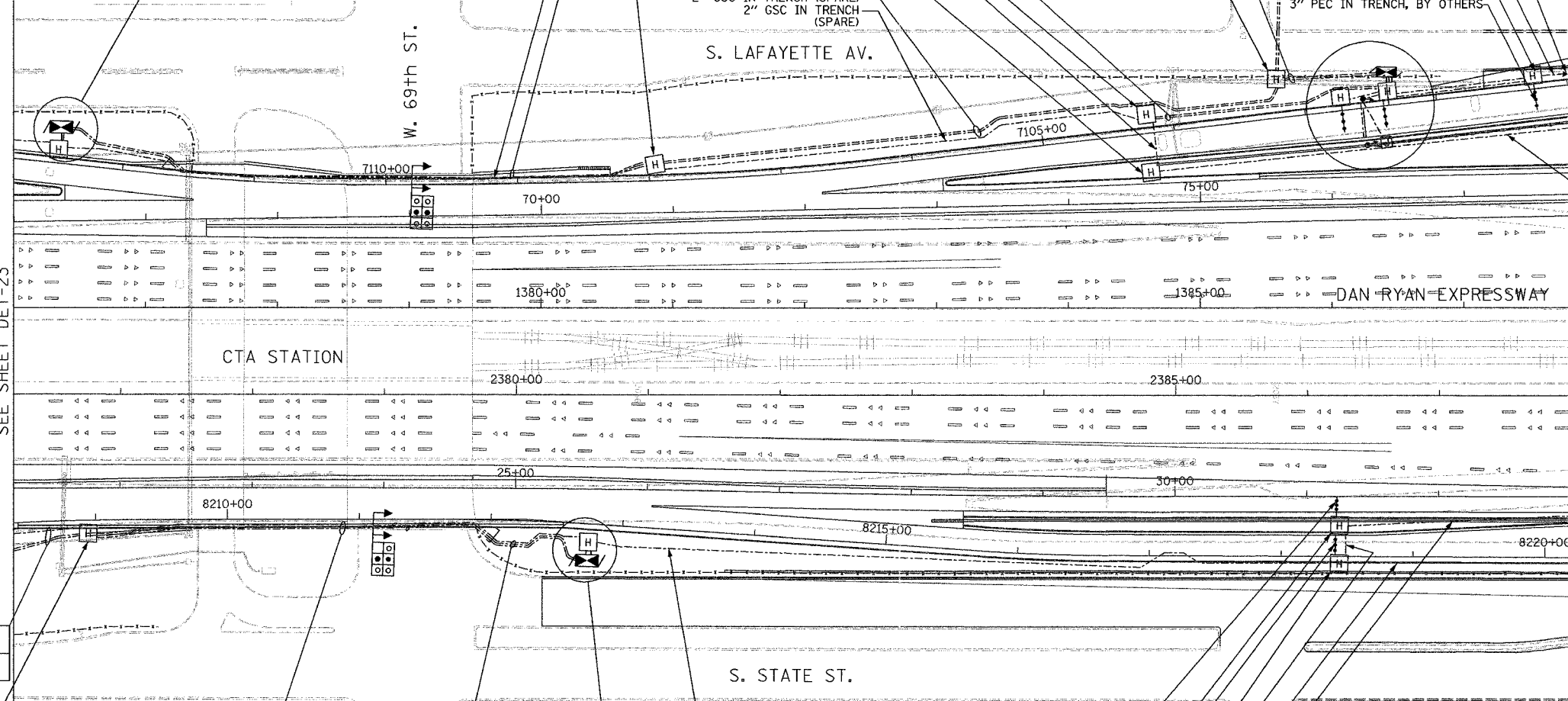

- NOTES:
- SEE DRAWING ME-01 AND ME-02 FOR ELECTRICAL SYSTEMS AND ABBREVIATIONS.
  - UNLESS OTHERWISE STATED, ALL NOTED CABLE AND CONDUIT TO BE FURNISHED AND INSTALLED UNDER THIS CONTRACT.
  - TRENCHED CONDUITS INSTALLED IN PARALLEL ARE TO BE INSTALLED IN COMMON TRENCH.
  - THIS SHEET ONLY DEPICTS INSTALLATION OF DETECTION/RAMP METER ELEMENTS. REFER TO SHEETS FOR OTHER SUBSYSTEMS FOR ADDITIONAL ELEMENTS IN THE AREA SHOWN.
  - CONTRACTOR TO ROD AND CLEAN EXISTING CONDUITS PRIOR TO INSTALLING AND PULLING INNERDUCTS AND CABLES IN CONDUITS.
  - DETECTION/RAMP METER CONDUIT SHALL NOT BE INSTALLED IN ELECTRIC HANDHOLES (SEE DETAIL SHEET DT-45).
  - FOR DETECTOR PROBE INSTALLATION DETAILS, SEE SHEETS DT-23 AND DT-28.
  - FOR HANDHOLE DETAILS, SEE SHEET DT-44 AND DT-46.
  - FOR WIRING DETAILS, SEE SHEETS DET-48 THROUGH DET-53

**Edwards AND Kelcey**  
ONE NORTH FRANKLIN  
CHICAGO, IL 60606  
PHONE: (312) 251-3000  
FAX: (312) 251-3015  
WEB: WWW.EKCORP.COM

(7) 4/C #18  
2" GSC IN TRENCH  
HH 2412, TYPE C1  
STA 8212+76  
(2) 4/C #18  
3" GSC IN TRENCH, BY OTHERS  
3" GSC IN TRENCH, BY OTHERS

PROPOSED SURVEILLANCE CABINET 50  
STA. 8212+75, 28RT  
CONCRETE FOUNDATION, TYPE 1  
CABINET, MODEL 334 EQUIPMENT,  
SYSTEM DETECTOR

3" PEC IN TRENCH, BY OTHERS  
SEE NOTE 7 FOR DETECTOR  
INSTALLATION DETAIL  
HH 2407, TYPE S1  
STA 31+20, BY OTHERS  
3" PEC IN TRENCH, BY OTHERS  
SEE NOTE 7 FOR DETECTOR  
INSTALLATION DETAIL  
HH 2408, TYPE S1  
STA 8218+40, BY OTHERS  
(6) 4/C #18  
2" GSC IN TRENCH, BY OTHERS  
2" GSC IN TRENCH (TO CDOT  
TRAFFIC SIGNAL CONTROLLER)  
(5) 4/C #18  
2" GSC IN TRENCH, BY OTHERS

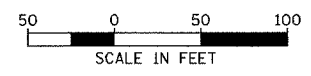

REVISIONS	
NAME	DATE

ILLINOIS DEPARTMENT OF TRANSPORTATION  
F.A.I. 94/90 (DAN RYAN EXPRESSWAY)  
31st STREET TO I-57  
SURVEILLANCE SYSTEM STATION  
RAMP METERING AND DETECTOR SYSTEM  
69TH ST. SITE LAYOUT  
DET-25, DET-26, DET-27, DET-28, RM-11, RM-12  
SCALE: 1"=50'  
DATE: October 29, 2004  
DRAWN BY: CJH  
CHECKED BY: MJL

DET-24

F:\03009035\VT\SCADD\DET20242E.SHT 11/23/2004 02:00:58 PM