

SECTION	COUNTY	TOTAL SHEETS	SHEET NO.
2003-0311	COOK	976	767
STA.	TO STA. 103+00.00		
FED. ROAD DIST. NO.	ILLINOIS	FED. AID PROJECT	
62583			

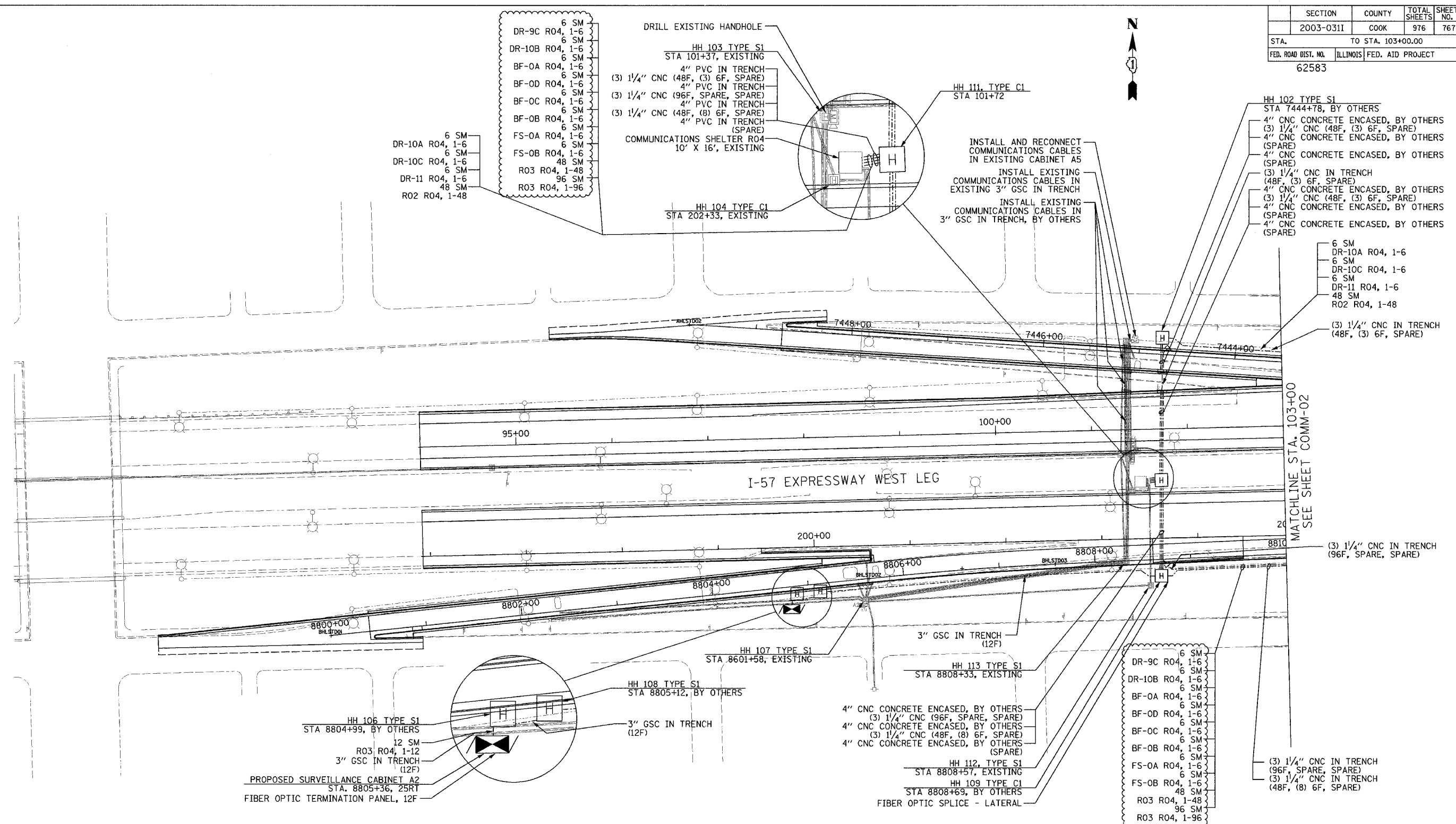

- 6 SM DR-9C R04, 1-6
- 6 SM DR-10B R04, 1-6
- 6 SM BF-0A R04, 1-6
- 6 SM BF-0D R04, 1-6
- 6 SM BF-0C R04, 1-6
- 6 SM BF-0B R04, 1-6
- 6 SM FS-0A R04, 1-6
- 6 SM FS-0B R04, 1-6
- 48 SM R03 R04, 1-48
- 96 SM R03 R04, 1-96

- 6 SM DR-10A R04, 1-6
- 6 SM DR-10C R04, 1-6
- 6 SM DR-11 R04, 1-6
- 48 SM R02 R04, 1-48

DRILL EXISTING HANDHOLE  
 HH 103 TYPE S1  
 STA 101+37, EXISTING  
 4" PVC IN TRENCH  
 (3) 1/4" CNC (48F, (3) 6F, SPARE)  
 4" PVC IN TRENCH  
 (3) 1/4" CNC (96F, SPARE, SPARE)  
 4" PVC IN TRENCH  
 (3) 1/4" CNC (48F, (8) 6F, SPARE)  
 COMMUNICATIONS SHELTER R04  
 10' X 16', EXISTING  
 HH 104 TYPE C1  
 STA 202+33, EXISTING  
 HH 111 TYPE C1  
 STA 101+72  
 INSTALL AND RECONNECT  
 COMMUNICATIONS CABLES  
 IN EXISTING CABINET A5  
 INSTALL EXISTING  
 COMMUNICATIONS CABLES IN  
 EXISTING 3" GSC IN TRENCH  
 INSTALL EXISTING  
 COMMUNICATIONS CABLES IN  
 3" GSC IN TRENCH, BY OTHERS

HH 102 TYPE S1  
 STA 7444+78, BY OTHERS  
 4" CNC CONCRETE ENCASED, BY OTHERS  
 (3) 1/4" CNC (48F, (3) 6F, SPARE)  
 4" CNC CONCRETE ENCASED, BY OTHERS  
 (SPARE)  
 4" CNC CONCRETE ENCASED, BY OTHERS  
 (SPARE)  
 (3) 1/4" CNC IN TRENCH  
 (48F, (3) 6F, SPARE)  
 4" CNC CONCRETE ENCASED, BY OTHERS  
 (3) 1/4" CNC (48F, (3) 6F, SPARE)  
 4" CNC CONCRETE ENCASED, BY OTHERS  
 (SPARE)  
 4" CNC CONCRETE ENCASED, BY OTHERS  
 (SPARE)

- 6 SM DR-10A R04, 1-6
- 6 SM DR-10C R04, 1-6
- 6 SM DR-11 R04, 1-6
- 48 SM R02 R04, 1-48
- (3) 1/4" CNC IN TRENCH  
(48F, (3) 6F, SPARE)

MATCHLINE STA. 103+00  
 SEE SHEET COMM-02

- (3) 1/4" CNC IN TRENCH  
(96F, SPARE, SPARE)

HH 106 TYPE S1  
 STA 8804+99, BY OTHERS  
 12 SM R03 R04, 1-12  
 3" GSC IN TRENCH  
 (12F)  
 PROPOSED SURVEILLANCE CABINET A2  
 STA. 8805+36, 25RT  
 FIBER OPTIC TERMINATION PANEL, 12F

HH 108 TYPE S1  
 STA 8805+12, BY OTHERS  
 3" GSC IN TRENCH  
 (12F)

HH 107 TYPE S1  
 STA 8601+58, EXISTING

3" GSC IN TRENCH  
 (12F)

4" CNC CONCRETE ENCASED, BY OTHERS  
 (3) 1/4" CNC (96F, SPARE, SPARE)  
 4" CNC CONCRETE ENCASED, BY OTHERS  
 (3) 1/4" CNC (48F, (8) 6F, SPARE)  
 4" CNC CONCRETE ENCASED, BY OTHERS  
 (SPARE)

HH 112, TYPE S1  
 STA 8808+57, EXISTING  
 HH 109 TYPE C1  
 STA 8808+69, BY OTHERS  
 FIBER OPTIC SPLICE - LATERAL

- 6 SM DR-9C R04, 1-6
- 6 SM DR-10B R04, 1-6
- 6 SM BF-0A R04, 1-6
- 6 SM BF-0D R04, 1-6
- 6 SM BF-0C R04, 1-6
- 6 SM BF-0B R04, 1-6
- 6 SM FS-0A R04, 1-6
- 6 SM FS-0B R04, 1-6
- 48 SM R03 R04, 1-48
- 96 SM R03 R04, 1-96

- (3) 1/4" CNC IN TRENCH  
(96F, SPARE, SPARE)
- (3) 1/4" CNC IN TRENCH  
(48F, (8) 6F, SPARE)

NOTES:

1. SEE DRAWING ME-01 AND ME-02 FOR ELECTRICAL SYSTEMS AND ABBREVIATIONS.
2. UNLESS OTHERWISE STATED, ALL NOTED CABLE AND CONDUIT TO BE FURNISHED AND INSTALLED UNDER THIS CONTRACT.
3. TRENCHED CONDUITS INSTALLED IN PARALLEL ARE TO BE INSTALLED IN COMMON TRENCH.
4. THIS SHEET ONLY DEPICTS INSTALLATION OF COMMUNICATIONS ELEMENTS. REFER TO SHEETS FOR OTHER SUBSYSTEMS FOR ADDITIONAL ELEMENTS IN THE AREA SHOWN.
5. CONTRACTOR TO ROD AND CLEAN EXISTING CONDUITS PRIOR TO INSTALLING AND PULLING INNERDUCTS AND CABLES IN CONDUITS.
6. COMMUNICATIONS CONDUIT SHALL NOT BE INSTALLED IN ELECTRIC HANDHOLES (SEE DETAIL SHEET DT-45).
7. FOR HANDHOLE DETAILS, SEE SHEET DT-44 AND DT-46.

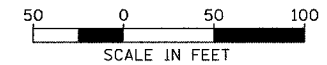

COMM-01



REVISIONS	
NAME	DATE
REVISION 1	12/17/04

ILLINOIS DEPARTMENT OF TRANSPORTATION  
 F.A.I. 94/90 (DAN RYAN EXPRESSWAY)  
 31st STREET to I-57  
 COMMUNICATIONS BACKBONE CONDUIT  
 AND CABLE LAYOUT  
 SCALE: 1"=50'  
 DATE: October 29, 2004  
 DRAWN BY: YAD  
 CHECKED BY: JEZ

12/15/2004 03:22:31 PM