

SECTION	COUNTY	TOTAL SHEETS	SHEET NO.
2003-0311	COOK	976	814
STA. 1644+00	TO STA.		
FED. ROAD DIST. NO.	ILLINOIS	FED. AID PROJECT	
		62583	

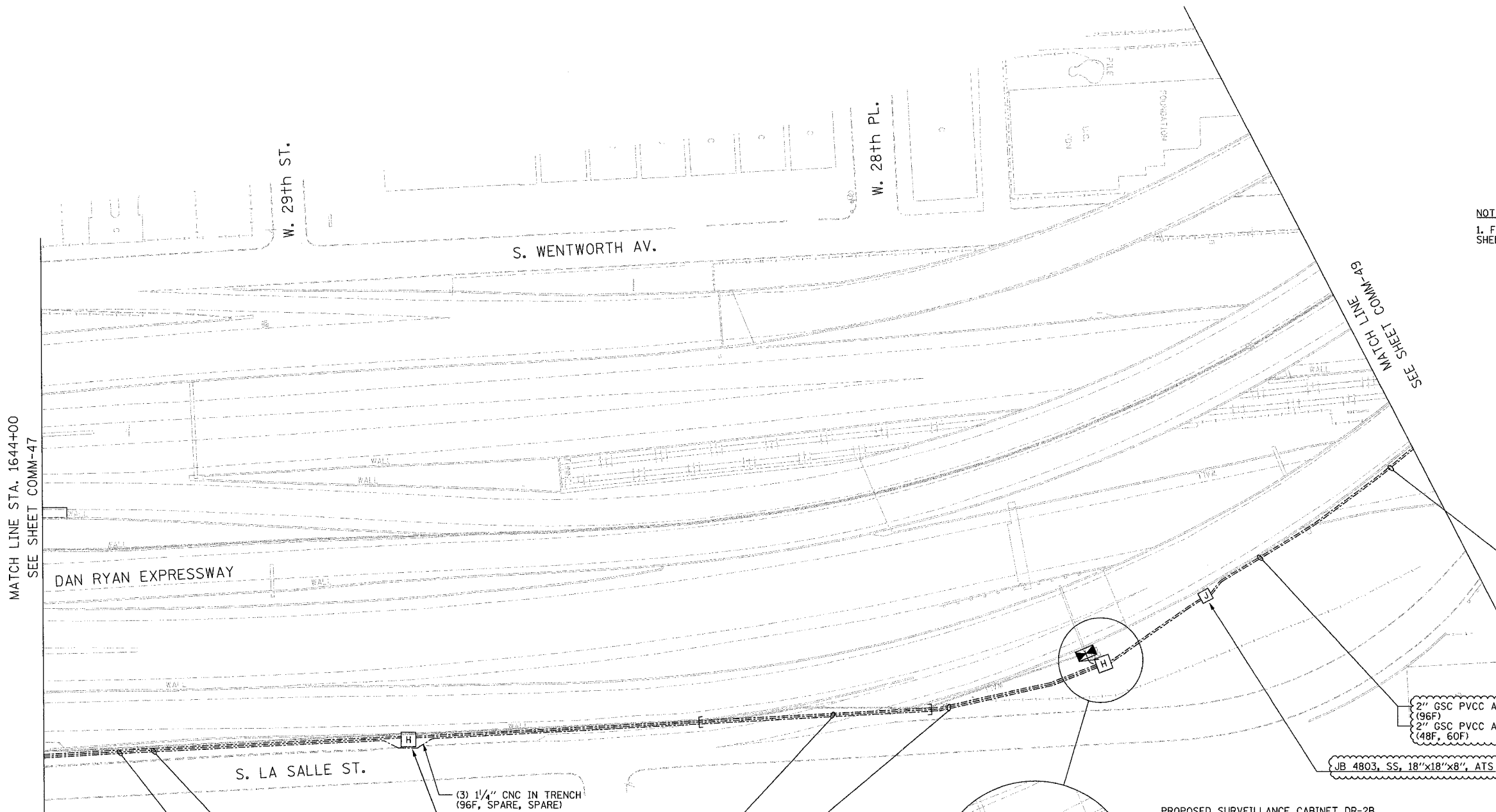

NOTES:
1. FOR CONDUIT ATTACHMENT DETAILS, SEE SHEET DT-52.

MATCH LINE STA. 1644+00
SEE SHEET COMM-47

SEE MATCH LINE
COMM-49

- 48 SM
- RO1 R03, 1-48
- 48 SM
- RO1 R02, 1-48
- 12 SM
- RO1 ETP, 1-12
- 96 SM
- RO1 R03, 1-96

2" GSC PVCC ATS (NOTE 1)
(96F)
2" GSC PVCC ATS (NOTE 1)
(48F, 60F)

JB 4803, SS, 18"x18"x8", ATS

- (3) 1/4" CNC IN TRENCH (48F, 6F, SPARE)
- (3) 1/4" CNC IN TRENCH (60F, SPARE, SPARE)
- (3) 1/4" CNC IN TRENCH (96F, SPARE, SPARE)
- 6 SM
- CCTV-14 R03, 1-6
- 48 SM
- RO1 R03, 1-48
- 48 SM
- RO1 R02, 1-48
- 12 SM
- RO1 ETP, 1-12
- 96 SM
- RO1 R03, 1-96

(3) 1/4" CNC IN TRENCH (96F, SPARE, SPARE)
HH 4801 TYPE S1

- 4" CNC PUSHED
- (3) 1/4" CNC (96F, SPARE, SPARE)
- 4" CNC PUSHED
- (3) 1/4" CNC (60F, SPARE, SPARE)
- 4" CNC PUSHED
- (3) 1/4" CNC (48F, 6F, SPARE)
- (3) 1/4" CNC IN TRENCH (96F, SPARE, SPARE)
- (3) 1/4" CNC IN TRENCH (60F, SPARE, SPARE)
- (3) 1/4" CNC IN TRENCH (60F, SPARE, SPARE)
- (3) 1/4" CNC IN TRENCH (48F, 6F, SPARE)

- 1/4" CNC IN TRENCH (6F)
- (3) 1/4" CNC IN TRENCH (60F, SPARE, SPARE)
- (3) 1/4" CNC IN TRENCH (48F, 6F, SPARE)
- (3) 1/4" CNC IN TRENCH (96F, SPARE, SPARE)

PROPOSED SURVEILLANCE CABINET DR-2B

2" GSC IN TRENCH (48F, 60F)
2" GSC IN TRENCH (96F)

HH 4802 TYPE C1



SCALE IN FEET COMM-48

Edwards AND Kelcey
ONE NORTH FRANKLIN
CHICAGO, IL 60606
PHONE: (312) 251-3000
FAX: (312) 251-3015
WEB: WWW.EKCORP.COM

REVISIONS	
NAME	DATE
REVISION 1	12/17/04

ILLINOIS DEPARTMENT OF TRANSPORTATION
F.A.I. 94/90 (DAN RYAN EXPRESSWAY)
31st STREET to I-57

COMMUNICATIONS BACKBONE CONDUIT
AND CABLE LAYOUT

SCALE: 1"=50'
DATE: October 29, 2004
DRAWN BY: DHI
CHECKED BY: MJL

P:\030019\0305\116\road\comm\020488a.dwg 12/10/2004 02:48:17 PM