

PLAN SURVEYED BY DATE
 NOTE BOOK ALIGNED CHECKED
 NO. FILE NAME

PLAN SURVEYED BY DATE
 NOTE BOOK ALIGNED CHECKED
 NO. FILE NAME

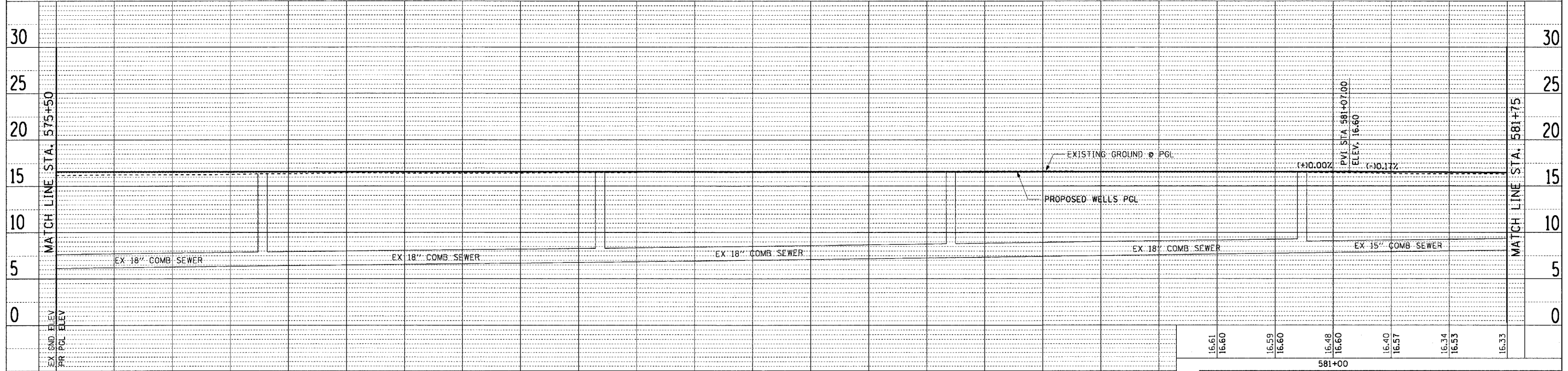
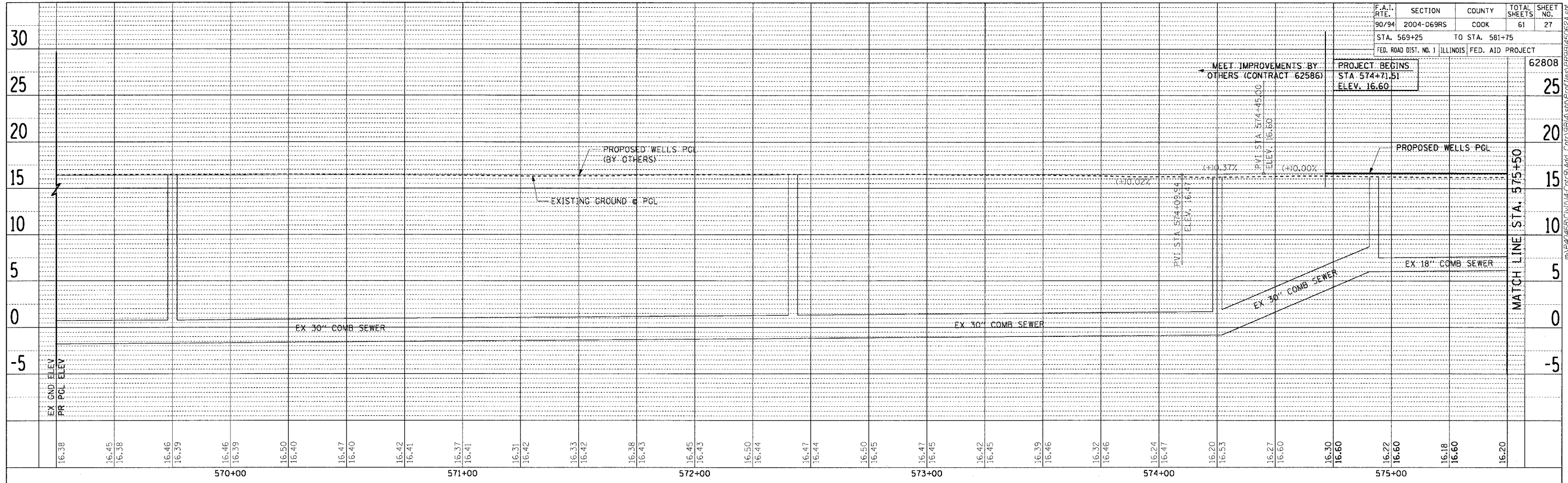

F.A.I. RTE.	SECTION	COUNTY	TOTAL SHEETS	SHEET NO.
90/94	2004-069RS	COOK	61	27
STA. 569+25		TO STA. 581+75		
FED. ROAD DIST. NO. 1 ILLINOIS FED. AID PROJECT				

MEET IMPROVEMENTS BY OTHERS (CONTRACT 62586)
 PROJECT BEGINS
 STA 574+71.51
 ELEV. 16.60

PVI STA 574+09.94
 ELEV. 16.47

PVI STA 574+45.00
 ELEV. 16.60

PVI STA 581+07.00
 ELEV. 16.60

(+10.37%)

(+10.02%)

(+10.00%)

(+10.00%)

(+10.17%)

EX 30" COMB SEWER

EX 30" COMB SEWER

EX 30" COMB SEWER

EX 18" COMB SEWER

PROPOSED WELLS PGL
 (BY OTHERS)

EXISTING GROUND PGL

PROPOSED WELLS PGL

EXISTING GROUND PGL

EX 18" COMB SEWER

EX 18" COMB SEWER

EX 18" COMB SEWER

EX 18" COMB SEWER

EX 15" COMB SEWER

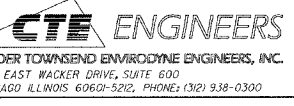

REVISIONS	
NAME	DATE

ILLINOIS DEPARTMENT OF TRANSPORTATION
 F.A.I. 90/94 (DAN RYAN EXPRESSWAY)
 59th ST TO 47th ST (FRONTAGE ROAD)

PROPOSED PROFILE
 WELLS STREET

SCALE: H: 1"=20', V: 1"=5'
 DATE: December 17, 2004
 DRAWN BY: PHP
 CHECKED BY: JAL

1 OF 2

12/15/2004 4:35:36 PM