

I-90/94 NB EXPRESS LANES

F.A.I. RTE.	SECTION	COUNTY	TOTAL SHEETS	SHEET NO.
90/94	2004-073RS	COOK	74	24
STA. 183+00		TO STA. 188+00		
FED. ROAD DIST. NO. 1 ILLINOIS FED. AID PROJECT				

62812

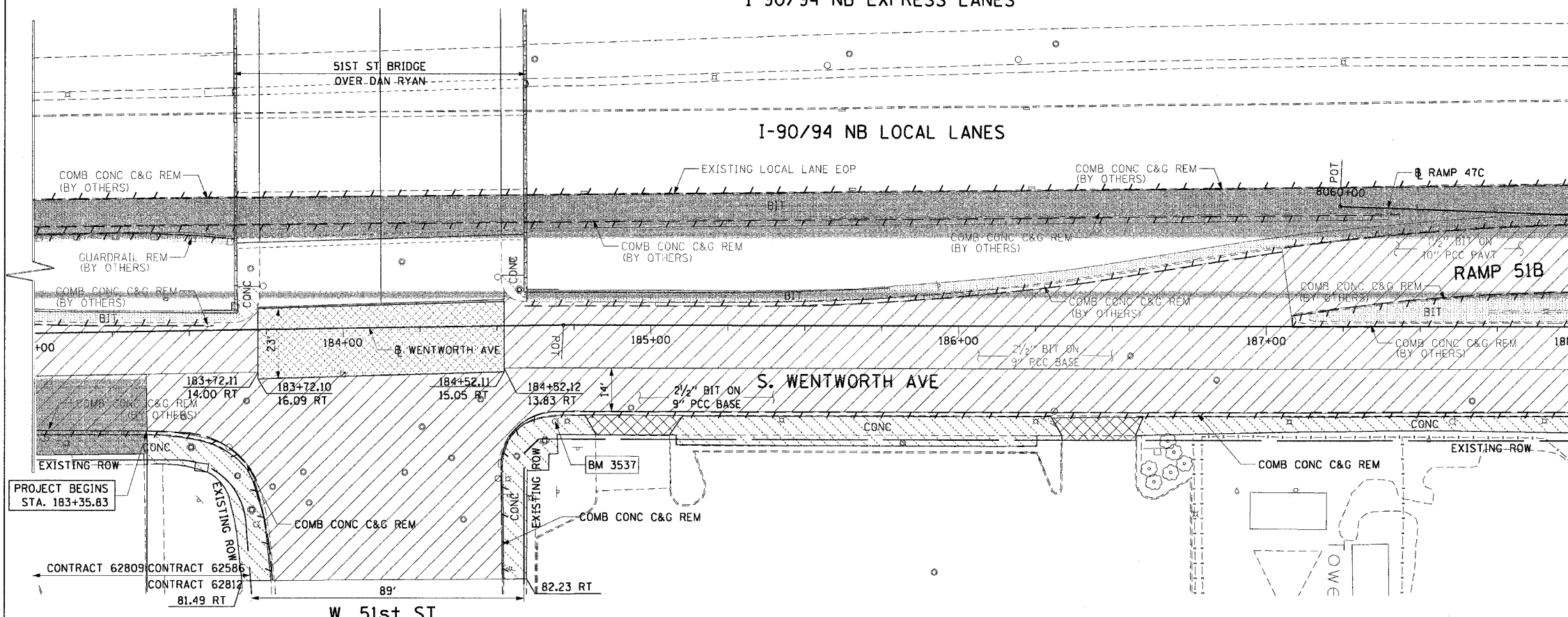

MATCH LINE STA 188+00

- LEGEND:
- PAVEMENT REMOVAL
 - LINEAR REMOVALS
 - SIDEWALK REMOVAL
 - APPROACH SLAB REMOVAL
 - DRIVEWAY PAVEMENT REMOVAL
 - WORK TO BE DONE BY OTHERS

- NOTES:
- CONTRACTOR SHALL COORDINATE WITH CONTRACT 62807 FOR ROADWAY LIGHTING REMOVALS AND INSTALLATIONS.
 - CONTRACTOR SHALL COORDINATE WITH CONTRACT 62803 FOR TRAFFIC SIGNAL REMOVALS AND IMPROVEMENTS.
 - SEE DRAINAGE AND UTILITY SHEETS FOR REMOVALS AND IMPROVEMENTS.
 - CONTRACTOR SHALL COORDINATE WITH CONTRACT 62798 FOR FRONTAGE ROAD SIGNING.
 - ALL DRIVEWAYS SHOWN ARE CONCRETE UNLESS NOTED OTHERWISE.

EXISTING CONDITIONS AND REMOVAL PROPOSED IMPROVEMENTS

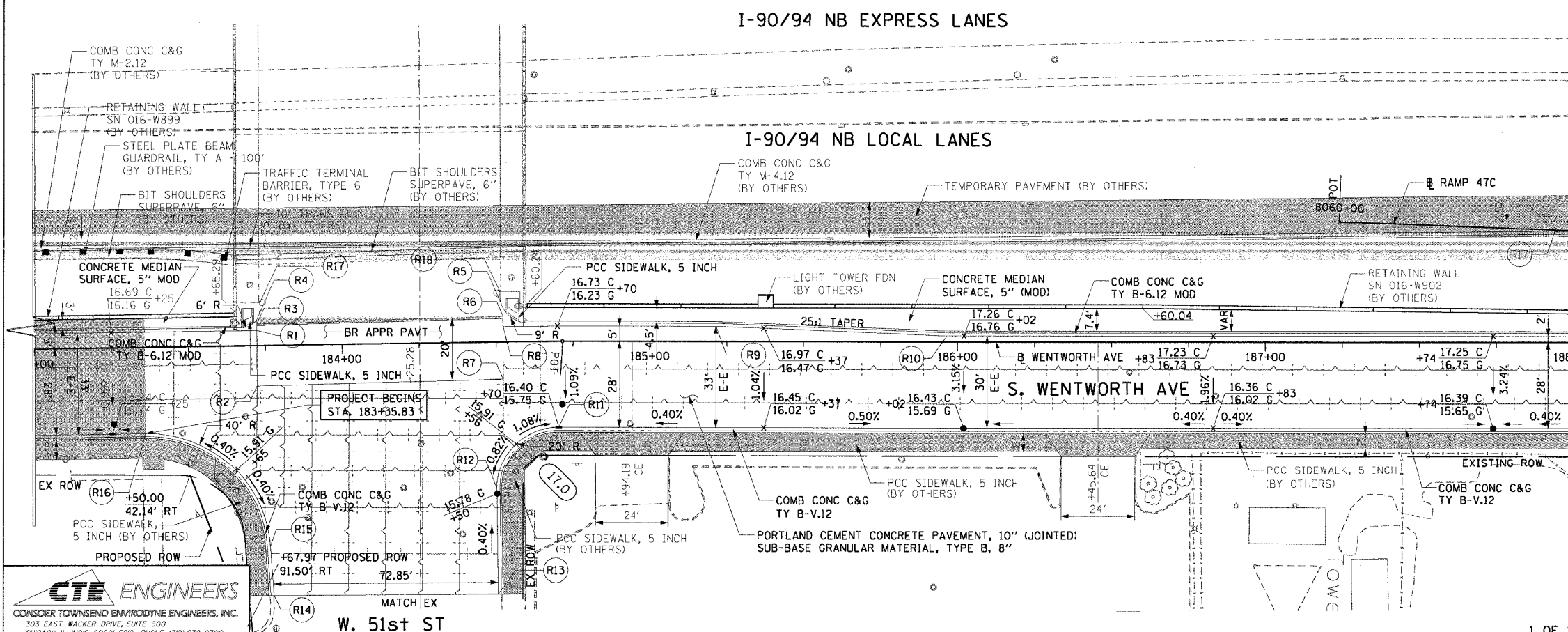

MATCH LINE STA 188+00

- LEGEND:
- WORK TO BE DONE BY OTHERS
 - DEPRESSED CURB

- NOTES:
- SEE ROADWAY DETAIL SHEETS FOR CONCRETE MEDIAN SURFACE, 5" MODIFIED
 - SEE APPROACH PAVEMENT SHEETS FOR BRIDGE APPROACH PAVEMENT DETAILS.
 - CONTRACTOR SHALL COORDINATE WITH CONTRACT 62796 FOR SIDEWALK AND DRIVEWAY IMPROVEMENTS.
 - CONTRACTOR SHALL COORDINATE WITH CONTRACT 62809.
 - SEE INTERSECTION DETAIL SHEET FOR INTERSECTION GRADING.

PT.	STATION	OFFSET	PT.	STATION	OFFSET
R1	183+72.34	5.00' LT	R10	185+96.46	2.00' LT
R2	183+72.13	13.09' RT	R11	184+69.91	28.00' RT
R3	183+72.32	7.10' LT	R12	184+49.59	47.65' RT
R4	184+51.60	27.95' LT	R13	184+49.56	82.16' RT
R5	184+52.41	11.15' LT	R14	183+76.71	81.57' RT
R6	184+52.40	8.40' LT	R15	183+75.76	65.60' RT
R7	185+52.15	12.05' RT	R16	183+35.83	28.00' RT
R8	184+52.34	5.04' LT	R17	183+73.44	13.97' LT
R9	185+21.46	5.00' LT	R18	184+51.47	16.41' LT

REVISIONS	
NAME	DATE

ILLINOIS DEPARTMENT OF TRANSPORTATION
 F.A.I. 90/94 (DAN RYAN EXPRESSWAY)
 51st ST (WENTWORTH AVE AND WELLS ST)
 EXISTING AND PROPOSED ROADWAY PLANS
 WENTWORTH AVENUE

SCALE: 1"=20'
 DATE: December 23, 2004
 DRAWN BY: LC
 CHECKED BY: JAL

CTE ENGINEERS
 CONSOER TOWNSEND ENVIRONMENTAL ENGINEERS, INC.
 303 EAST WALKER DRIVE, SUITE 600
 CHICAGO, ILLINOIS 60601-3522, PHONE: (312) 938-0300

12/23/2004 3:41:11 PM