

F.A.I. RTE.	SECTION	COUNTY	TOTAL SHEETS	SHEET NO.
90/94	2004-073RS	COOK	74	26
STA. 586+50		TO STA. 591+25		
FED. ROAD DIST. NO. 1 ILLINOIS FED. AID PROJECT				

62812

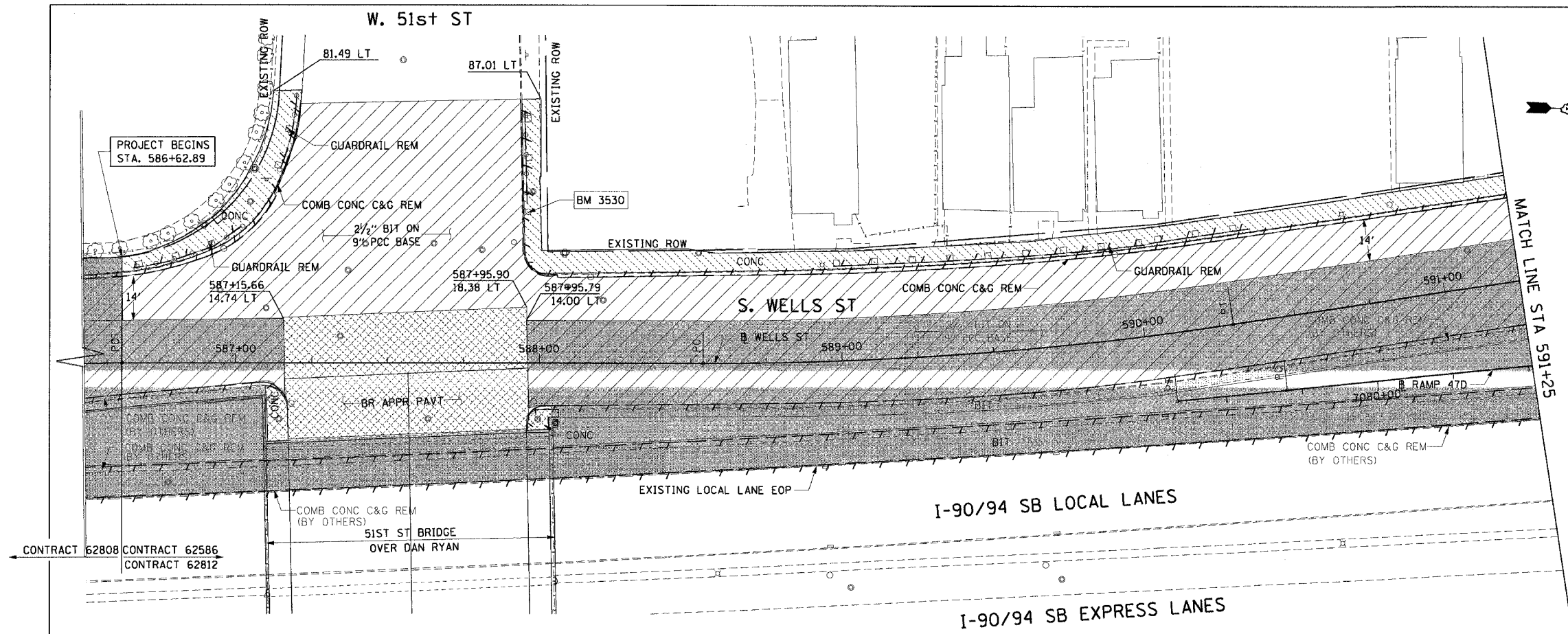

LEGEND:

- PAVEMENT REMOVAL
- MEDIAN REMOVAL
- LINEAR REMOVALS
- SIDEWALK REMOVAL
- APPROACH SLAB REMOVAL
- DRIVEWAY PAVEMENT REMOVAL
- WORK TO BE DONE BY OTHERS

NOTES:

1. CONTRACTOR SHALL COORDINATE WITH CONTRACT 62806 FOR ROADWAY LIGHTING REMOVALS AND INSTALLATIONS.
2. CONTRACTOR SHALL COORDINATE WITH CONTRACT 62803 FOR TRAFFIC SIGNAL REMOVALS AND IMPROVEMENTS.
3. SEE DRAINAGE AND UTILITY SHEETS FOR REMOVALS AND IMPROVEMENTS.
4. CONTRACTOR SHALL COORDINATE WITH CONTRACT 62798 FOR FRONTAGE ROAD SIGNING.

EXISTING CONDITIONS AND REMOVAL PROPOSED IMPROVEMENTS

LEGEND:

- WORK TO BE DONE BY OTHERS
- DEPRESSED CURB

NOTES:

1. SEE ROADWAY DETAIL SHEETS FOR CONCRETE MEDIAN SURFACE, 5" MOD.
2. SEE APPROACH PAVEMENT SHEETS FOR BRIDGE APPROACH PAVEMENT DETAILS.
3. CONTRACTOR SHALL COORDINATE WITH CONTRACT 62795 FOR SIDEWALK AND DRIVEWAY IMPROVEMENTS.
4. CONTRACTOR SHALL COORDINATE WITH CONTRACT 62808.
5. SEE INTERSECTION DETAIL SHEET FOR INTERSECTION GRADING.

PT.	STATION	OFFSET	PT.	STATION	OFFSET
R1	586+62.89	28.00' LT	R10	587+96.98	14.00' RT
R2	587+22.80	84.72' LT	R11	587+97.05	17.77' RT
R3	587+92.78	86.12' LT	R12	587+96.41	18.40' LT
R4	587+93.75	37.80' LT	R13	587+96.14	21.65' RT
R5	588+03.75	28.00' LT	R14	587+18.16	24.93' RT
R6	588+54.10	28.00' LT	R15	587+16.89	9.74' RT
R7	590+29.55	28.00' LT	R16	587+16.79	4.00' RT
R8	589+99.14	14.00' RT	R17	587+16.45	15.03' LT
R9	588+54.10	14.00' RT			

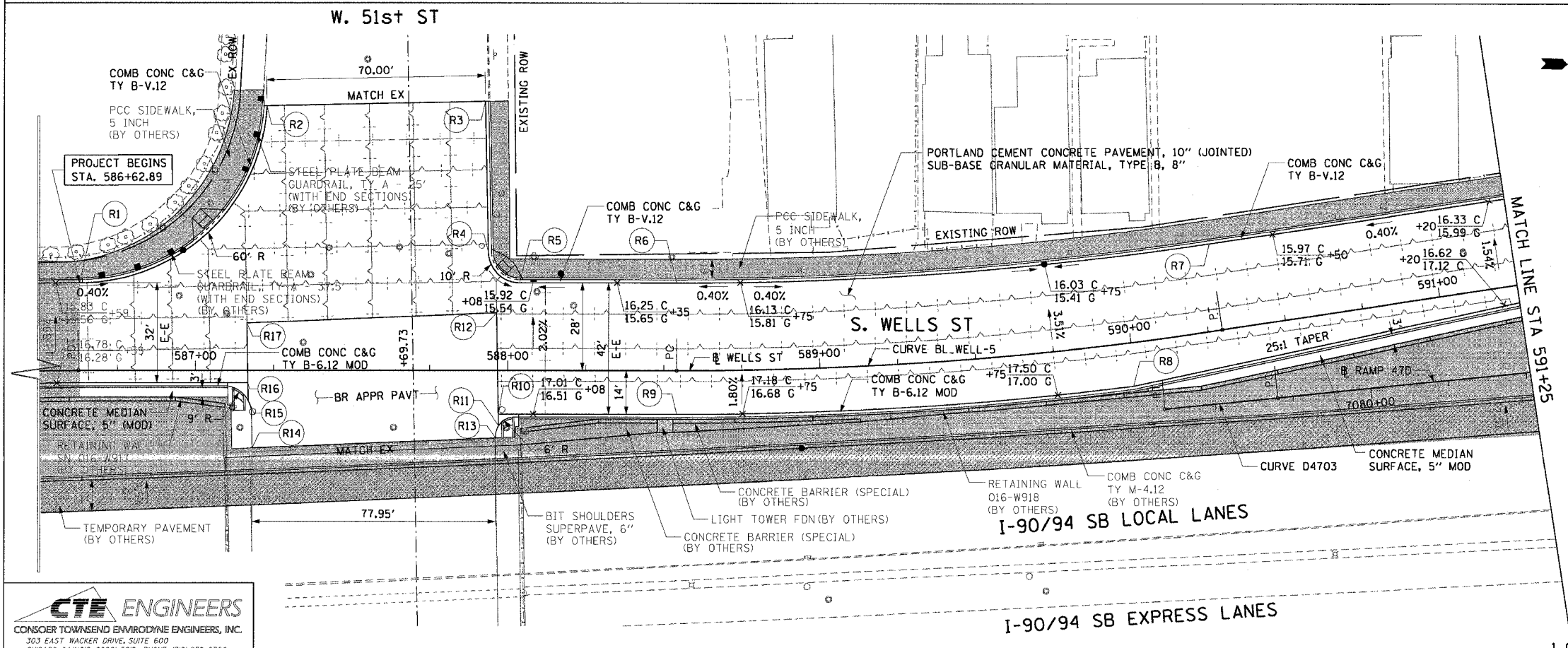

REVISIONS	DATE

ILLINOIS DEPARTMENT OF TRANSPORTATION
 F.A.I. 90/94 (DAN RYAN EXPRESSWAY)
 51st ST (WENTWORTH AVE AND WELLS ST)
 EXISTING AND PROPOSED ROADWAY PLANS
 WELLS STREET

SCALE: 1"=20'
 DATE: December 23, 2004

DRAWN BY: LC
 CHECKED BY: JAL