

DATE  
BY  
CHECKED  
DATE  
NO.

DATE  
BY  
CHECKED  
DATE  
NO.

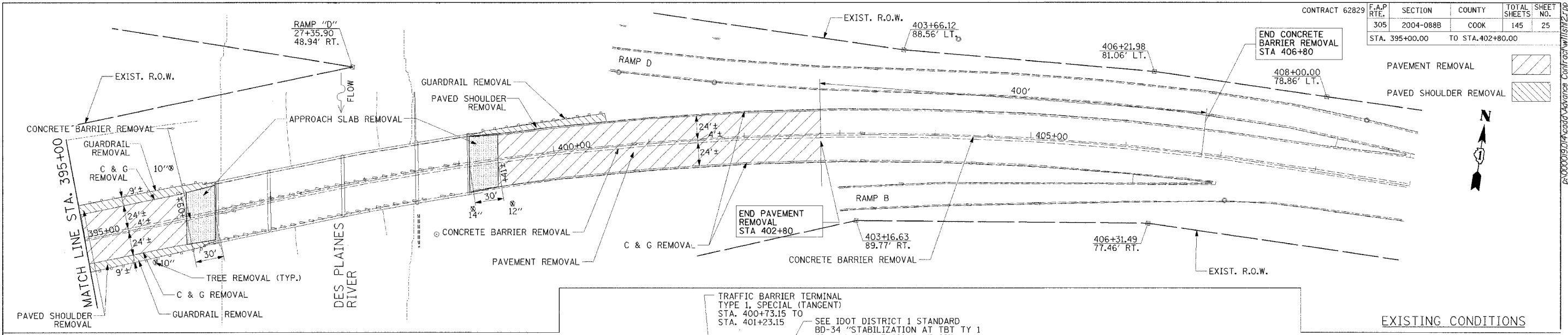

NOTES:  
1. FOR SCHEDULE OF QUANTITIES, SEE DRAWING SCH-1 THROUGH SCH-6  
2. FOR THE WILLOW RD. BRIDGE OVER DES PLAINES RIVER DETAILS, SEE DRAWINGS SB-1 THROUGH SB-44

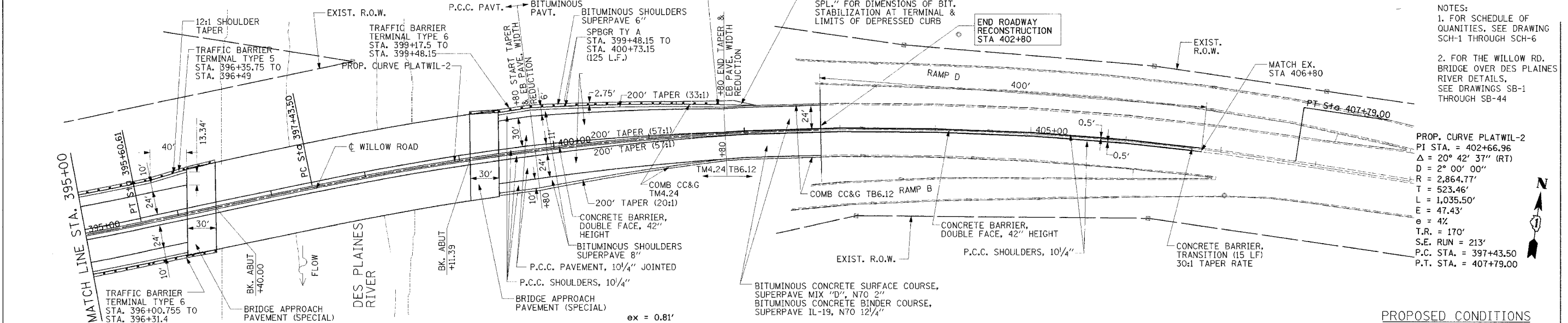

PROP. CURVE PLATWIL-2  
PI STA. = 402+66.96  
 $\Delta = 20^\circ 42' 37''$  (RT)  
D = 2° 00' 00"  
R = 2,864.77'  
L = 523.46'  
E = 1,035.50'  
T = 47.43'  
 $\theta = 4^\circ$   
T.R. = 170'  
S.E. RUN = 213'  
P.C. STA. = 397+43.50  
P.T. STA. = 407+79.00

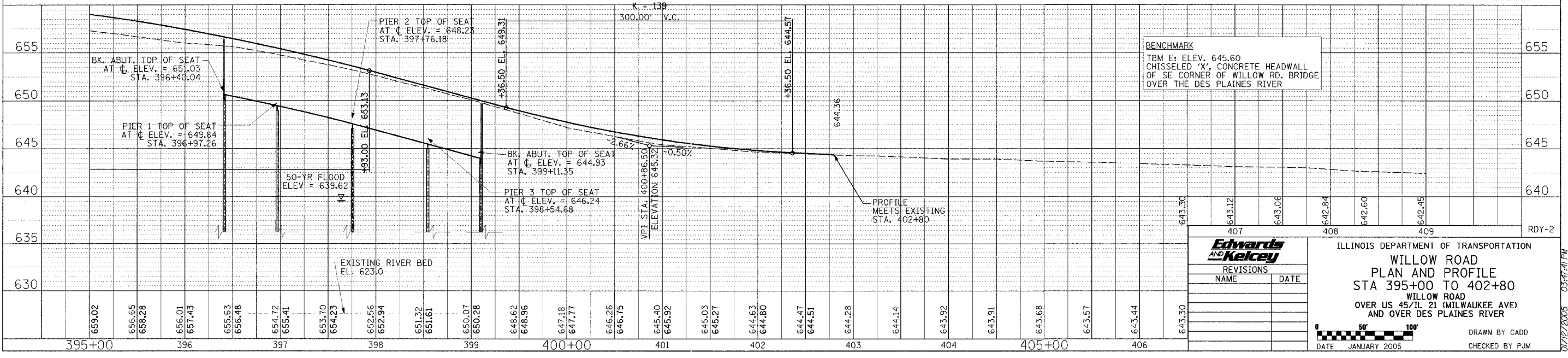

ILLINOIS DEPARTMENT OF TRANSPORTATION  
WILLOW ROAD  
PLAN AND PROFILE  
STA 395+00 TO 402+80  
WILLOW ROAD  
OVER US 45/IL 21 (MILWAUKEE AVE)  
AND OVER DES PLAINES RIVER

Edwards and Kelcey

REVISIONS  
NAME DATE

DATE JANUARY 2005  
DRAWN BY CADD  
CHECKED BY PJM