

STATE OF ILLINOIS
DEPARTMENT OF TRANSPORTATION

CONTRACT 62829

FAULTR. NO.	SECTION	COUNTY	TOTAL SHEETS	SHEET NO.
305	2004-088B	COOK	145	57
FED. ROAD DIST. NO. 1		ILLINOIS FED. AID PROJECT		

SHEET NO. SA-4
OF SHEETS SA-30

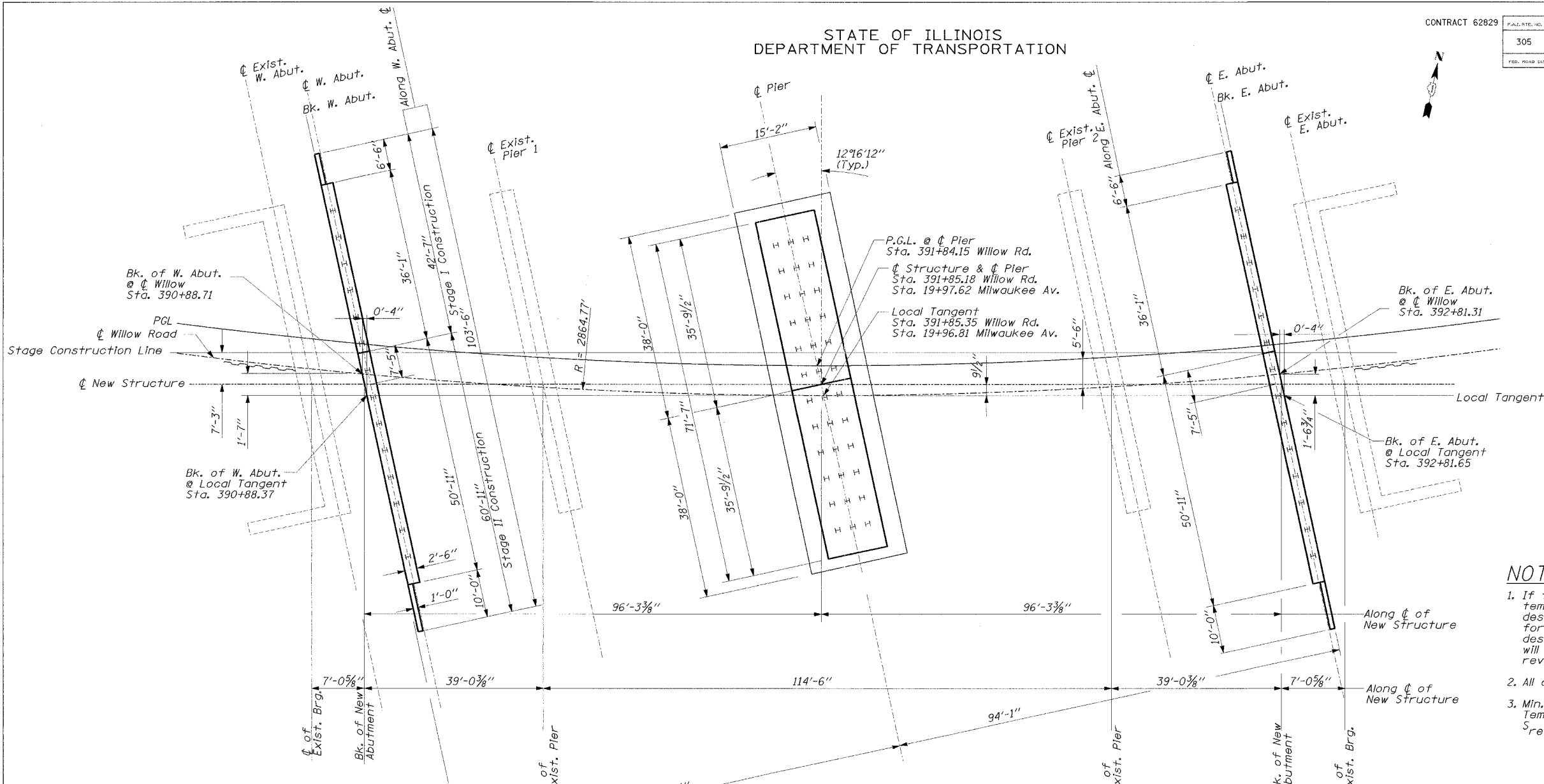

NOTES:

1. If the contractor chooses to alter the temporary cantilevered sheet piling design requirements shown on the plans for lesser design requirements, then full design submittals with the required seals will be expected by the Department, for review and approval.
2. All dimensions are in feet (ft.).
3. Min. Required Section Modulus for Temporary Sheet Piling $S_{req'd} = 21.8 \text{ in}^3/\text{ft}$

FOOTING LAYOUT

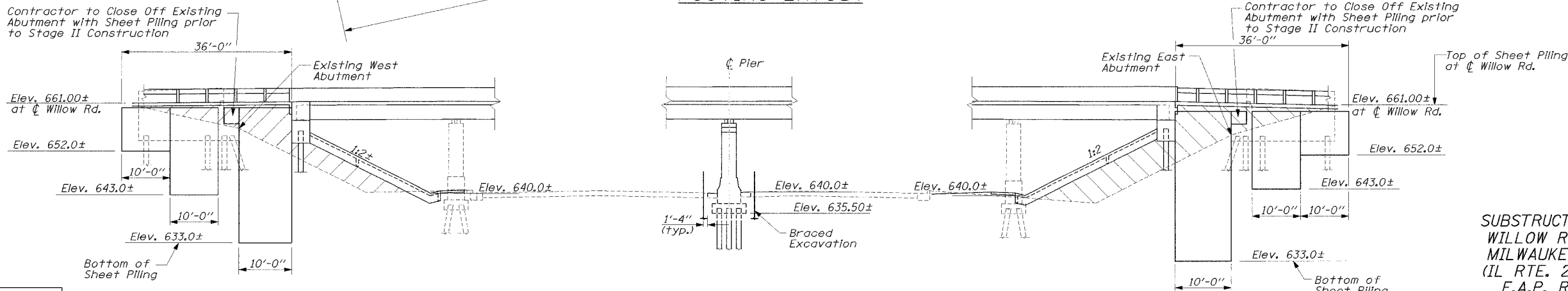

ELEVATION

DESIGNED	AJN
CHECKED	JAP
DRAWN	ABW
CHECKED	EL

SUBSTRUCTURE LAYOUT
WILLOW ROAD OVER
MILWAUKEE AVENUE
(IL RTE. 21/U.S. 45)
F.A.P. RTE. 305
SECTION 2004-088B
COOK COUNTY
STA. 391+71.02 @ WILLOW RD.
STR. NO. 016-2786

EDWARDS AND KELCEY

12/28/2004 11:53 AM

P:\0000\9104\adv\adv\Contract\Adv\Structural\Milwaukee\Planesh\016-2786.dwg