

STATE OF ILLINOIS
DEPARTMENT OF TRANSPORTATION

CONTRACT 62829

F.A.P. RTE. NO.	SECTION	COUNTY	TOTAL SHEETS	SHEET NO.
305	2004-088B	COOK	145	95
FED. ROAD DIST. NO. 1	ALLENDS	FED. AID PROJECT		

SHEET NO. SB-12
OF SHEETS SB-44

01/17/2005 10:02:17 AM

P:\000000\03\A\road\Advances\Caltrans\AdvStructural\Des\Planes-Plan_Sel.dwg:shs2.dwg

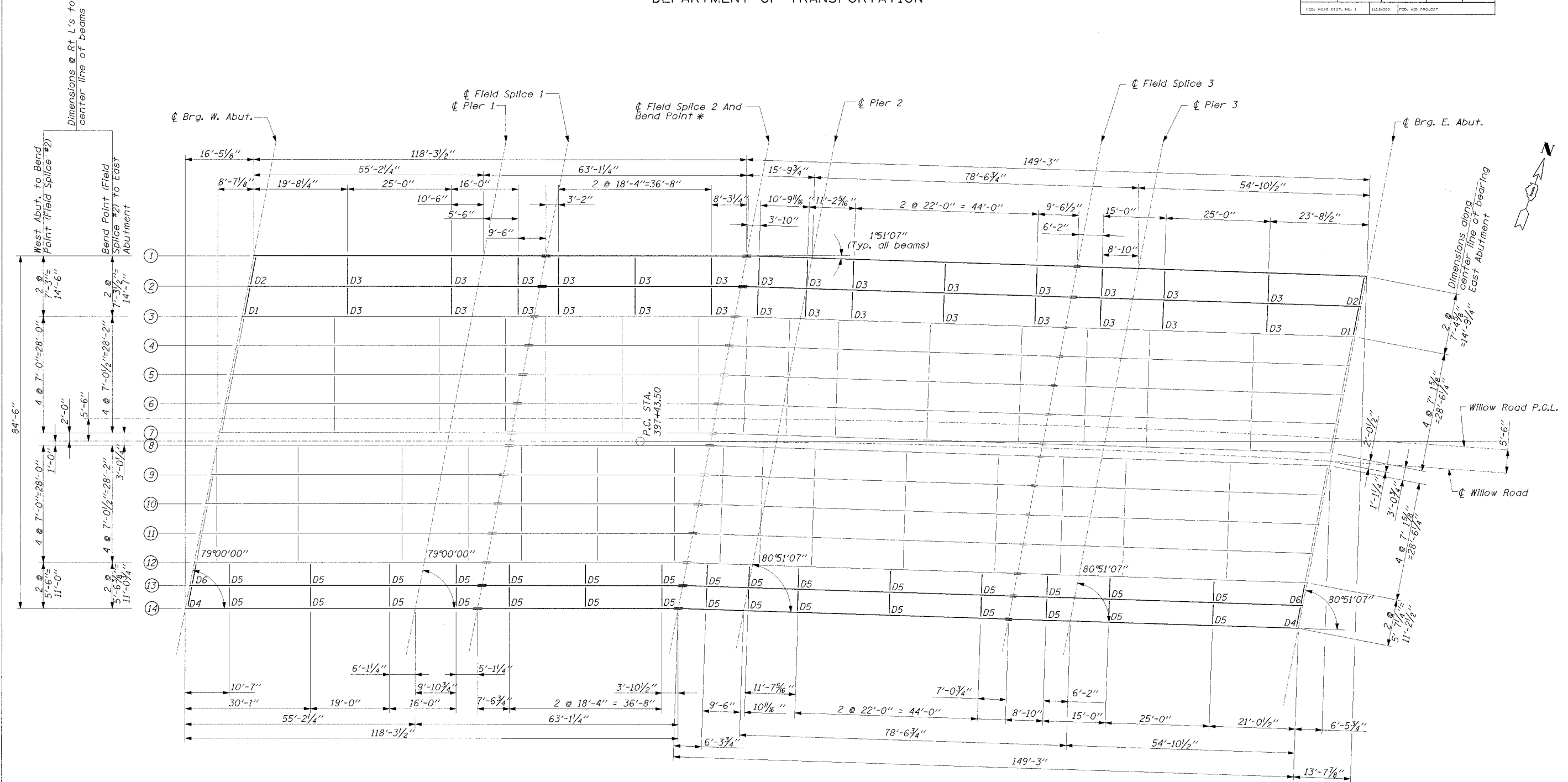

FRAMING PLAN

* ϕ of all beams bends by $1^{\circ}51'07''$ as shown in plan.
Bend accommodated at splice location by using bent plates.

DESIGNED	EL
CHECKED	JAS
DRAWN	ABW
CHECKED	EL

FRAMING PLAN
WILLOW ROAD OVER
DES PLAINES RIVER
F.A.P. RTE. 305
SECTION 2004-088B
COOK COUNTY
STA. 397+76.18
STR. NO. 016-0530

EDWARDS AND KELCEY