

62829

F.A.P. RTE.	SECTION	COUNTY	TOTAL SHEETS	SHEET NO.
305	211 K-R-1	COOK	145	131
STA. 395+00.00		TO STA. 409+00.00		
FED. ROAD DIST. NO.	ILLINOIS		FED. AID PROJECT	

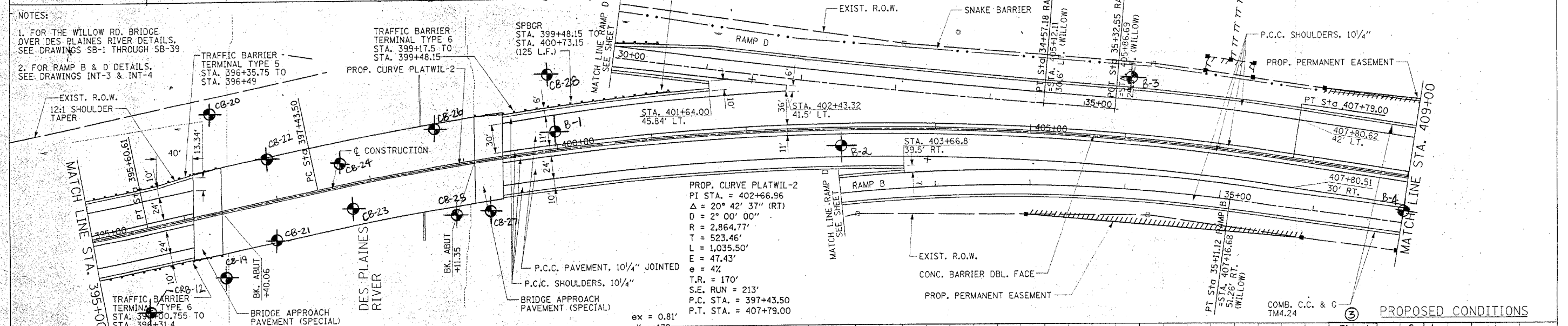
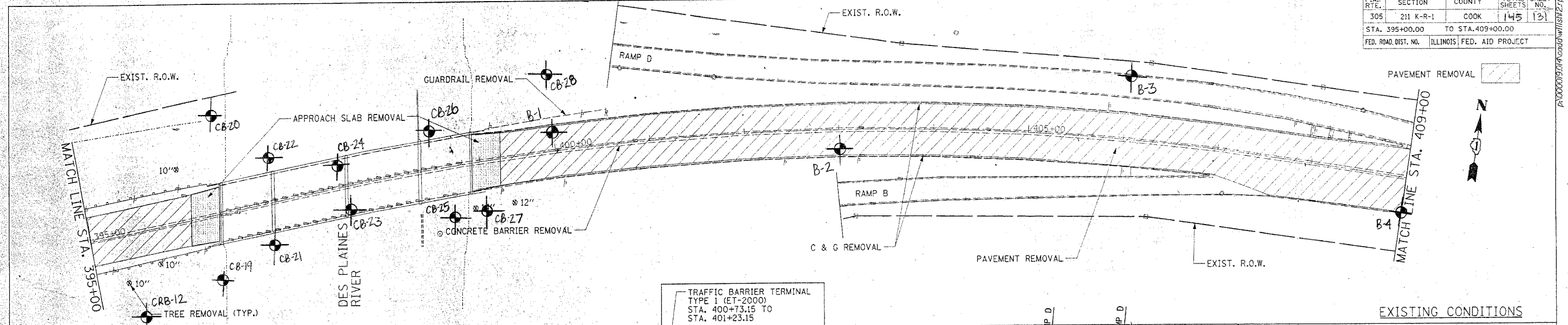

NOTES:
 1. FOR THE WILLOW RD. BRIDGE OVER DES PLAINES RIVER DETAILS, SEE DRAWINGS SB-1 THROUGH SB-39
 2. FOR RAMP B & D DETAILS, SEE DRAWINGS INT-3 & INT-4

PROP. CURVE PLATWIL-2
 PI STA. = 402+66.96
 $\Delta = 20^\circ 42' 37''$ (RT)
 $D = 2^\circ 00' 00''$
 $R = 2,864.77'$
 $T = 523.46'$
 $L = 1,035.50'$
 $E = 47.43'$
 $e = 4\%$
 $T.R. = 170'$
 $S.E. RUN = 213'$
 $P.C. STA. = 397+43.50$
 $P.T. STA. = 407+79.00$

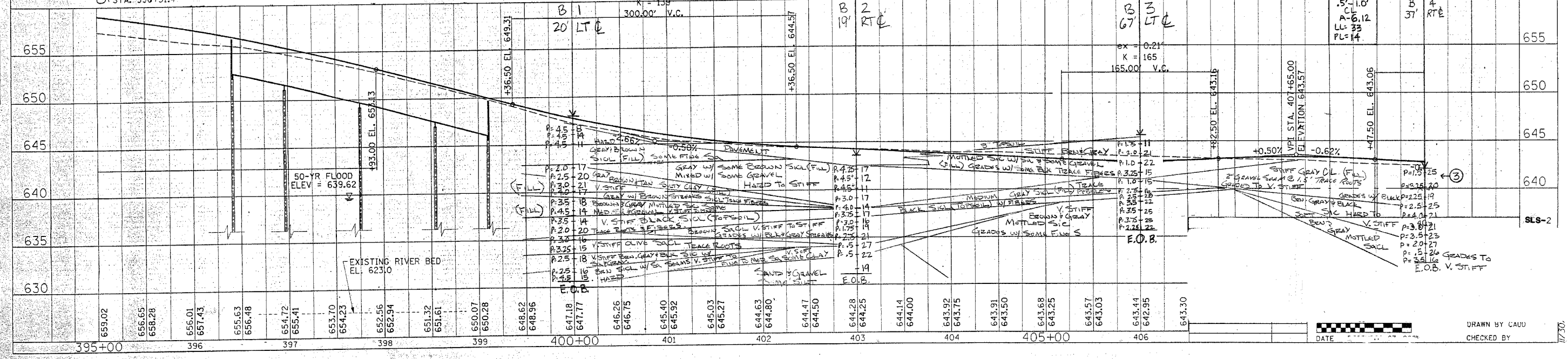

DATE	BY	REVISION

DATE	BY	REVISION

DRAWN BY CAUD
 CHECKED BY
 DATE