

WEST OF SCHOENBECK ROAD

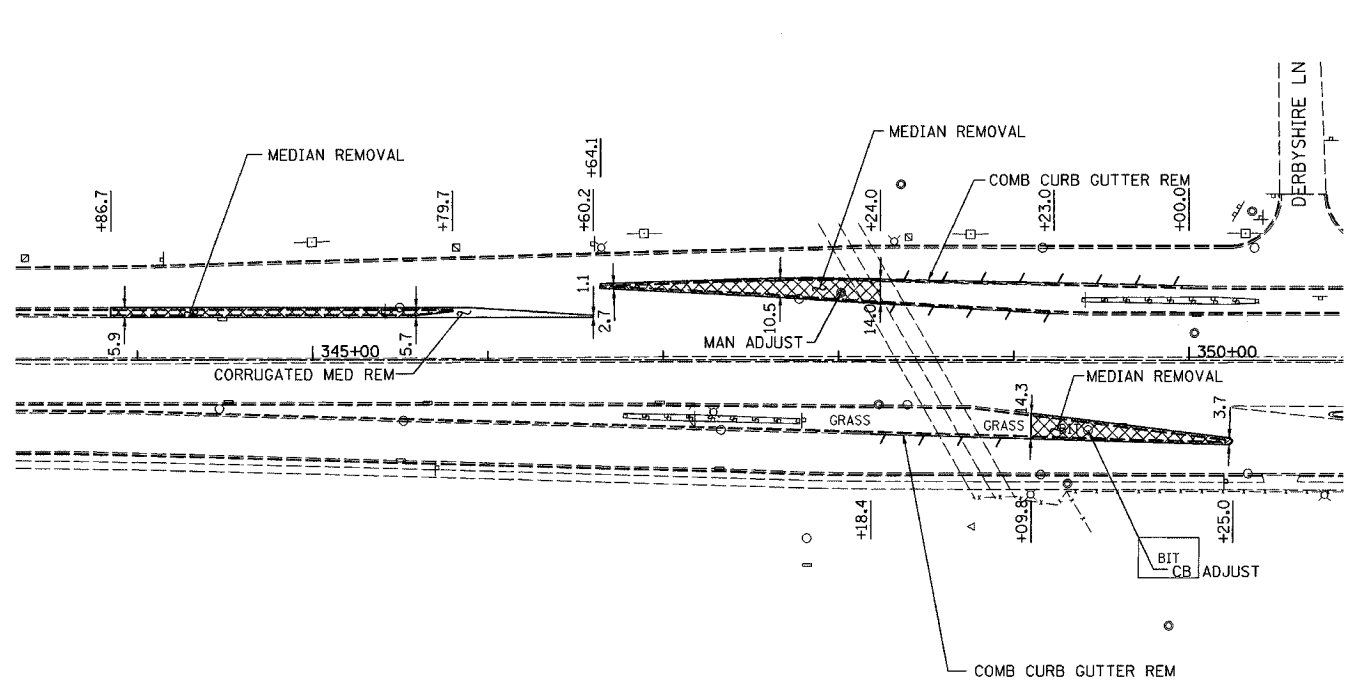

WEST OF IL-83 (ELMHURST ROAD)

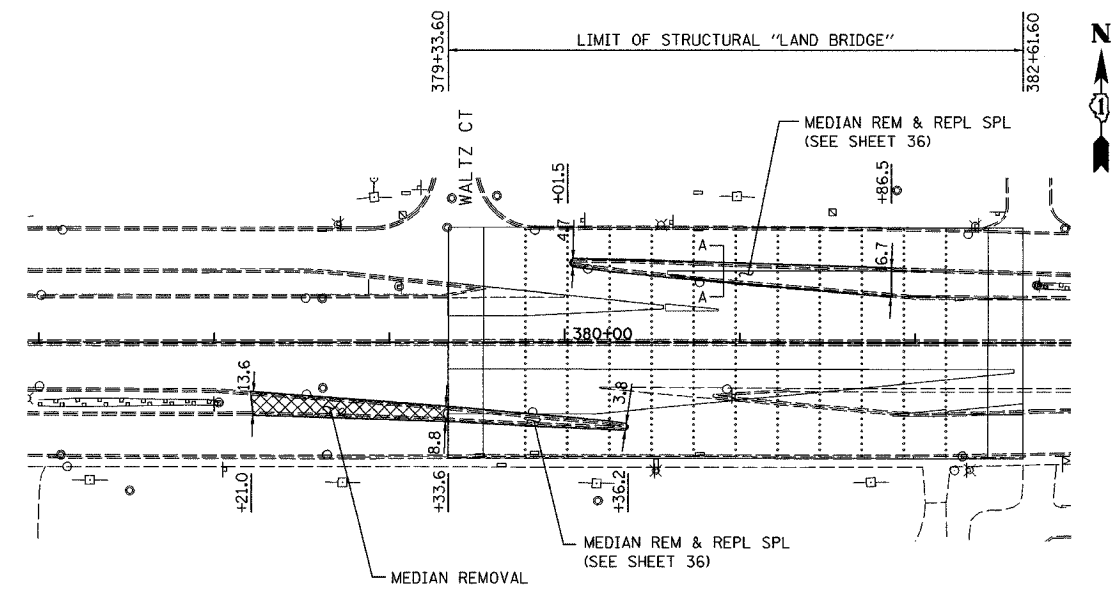

WEST OF WHEELING ROAD

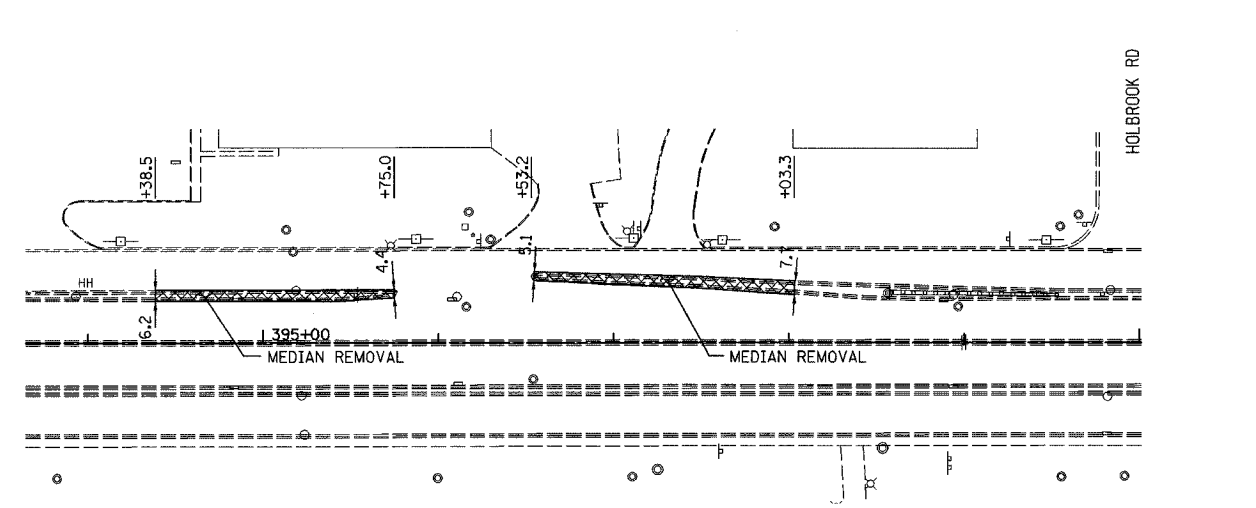

EAST OF WHEELING ROAD

 MEDIAN REMOVAL

- NOTES:
- 1) SAW CUT AT LIMITS OF MEDIAN AND CURB REMOVAL.
  - 2) ALL OPEN AREAS TO BE RESTORED WITH TEMPORARY PAVEMENT PRIOR TO OPENING ADJACENT LANE.

REVISIONS	
NAME	DATE

ILLINOIS DEPARTMENT OF TRANSPORTATION  
PALATINE ROAD OVER IL 83 (ELMHURST RD.)

**PALATINE ROAD  
REMOVAL OF EXISTING MEDIAN**

SCALE: 1/50  
DATE 12/04

DRAWN BY ACE/CAD  
CHECKED BY TAE

**AMERICAN**  
CONSULTING ENGINEERS