

WEST OF SCHOENBECK ROAD

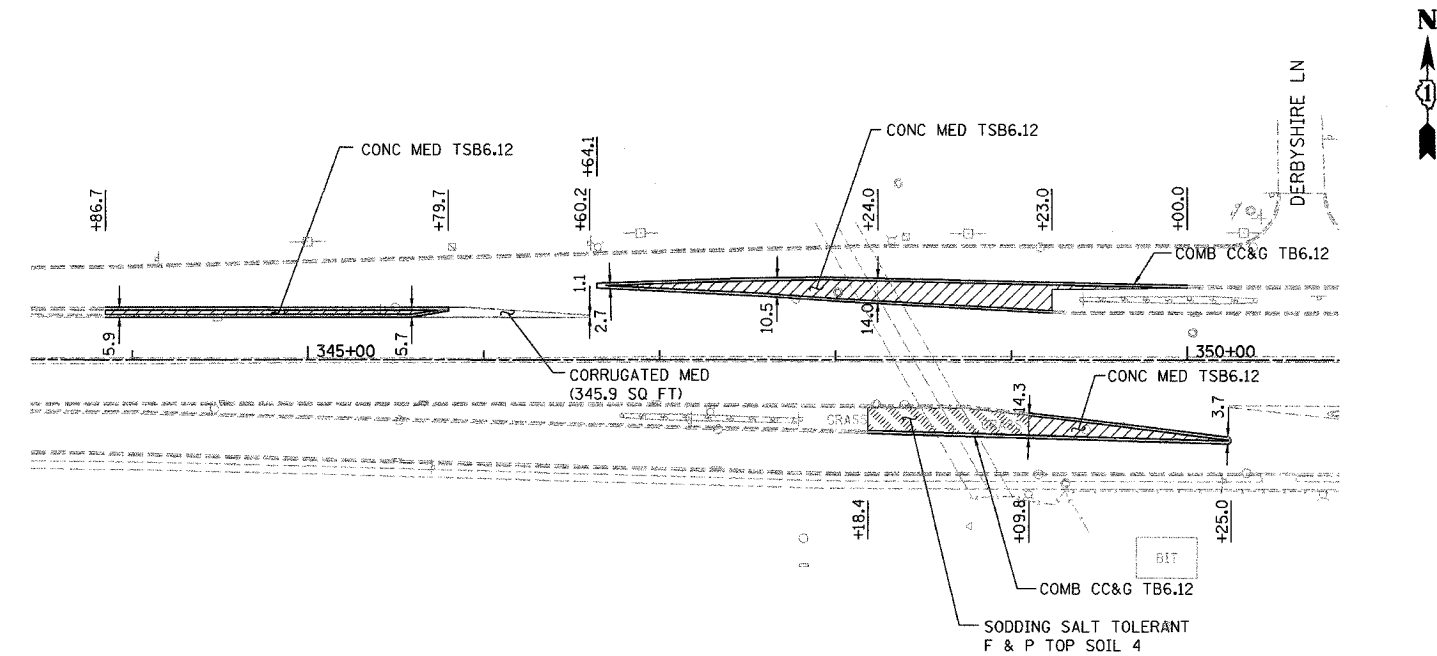

WEST OF IL-83 (ELMHURST ROAD)

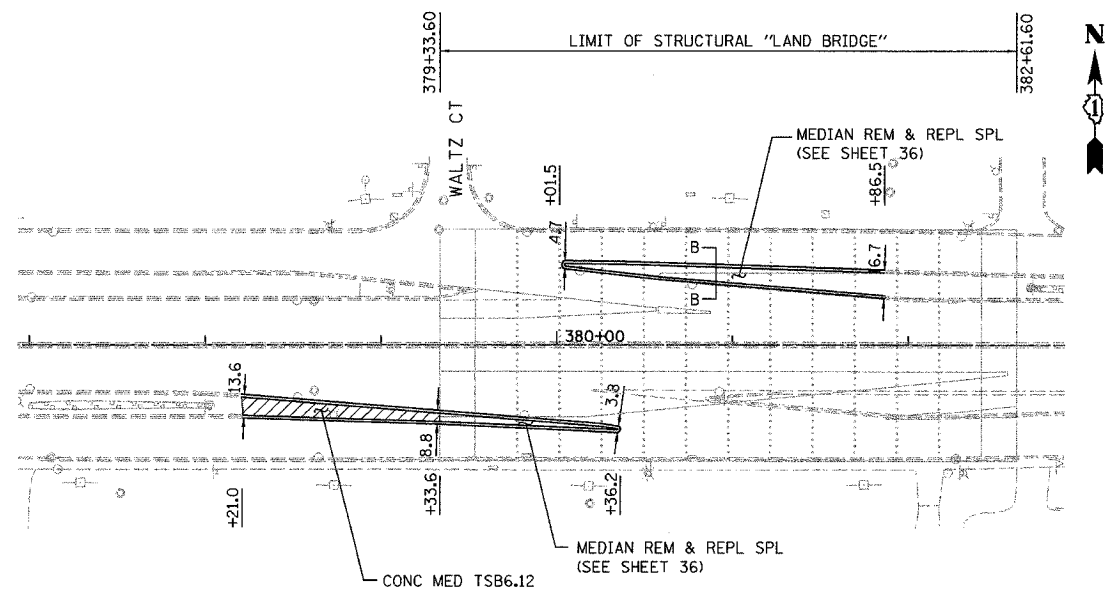

WEST OF WHEELING ROAD

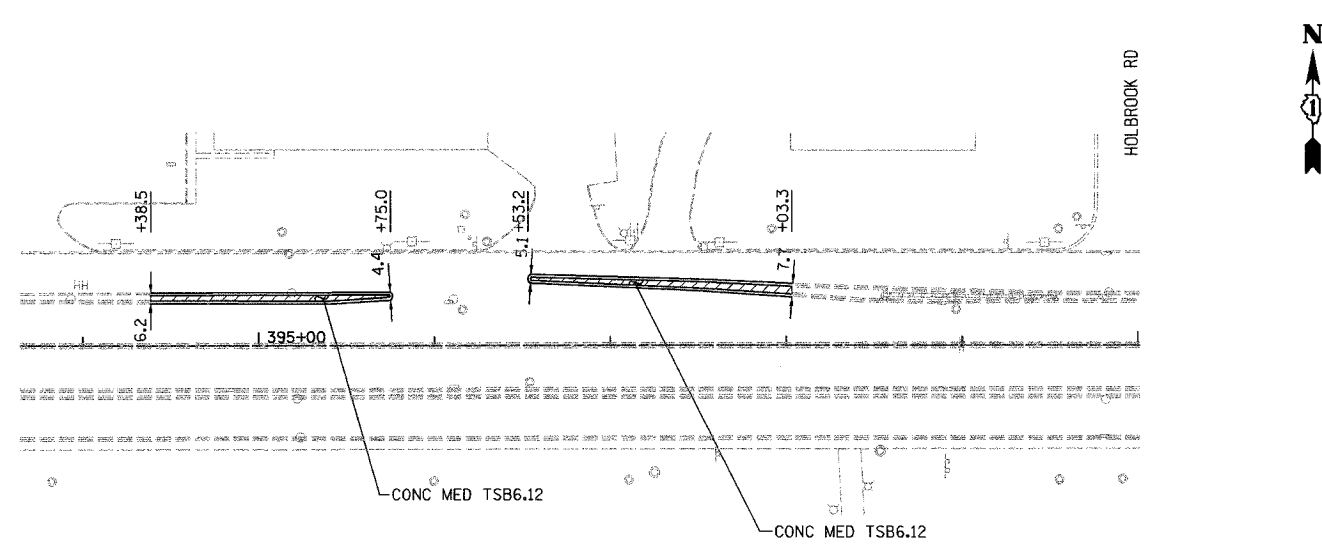

EAST OF WHEELING ROAD

NOTE:
REMOVAL OF TEMPORARY PAVEMENT TO BE PAID
AS PAVEMENT REMOVAL.

CONC MED TSB6.12

REVISIONS	
NAME	DATE

ILLINOIS DEPARTMENT OF TRANSPORTATION
PALATINE ROAD OVER IL 83 (ELMHURST RD.)

**PALATINE ROAD
PROPOSED MEDIAN RESTORATION**

SCALE: 1:50
DATE 12/04

DRAWN BY ACE/CAD
CHECKED BY TAE

AMERICAN
CONSULTING ENGINEERS