

F.A.P. RTE.	SECTION	COUNTY	TOTAL SHEETS	SHEET NO.
305	1313.1 B	COOK	193	95

CONTRACT NO. 62878

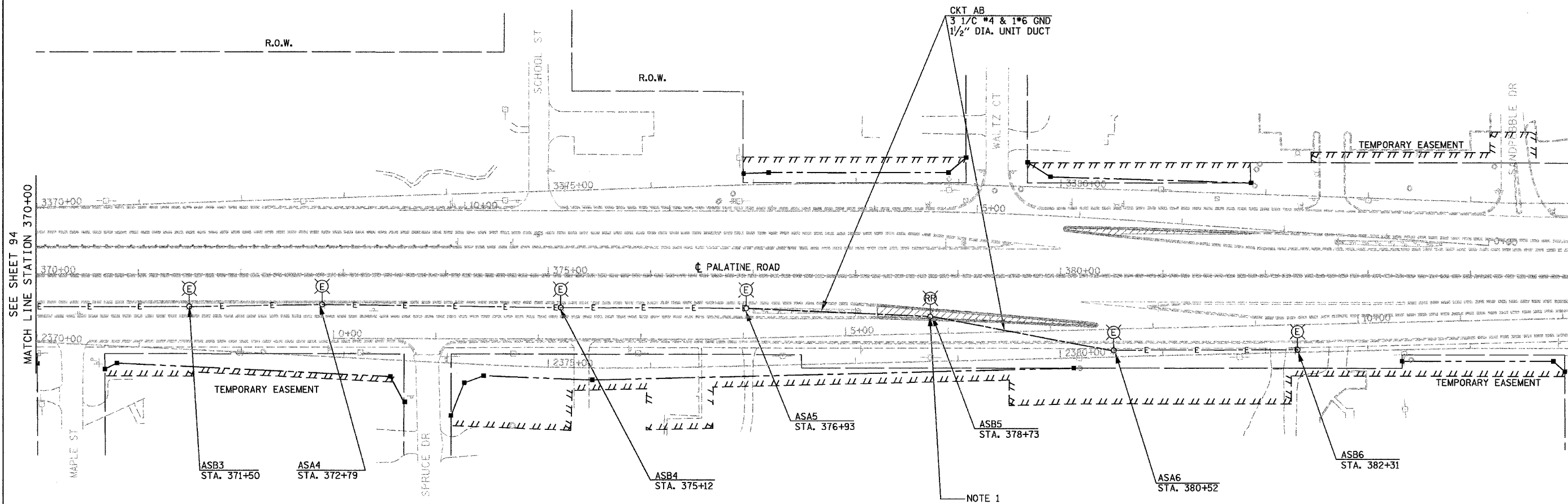

SEE SHEET 94  
MATCH LINE STATION 370+00

NOTE 1. THIS POLE IS RELOCATED ON SAME LOCATION AS EXPLAINED IN REMOVAL PLANS SHEET NO. 98. AND LABELED AS "ASB5" AS SHOWN IN THE PLAN.

**GO** GANDHI AND ASSOCIATES, INC.  
ENGINEERS AND PLANNERS  
8035 N. NORTHWEST HIGHWAY  
SUITE 305  
CHICAGO, ILLINOIS 60631 TEL. (773) 774-5910

REVISIONS	
NAME	DATE

ILLINOIS DEPARTMENT OF TRANSPORTATION  
PALATINE ROAD OVER IL 83 (ELMHURST RD.)  
**PALATINE ROAD PROPOSED LIGHTING**  
SHEET 3 OF 3  
STA. 370+00 TO STA. 385+00

SCALE: 1" = 50'  
DATE: 12/21/2004

DRAWN BY: MAE/KCP  
CHECKED BY: PKG/BC

**AMERICAN**  
CONSULTING ENGINEERS