

STATE OF ILLINOIS
DEPARTMENT OF PUBLIC WORKS & BUILDINGS
DIVISION OF HIGHWAYS

ROUTE NO.	SECTION	COUNTY	TOTAL SHEETS	SHEET NO.	SHEET NO. 1
19VE-1, 19E-1	STEPHENSON	ILLINOIS	57	40	8 SHEETS
19VB-1, 19B-1					

B.P. Spike and washer in roof of 30" tree 300' E. Station 56+80 Elev. 753.97

No Existing Structure

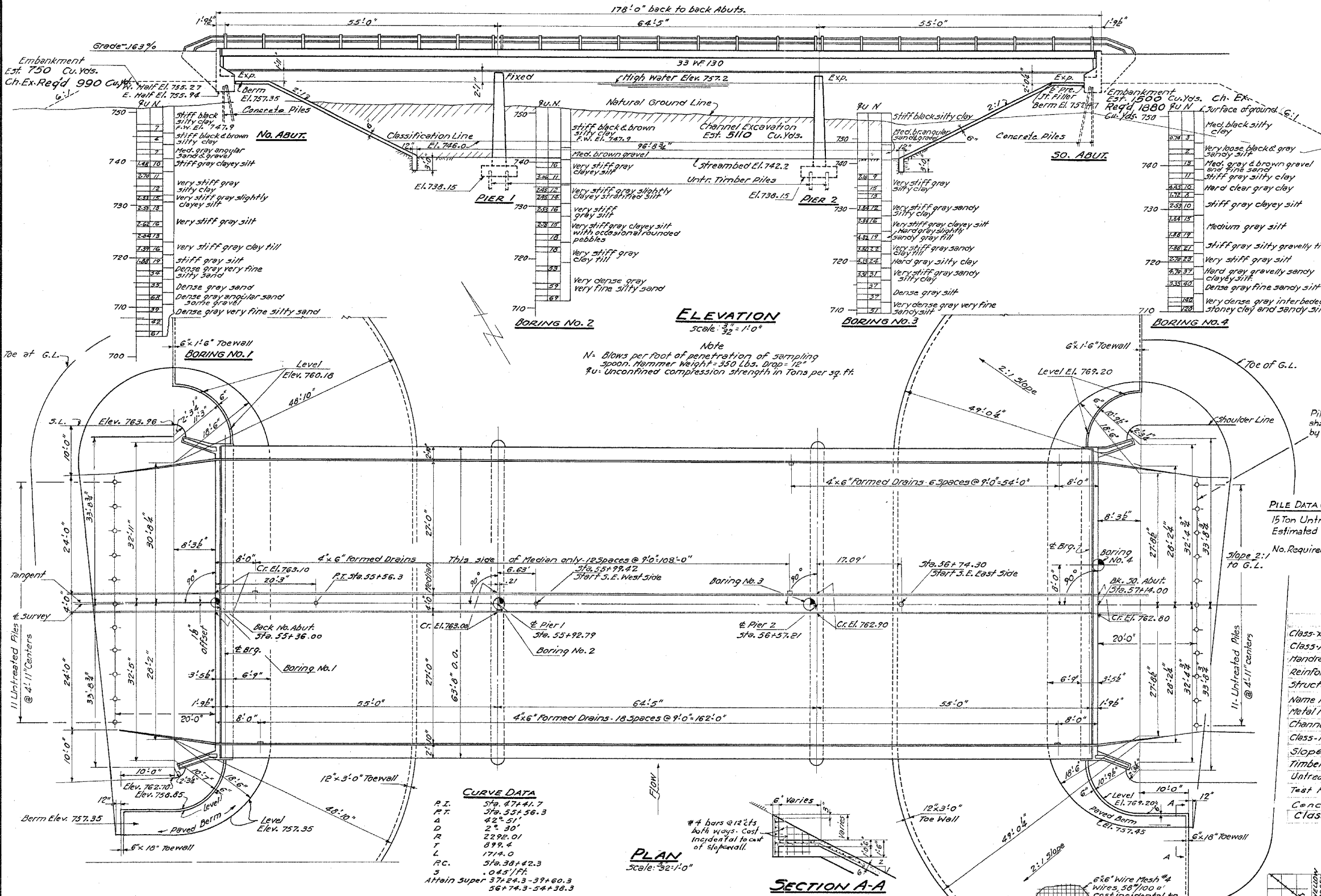

GENERAL NOTES

Class-X Concrete shall be used throughout except for end posts and piers.
Class-A Concrete shall be used in the piers.
Handrail Concrete shall be used in the end post above line shown on Sheet 4.
The concrete floor slab shall be finished in accordance with Art. 51.18 (a) of the Standard Specifications.
Rivets & Open Holes, unless noted, Subpunch 1/8" and ream to size of hole or drill to size.
Field connections riveted unless noted.
All rollers, rockers, bearing plates, lead plates, pintles and anchor bolts shall be fabricated and set in accordance with Art. 51.14 of the Standard Specifications and are included for payment as Structural Steel. Estimated Weight 1720 Lbs.
Anchor Bolts shall be set before riveting the diaphragms over abutments and piers.
All beams shall be assembled to their proper grade and alignment, with or without diaphragms, inspected and reamed while so assembled.
All Structural Steel shall be inspected by the Illinois Division of Highways before painting. All rail posts shall be vertical.
Railing shall be paid for as Metal Handrail, lineal feet, and shall be the horizontal distance measured from face to face of end posts.
Floor slab shall be poured in one continuous operation between the limits of construction joints.
Anchor assemblies in contact with concrete shall not be painted.
Expansion Guards shall be given two shop coats of red lead paint except for anchor straps which shall not be painted.
Except as otherwise provided all Structural Steel and Metal Handrail shall be given one shop coat of red lead paint and two field coats of aluminum paint. All paint shall be furnished and applied by the Contractor involved.
Channel Excavation shall be made by the Bridge Contractor within the limits shown in elevation and 80 ft. each side of center line at right angles to the bridge. It shall be used to make the embankments at the ends of the bridge and the remainder disposed of within R.O.W. limits as directed by the Engineer.
Boring Data are given only as a guide to bidders in estimating soil conditions which may be encountered in the work.
The Contractor for Sec. 19B1 shall drive one concrete test pile at the No. Abut. and one timber test pile at pier 2 in a permanent location as directed by the Engineer before ordering piling. Layout of slope wall may be varied to suit ground conditions in the field as directed by the Engineer.

ELEVATION
Scale: 3/32" = 1'-0"

Note
N = Blows per foot of penetration of sampling spoon. Hammer Weight = 350 Lbs. Drop = 12"
qu = Unconfined compression strength in Tons per sq. ft.

PILE DATA (Approach Slab Bent)

15 Ton Untreated Piles
Estimated length = 35 Ft.
No. Required: 11 at No. Abut., 11 at So. Abut.

TOTAL BILL OF MATERIAL

ITEM	SUPERSTR.	SUBSTR.	SEC. 19-B1	SEC. 19-F1
Class-X Concrete	Cu. Yds.	292.9	79.0	371.9
Class-A Concrete	Cu. Yds.		342.4	342.4
Handrail Concrete	Cu. Yds.	1.8		1.8
Reinforcement Bars	Lbs.	5120	19090	70210
Structural Steel	Lbs.	335050		335050
Name Plates	Each	1		1
Metal Handrail	Lin. Ft.	355		355
Channel Excavation	Cu. Yds.		5110	
Class-A Excavation for Struct	Cu. Yds.		100	100
Slope Wall	Sq. Yds.		1775	1775
Timber Test Piles	Each		1	1
Untreated Piles	Lin. Ft.		2510	2510
Test Piles (Concrete)	Each		1	1
Concrete Piles	Lin. Ft.		874	874
Class B Excavation for Struct.	Cu. Yds.		250	250

CURVE DATA

R.T.	Sta. 47+41.7
P.T.	Sta. 53+56.3
A	42° 30'
R	2292.01
T	899.4
L	1714.0
P.C.	Sta. 38+42.3
S	.045/ft.
Attain Super	37+24.3 - 39+60.3
	56+74.3 - 54+38.3

WATERWAY INFORMATION

Drainage Area	120,000 Acres
Character	Rolling-Cultivated
Opening Regd.	1800 Sq. Ft. (3 1/2' Flood)
Present Opening	1500 Sq. Ft. (I.C.R.R. Br.)
Proposed Opening	1800 Sq. Ft.

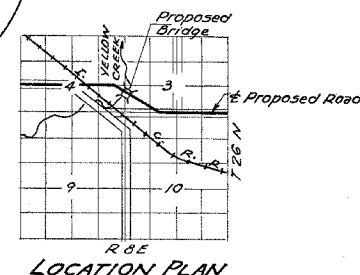

DESIGNED: *M.H. Klab*
CHECKED: *W.T. Sommer*
DRAWN: *M. Miller*
CHECKED: *W.M.*

EXAMINED: *V.M. Rovine*
PASSED: *[Signature]*
APPROVED: *R.H. [Signature]*

Mar. 2 1955

PROJ. F-19(4)
GENERAL PLAN & ELEVATION
S.B.I. ROUTE 5 - SEC. 19-B1
STEPHENSON COUNTY
STATION 56+25

EXISTING BRIDGE PLANS

Revised 3-28-55 - W.M. - Piles for approach slab bents added.
Revised 1-5-56 - P.I. - C:1 slopes indicated on highway side of embankments in ELEVATION