

STATE OF ILLINOIS
DEPARTMENT OF TRANSPORTATION

Sheet No. 4
of 11 Sheets

ROUTE NO.	SECTION	COUNTY	TOTAL SHEETS	SHEET NO.
FAS 1197	105BR-2	WHITESIDE	59	19
FEDERAL DIST. NO.	ILLINOIS	PROJECT	CONTRACT 64421	

*Order a(E) bars full length
Cut to fit skew and use
remainder in opposite end
(See Bar Cutting Diagram)

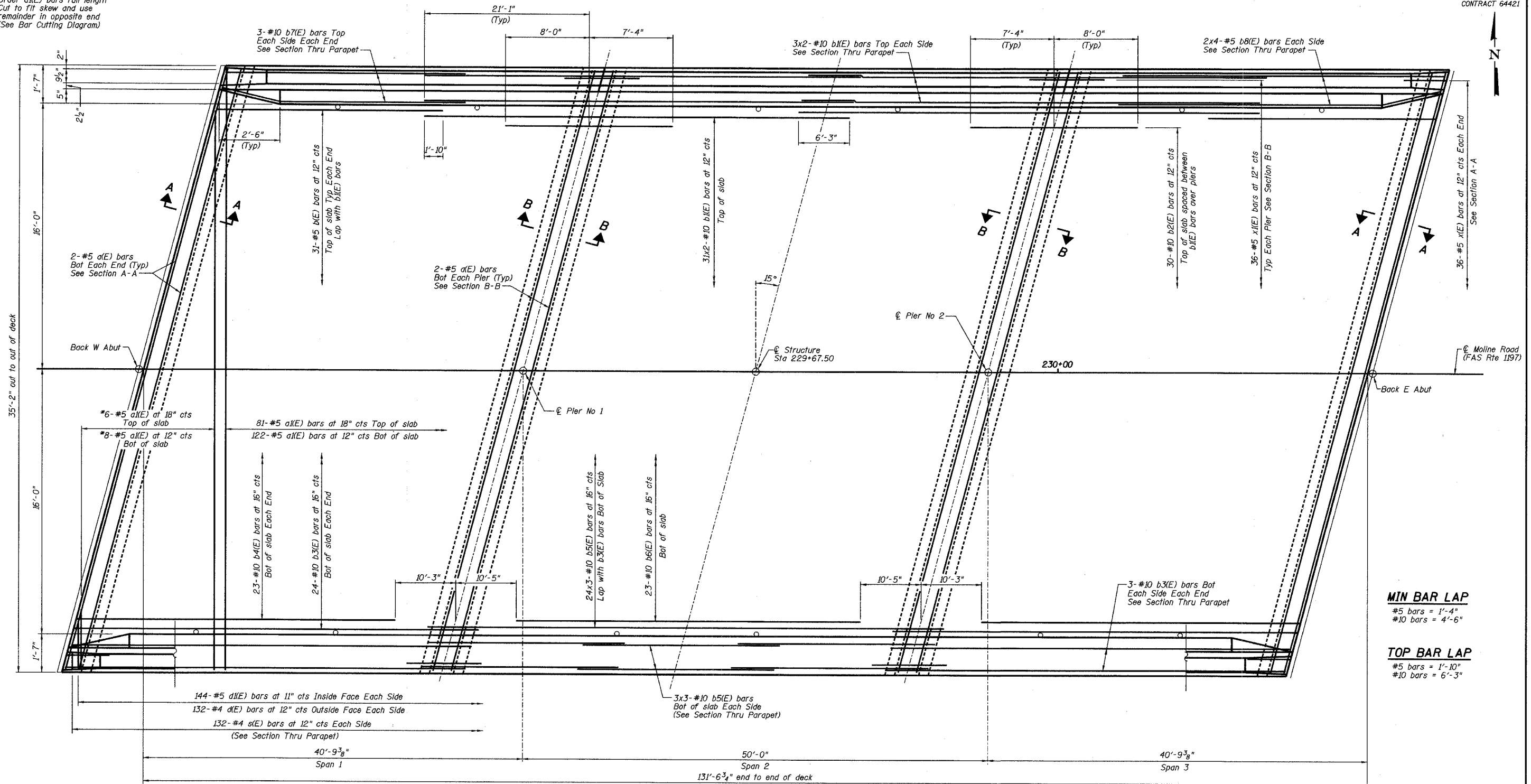

MIN BAR LAP
#5 bars = 1'-4"
#10 bars = 4'-6"

TOP BAR LAP
#5 bars = 1'-10"
#10 bars = 6'-3"

PLAN

NOTES:

See Sheet No. 6 of 11 for Superstructure Details, parapet reinforcing and Bill of Material.
Reinforcement bars designated (E) shall be epoxy coated.
Bars indicated thus 6x3-#5 etc indicates 6 lines of bars with 3 lengths per line.
See Sheet No. 1 of 11 for floor drain spacing.
Space reinforcement bars to clear floor drains.

REVISIONS		SUPERSTRUCTURE PLAN		DRAWN BY DATE	
No.	DATE	INITIALS	MOLINE ROAD OVER UNNAMED TRIBUTARY TO ROCK RIVER		R King 8/04
1			FAS ROUTE 1197 SECTION 105BR-2		CHECKED BY DATE
2			SN 098-0110		CMV 8/04
3			STA 229+67.50 WHITESIDE COUNTY		DATE BY DATE
4			HOMER L. CHASTAIN & ASSOCIATES, LLP		CWC 8/04
5			CONSULTING ENGINEERS		BOOK NUMBER
6			184-001397		PROJECT No.
7					4858-3
8					SHEET No.
9					
10					
11					
12					