

F.A. RTE.	SECTION	COUNTY	TOTAL SHEETS	SHEET NO.
••	••	WINNEBAGO	317	76
STA.		TO STA.		
FED. ROAD DIST. NO.	ILLINOIS	FED. AID PROJECT		

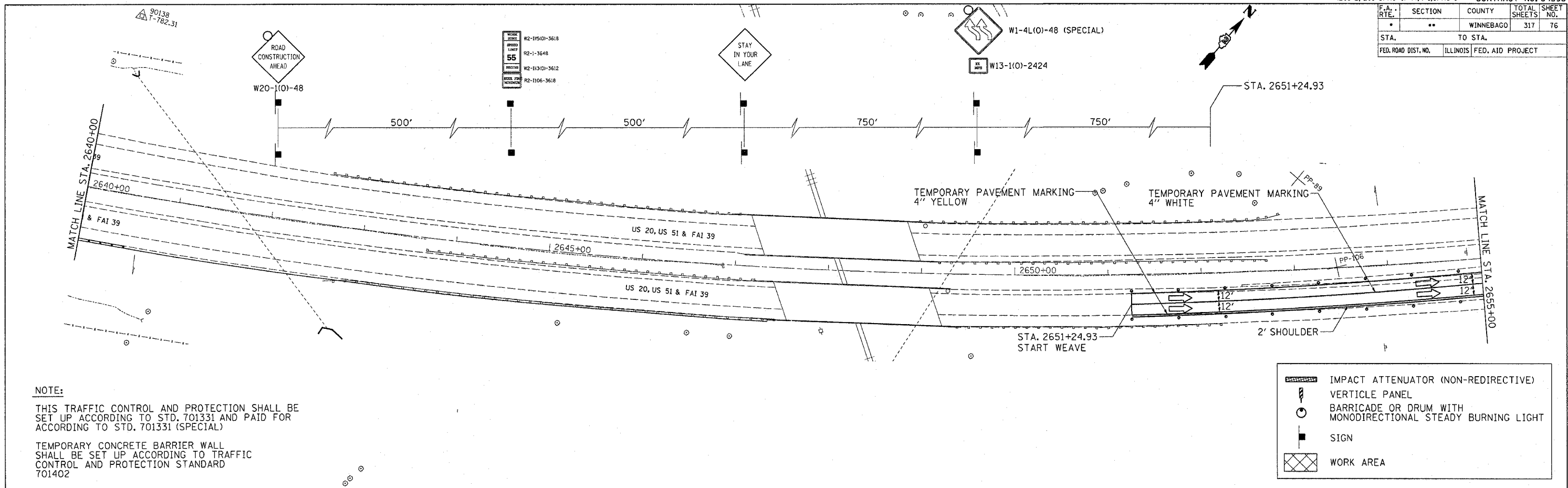

NOTE:
 THIS TRAFFIC CONTROL AND PROTECTION SHALL BE SET UP ACCORDING TO STD. 701331 AND PAID FOR ACCORDING TO STD. 701331 (SPECIAL)

TEMPORARY CONCRETE BARRIER WALL SHALL BE SET UP ACCORDING TO TRAFFIC CONTROL AND PROTECTION STANDARD 701402

	IMPACT ATTENUATOR (NON-REDIRECTIVE)
	VERTICLE PANEL
	BARRICADE OR DRUM WITH MONODIRECTIONAL STEADY BURNING LIGHT
	SIGN
	WORK AREA

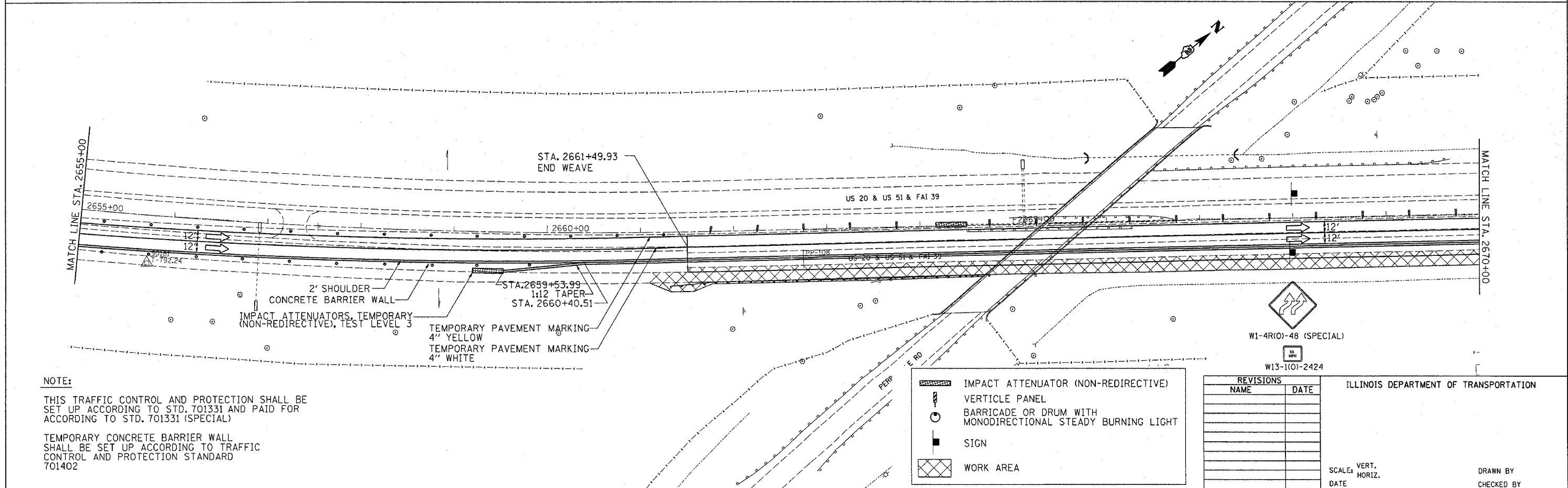

NOTE:
 THIS TRAFFIC CONTROL AND PROTECTION SHALL BE SET UP ACCORDING TO STD. 701331 AND PAID FOR ACCORDING TO STD. 701331 (SPECIAL)

TEMPORARY CONCRETE BARRIER WALL SHALL BE SET UP ACCORDING TO TRAFFIC CONTROL AND PROTECTION STANDARD 701402

	IMPACT ATTENUATOR (NON-REDIRECTIVE)
	VERTICLE PANEL
	BARRICADE OR DRUM WITH MONODIRECTIONAL STEADY BURNING LIGHT
	SIGN
	WORK AREA

REVISIONS	
NAME	DATE

ILLINOIS DEPARTMENT OF TRANSPORTATION

SCALE: VERT. _____
 HORIZ. _____
 DATE _____

DRAWN BY _____
 CHECKED BY _____

PLOT DATE = Thu Dec 23 09:54:28 2004
 FILE NAME = c:\projects\2012500\2012500.dwg
 PLOT SCALE = 5/8" = 1'