

F.A. RTE.	SECTION	COUNTY	TOTAL SHEETS	SHEET NO.
•	••	WINNEBAGO	317	77
STA.		TO STA.		
FED. ROAD DIST. NO.		ILLINOIS FED. AID PROJECT		

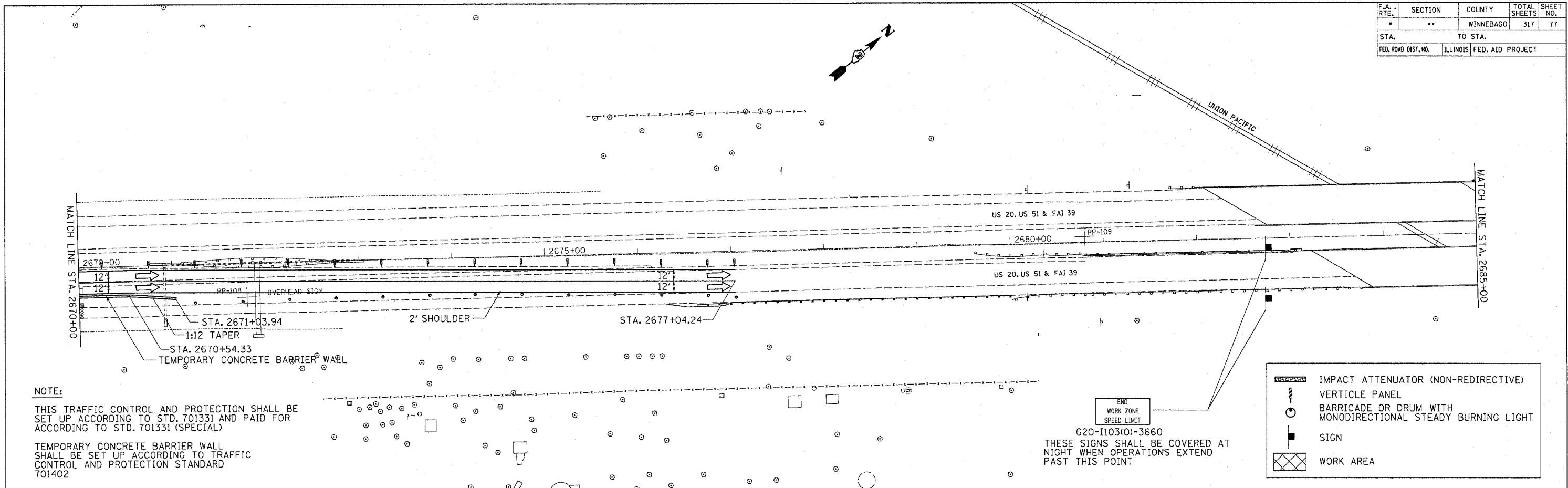

NOTE:
 THIS TRAFFIC CONTROL AND PROTECTION SHALL BE SET UP ACCORDING TO STD. 701331 AND PAID FOR ACCORDING TO STD. 701331 (SPECIAL)
 TEMPORARY CONCRETE BARRIER WALL SHALL BE SET UP ACCORDING TO TRAFFIC CONTROL AND PROTECTION STANDARD 701402

END WORK ZONE SPEED LIMIT
 G20-I103(O)-3660
 THESE SIGNS SHALL BE COVERED AT NIGHT WHEN OPERATIONS EXTEND PAST THIS POINT

	IMPACT ATTENUATOR (NON-REDIRECTIVE)
	VERTICLE PANEL
	BARRICADE OR DRUM WITH MONODIRECTIONAL STEADY BURNING LIGHT
	SIGN
	WORK AREA

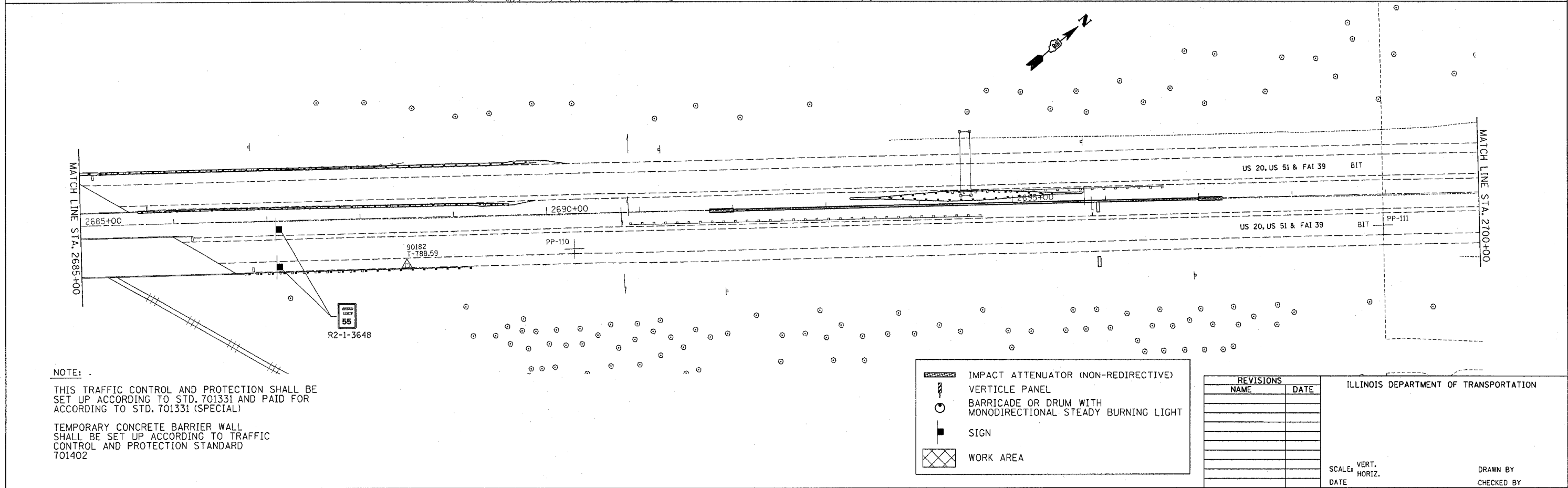

NOTE:
 THIS TRAFFIC CONTROL AND PROTECTION SHALL BE SET UP ACCORDING TO STD. 701331 AND PAID FOR ACCORDING TO STD. 701331 (SPECIAL)
 TEMPORARY CONCRETE BARRIER WALL SHALL BE SET UP ACCORDING TO TRAFFIC CONTROL AND PROTECTION STANDARD 701402

	IMPACT ATTENUATOR (NON-REDIRECTIVE)
	VERTICLE PANEL
	BARRICADE OR DRUM WITH MONODIRECTIONAL STEADY BURNING LIGHT
	SIGN
	WORK AREA

REVISIONS	
NAME	DATE

ILLINOIS DEPARTMENT OF TRANSPORTATION
 SCALE: VERT. / HORIZ.
 DATE
 DRAWN BY / CHECKED BY

PLOT DATE = Thu Dec 23 09:54:29 2004
 FILE NAME = c:\projects\6212588\6212588.dgn
 PLOT SCALE = 5/8" = 1'