

F.A. RTE.	SECTION	COUNTY	TOTAL SHEETS	SHEET NO.
*	**	WINNEBAGO	317	81
STA.		TO STA.		
FED. ROAD DIST. NO.		ILLINOIS FED. AID PROJECT		

DETOUR ROUTE FOR RAMP AD CLOSURE

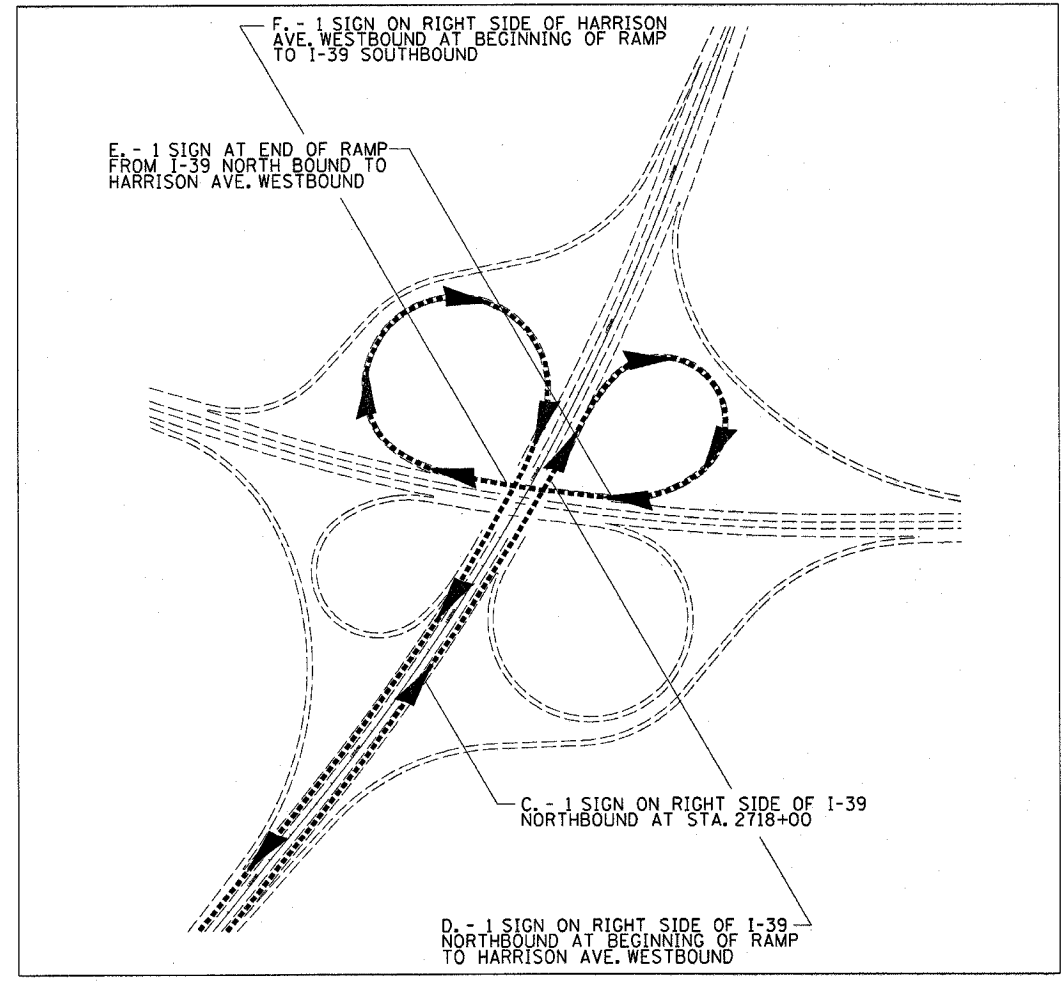

- C.-
 - 24" X 12" ORANGE - M4-8
 - 24" X 12" BLUE - M3-3
 - 24" X 24" BLUE - M1-1
 - 21" X 15" ORANGE - M5-2R
- D.-
 - 24" X 12" ORANGE - M4-8
 - 24" X 12" BLUE - M3-3
 - 24" X 24" BLUE - M1-1
 - 21" X 15" ORANGE - M6-2R
- E.-
 - 24" X 12" ORANGE - M4-8
 - 24" X 12" BLUE - M3-3
 - 24" X 24" BLUE - M1-1
 - 21" X 15" ORANGE - M5-2R
- F.-
 - 24" X 12" ORANGE - M4-8
 - 24" X 12" BLUE - M3-3
 - 24" X 24" BLUE - M1-1
 - 21" X 15" ORANGE - M6-2R

- B. - 2 SIGNS @ 695+00 AND 700+00 ON BOTH SIDES OF US 20 EASTBOUND
- A. - 2 SIGNS @ 690+00 ON BOTH SIDES OF US 20 EASTBOUND

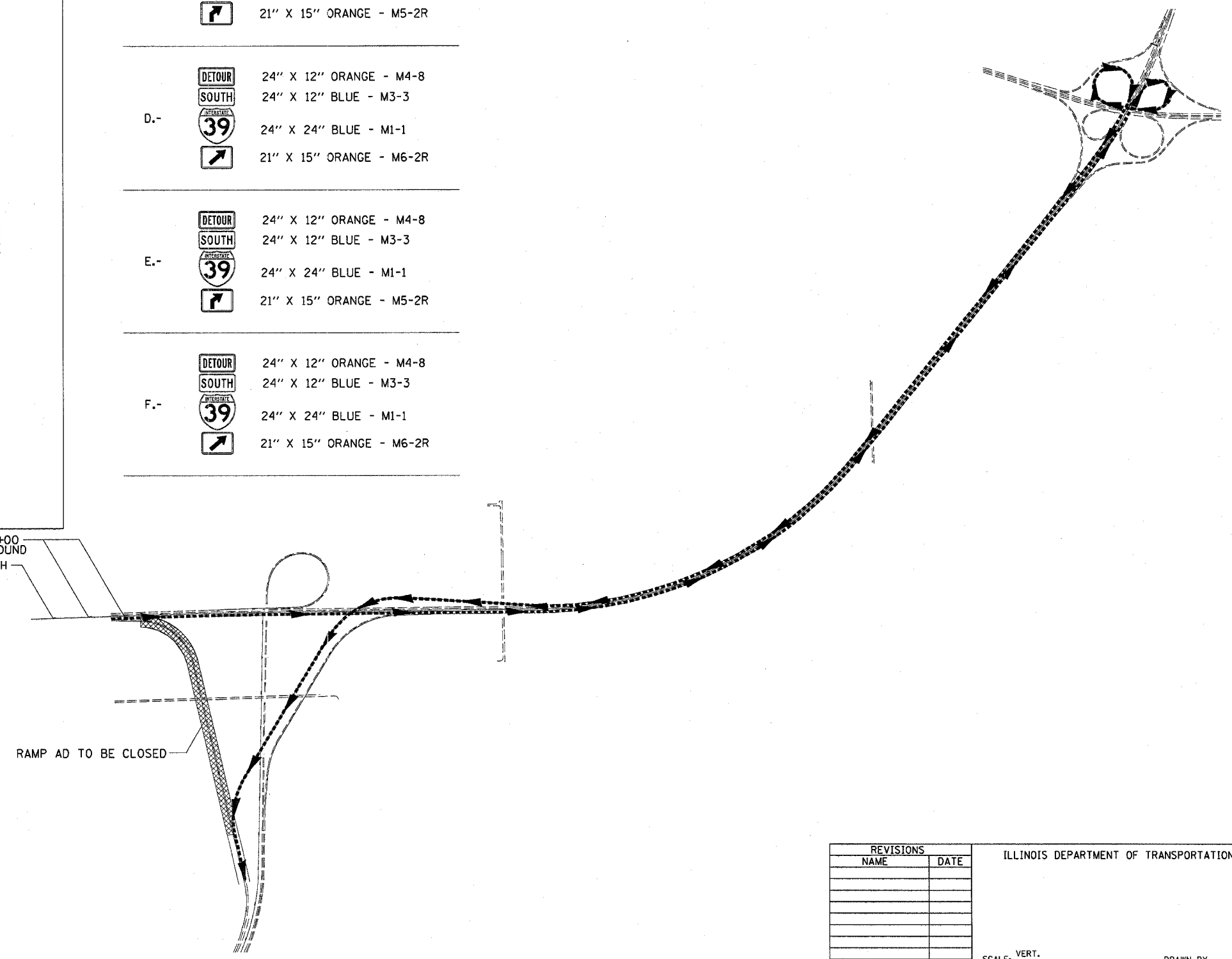

- A.-
 - 48" X 48" ORANGE - W20-2
 - 24" X 12" BLUE - M3-3
 - 24" X 24" BLUE - M1-1
- B.-
 - 24" X 12" ORANGE - M4-8
 - 24" X 12" BLUE - M3-3
 - 24" X 24" BLUE - M1-1
 - 21" X 15" ORANGE - M6-3

REVISIONS	
NAME	DATE

ILLINOIS DEPARTMENT OF TRANSPORTATION

SCALE: VERT. _____
 HORIZ. _____
 DATE _____

DRAWN BY _____
 CHECKED BY _____

PLOT DATE = Thu Dec 23 10:26:51 2004
 FILE NAME = C:\projects\1212508\1212508.dwg
 PLOTTER = HP DesignJet 500 / IN
 REFERENCE = REFERENCE