

F.A.P. RTE.	SECTION	COUNTY	TOTAL SHEETS	SHEET NO.
595	1-3-K	ROCK ISLAND	476	64
STA.		TO STA.		
FED. ROAD DIST. NO.		ILLINOIS FED. AID PROJECT		

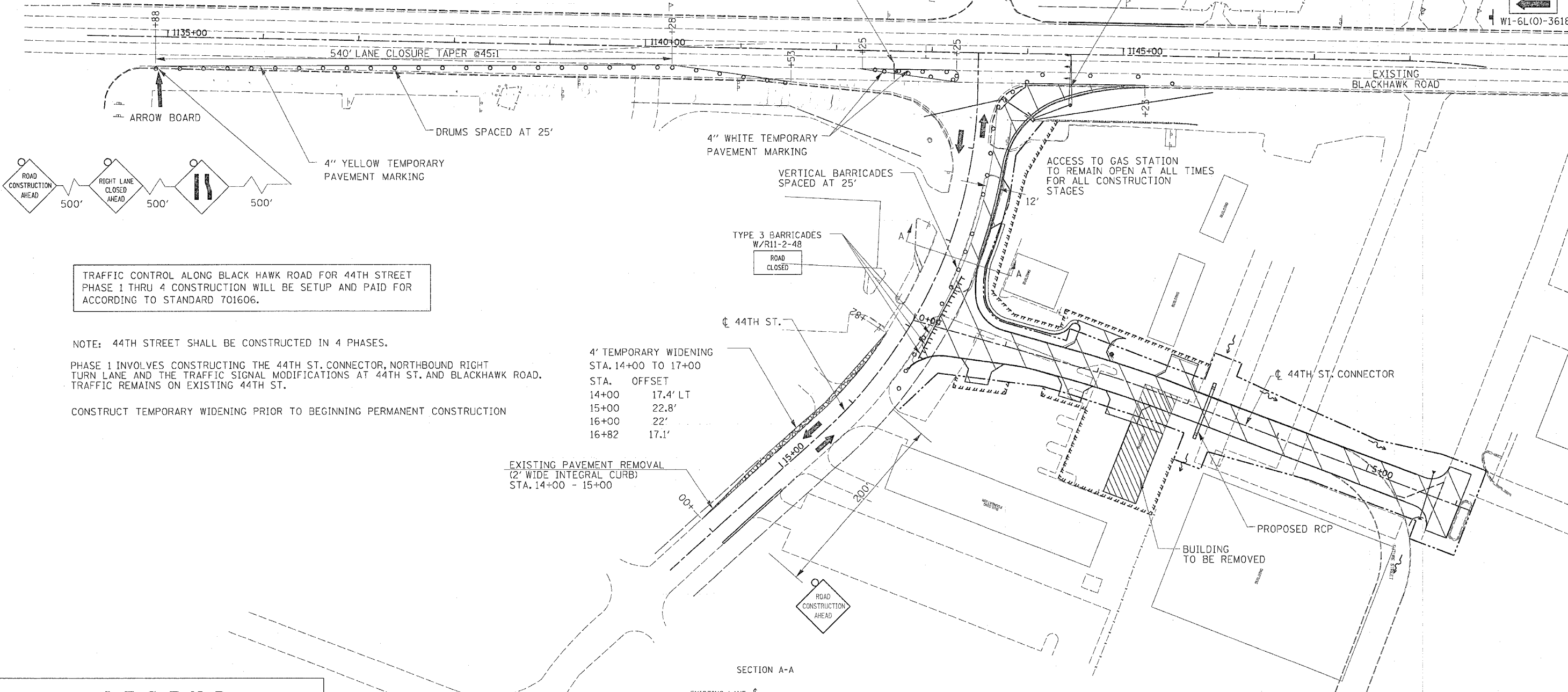

R 3-1100R (24"x24")
M6-2R (21"x15")
RIGHT TURN LANE
PLACE SIGN PER DISTRICT STANDARD 94.2

CONSTRUCT TRAFFIC SIGNAL IMPROVEMENTS TO ALLOW EASTBOUND MAST ARM SIGNALS TO BE OPERATIONAL AT ALL TIMES EXCEPT AN 8-HOUR SWITCHOVER PERIOD.

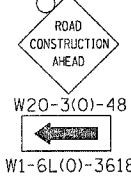

TRAFFIC CONTROL ALONG BLACK HAWK ROAD FOR 44TH STREET PHASE 1 THRU 4 CONSTRUCTION WILL BE SETUP AND PAID FOR ACCORDING TO STANDARD 701606.

NOTE: 44TH STREET SHALL BE CONSTRUCTED IN 4 PHASES.
PHASE 1 INVOLVES CONSTRUCTING THE 44TH ST. CONNECTOR, NORTHBOUND RIGHT TURN LANE AND THE TRAFFIC SIGNAL MODIFICATIONS AT 44TH ST. AND BLACKHAWK ROAD. TRAFFIC REMAINS ON EXISTING 44TH ST.
CONSTRUCT TEMPORARY WIDENING PRIOR TO BEGINNING PERMANENT CONSTRUCTION

4' TEMPORARY WIDENING
STA. 14+00 TO 17+00

STA.	OFFSET
14+00	17.4' LT
15+00	22.8'
16+00	22'
16+82	17.1'

EXISTING PAVEMENT REMOVAL
(2' WIDE INTEGRAL CURB)
STA. 14+00 - 15+00

LEGEND

- NEW CONSTRUCTION
- BARRICADE OR DRUM WITH STEADY BURNING LIGHT
- TRAFFIC FLOW ARROW

