

STATE OF ILLINOIS
DEPARTMENT OF TRANSPORTATION

ROUTE NO.	SECTION	COUNTY	SHEET NO.	SHEET NO.
F.A.P. 595	1-3-K	Rock Island	476	281
FED. ROAD DIST. NO. 7	ILLINOIS	FED. AID PROJECT		

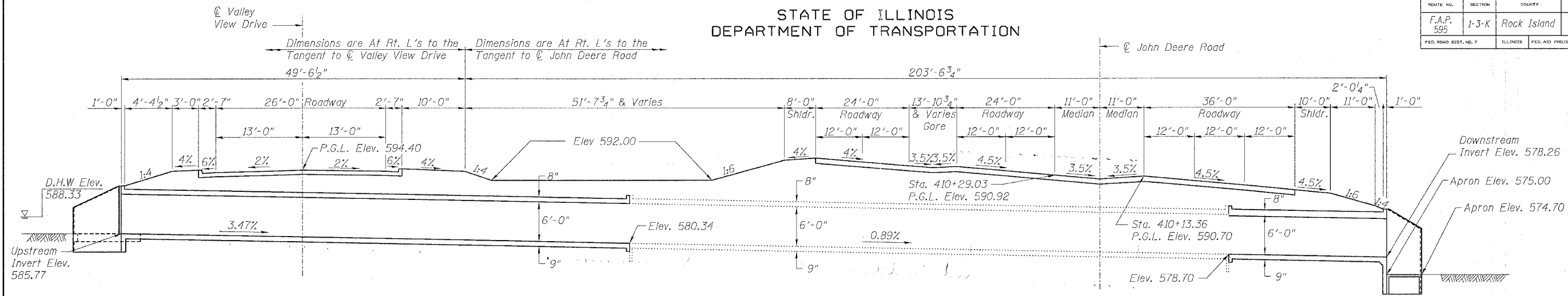

LONGITUDINAL SECTION

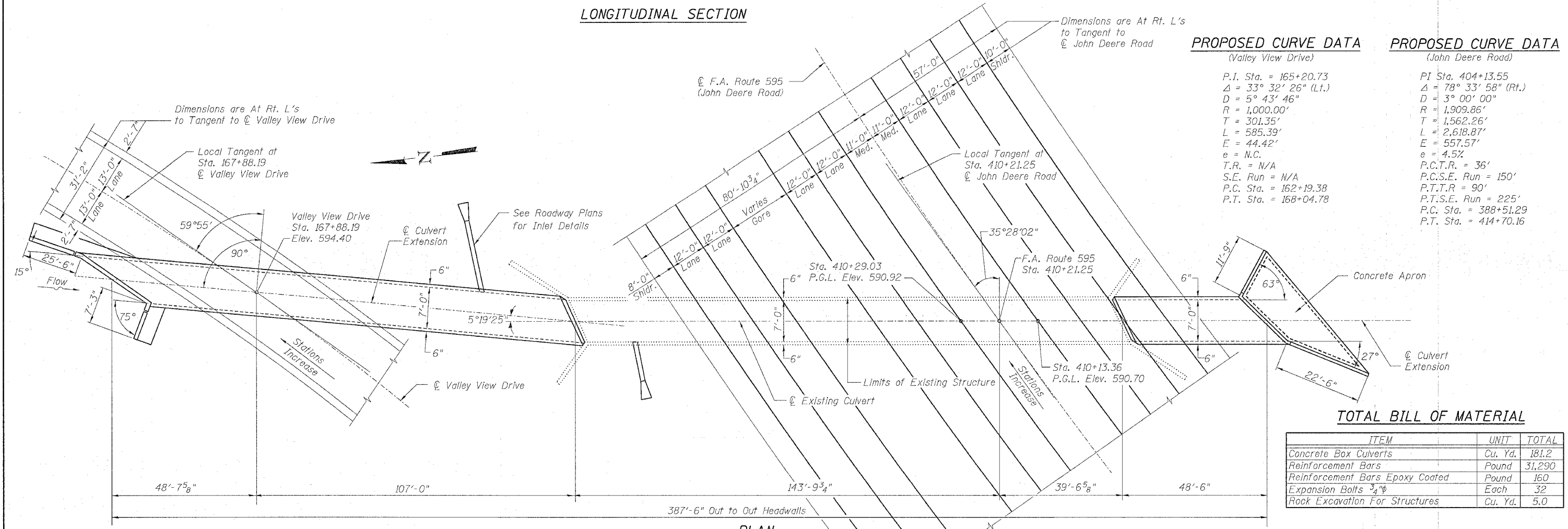

PROPOSED CURVE DATA		PROPOSED CURVE DATA	
(Valley View Drive)		(John Deere Road)	
P.I. Sta. = 165+20.73	PI Sta. = 404+13.55		
Δ = 33° 32' 26" (Lt.)	Δ = 78° 33' 58" (Rt.)		
D = 5° 43' 46"	D = 3° 00' 00"		
R = 1,000.00'	R = 1,909.86'		
T = 301.35'	T = 1,562.26'		
L = 585.39'	L = 2,618.87'		
E = 44.42'	E = 557.57'		
e = N.C.	e = 4.5%		
T.R. = N/A	P.C.T.R. = 36'		
S.E. Run = N/A	P.C.S.E. Run = 150'		
P.C. Sta. = 162+19.38	P.T.T.R. = 90'		
P.T. Sta. = 168+04.78	P.T.S.E. Run = 225'		
	P.C. Sta. = 388+51.29		
	P.T. Sta. = 414+70.16		

TOTAL BILL OF MATERIAL

ITEM	UNIT	TOTAL
Concrete Box Culverts	Cu. Yd.	181.2
Reinforcement Bars	Pound	31,290
Reinforcement Bars Epoxy Coated	Pound	160
Expansion Bolts 3/4"	Each	32
Rock Excavation For Structures	Cu. Yd.	5.0

WATERWAY INFORMATION

Flood	Freq. Yr.	Q C.F.S.	Opening Sq. Ft.		Nat. H.W.F.	Head - Ft.		Headwater El.	
			Exst.	Prop.		Exst.	Prop.	Exst.	Prop.
Design	50	281.6	-	39.8	588.33	-	3.13	-	591.46
Base	100	313.6	-	42.0	588.46	-	3.47	-	591.93
Overtopping	-	-	-	-	-	-	-	-	-
Max. Calc.	500	434	-	-	-	-	-	-	-

500 year Q is estimated

DESIGN STRESSES

FIELD UNITS
f_c = 3,500 psi
f_y = 60,000 psi (Reinforcement)

LOADING HS20-44 & ALT.

DESIGNED	BDF
CHECKED	BDF
DRAWN	RAP
CHECKED	BDF

GENERAL PLAN
MILAN BELTWAY AND JOHN DEERE ROAD
OVER UNNAMED STREAM
FA ROUTE 595 SECTION 1-3-K
ROCK ISLAND COUNTY
STATION 410+21.25 (JOHN DEERE ROAD)
STATION 167+88.19 (VALLEY VIEW DRIVE)