

25/8 64A38

NOTE:
 PARTIAL REMOVAL OF HEDGE IN SOUTH EAST CORNER DUE TO CONSTRUCTION OF THE PROPOSED SIDEWALK IS TO BE CONSIDERED INCLUDED AND NO ADDITIONAL COMPENSATION WILL BE MADE.

SCALES:
 PLAN: 1"=20'
 PROFILE: 1"=20' H
 1"=5' V

- NOTE:
- FOR PAVEMENT STRUCTURE SEE TYPICAL SECTION STA. 5+77 - 6+21.59
 - FOR PAVEMENT STRUCTURE SEE TYPICAL SECTION STA. 6+21.59 - 6+71
 - THERMOPLASTIC PAVEMENT MARKING - LINE 4", YELLOW, 11" C/C WILL END AT STA. 6+71.
 - RAISED REFLECTIVE PAVEMENT MARKERS ARE TO BE REMOVED TO STA. 6+71.
 - BITUMINOUS SURFACE REMOVAL 1-1/2" (STA. 2+08 - 5+91)

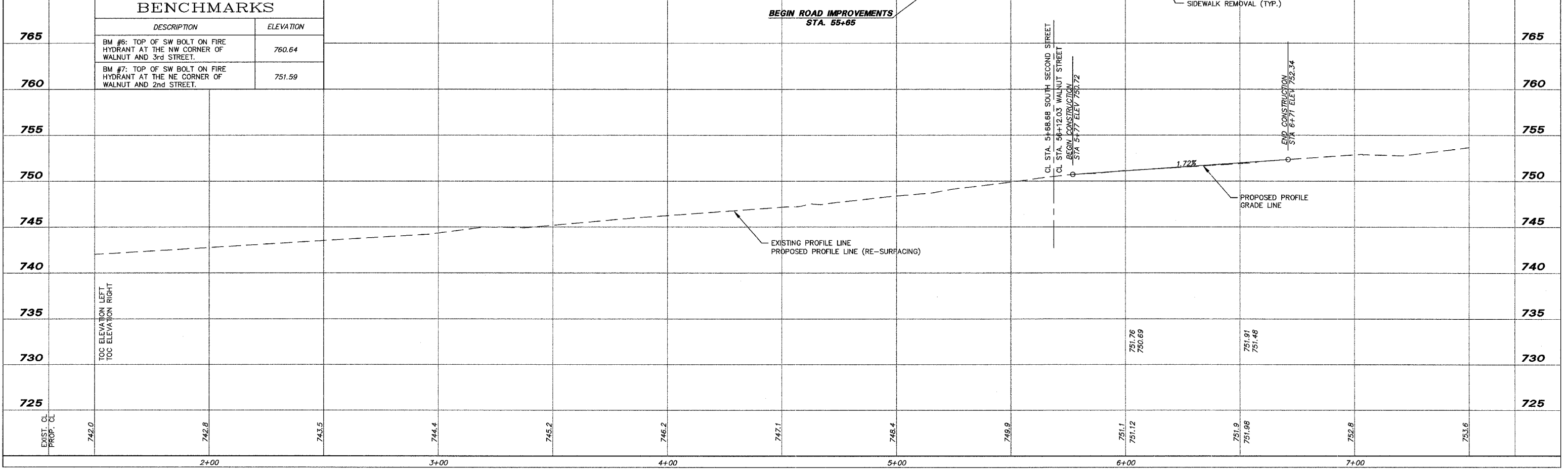
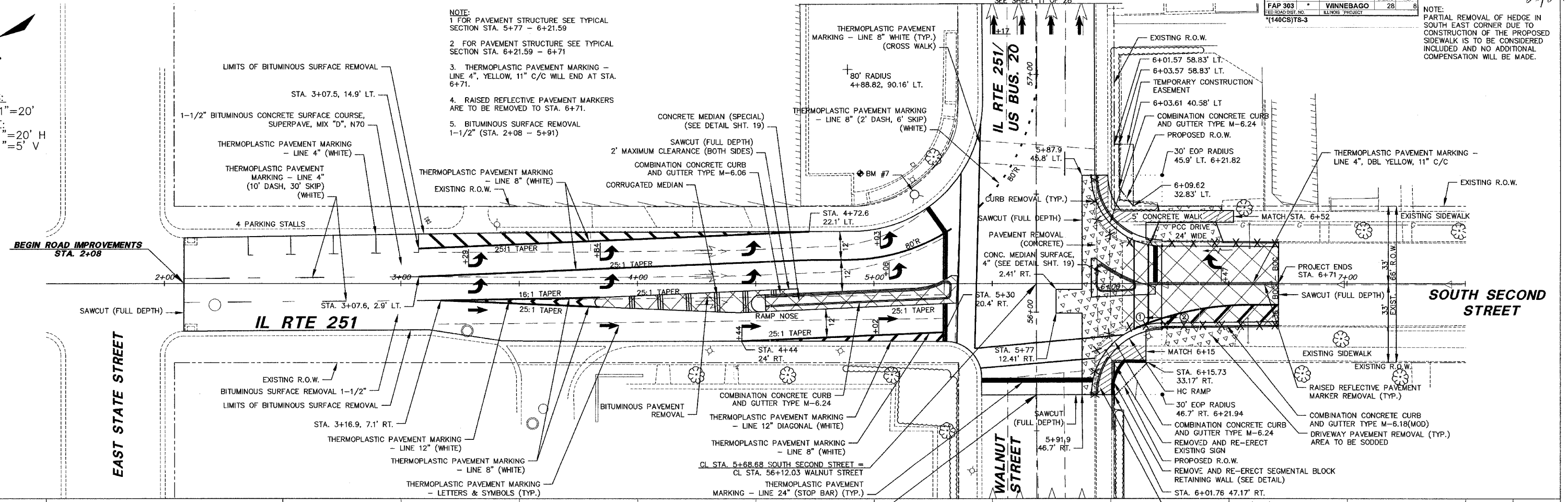

BENCHMARKS		
	DESCRIPTION	ELEVATION
765	BM #6: TOP OF SW BOLT ON FIRE HYDRANT AT THE NW CORNER OF WALNUT AND 3rd STREET.	760.64
760	BM #7: TOP OF SW BOLT ON FIRE HYDRANT AT THE NE CORNER OF WALNUT AND 2nd STREET.	751.59

NO.	ITEM	DATE

REVISIONS		
NO.	ITEM	DATE

PLOTTING SCALE: 1"=1'
 DRAWN BY: BSL
 CHECKED BY: JWH
 DATE: DECEMBER 1, 2004

McCLURE ENGINEERING ASSOCIATES, INC.
 7282 Argus Drive Rockford, Illinois 61107
 (815) 398-2332 FAX (815) 398-2498
 Design Firm License: Illinois #184-000816

PLAN AND PROFILE STA. 2+08 - 6+71
 CITY OF ROCKFORD
 ROCKFORD, ILLINOIS
 FILE NAME: H:\SecondSt-2004(HES)\2ndst-pp1.dwg SEC. 140CS-TS-3 JOB NUMBER: 04-28-04-045