

DESIGN		
INT.	DATE	REASON

PLOTS & CHECKS		
INT.	DATE	REASON

CHECKS		
INT.	DATE	REASON

STATE OF ILLINOIS
DEPARTMENT OF TRANSPORTATION

CURVE (C1) DATA (IL. RTE. 351) CURVE (C2) DATA (IL. RTE. 351) CURVE (C3) DATA (11TH STREET)

P.I. STA. 154+46.70 $\Delta = 23^\circ 25' 59''$ (LT.) $D = 17^\circ 30' 00''$ $T = 67.90'$ $L = 133.90'$ $R = 327.40'$ $E = 6.97'$ P.C. STA. 153+78.80 P.T. STA. 155+12.70	P.I. STA. 157+71.81 $\Delta = 30^\circ 03' 03''$ (RT.) $D = 17^\circ 30' 00''$ $T = 87.88'$ $L = 171.72'$ $R = 327.40'$ $E = 11.59'$ P.C. STA. 156+83.93 P.T. STA. 158+55.65	P.I. STA. 12+17.76 $\Delta = 3^\circ 22' 12''$ $D = 1^\circ 22' 38''$ $T = 122.39'$ $L = 244.71'$ $R = 4,160.52'$ $E = 1.80'$ P.C. STA. 10+95.37 P.T. STA. 13+40.08
---	--	---

F.A.U. RTE.	SECTION	COUNTY	TOTAL SHEETS	SHEET NO.
6108	***	L.A. SALLE	679	69
STA. _____ TO STA. _____		FED. ROAD DIST. NO. ILLINOIS FED. AID PROJECT		
*** (70X, 71X)RS-1, (71X-VBR)DM		CONTRACT NO. 66225		

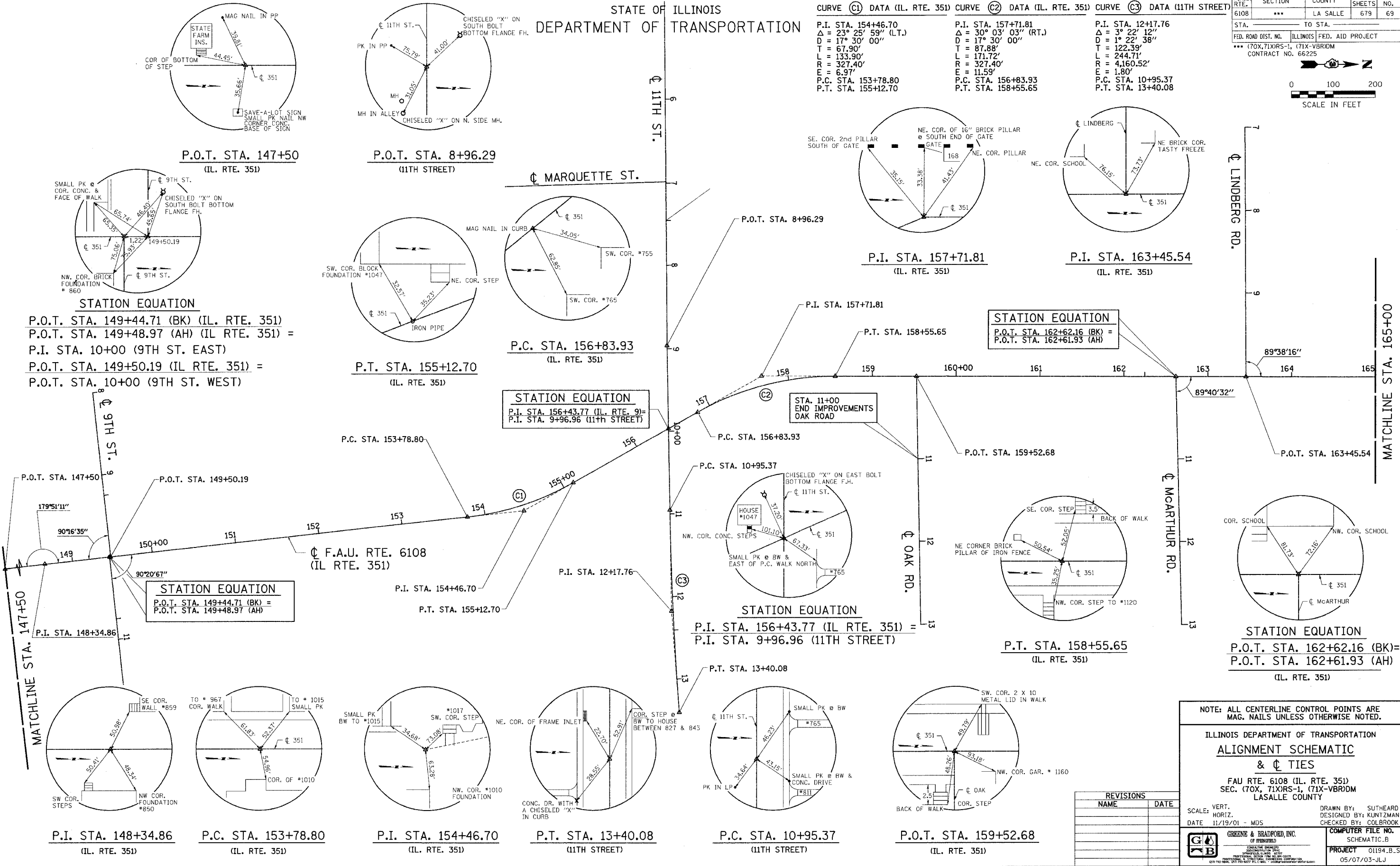
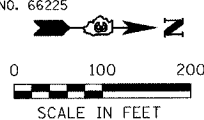

P.O.T. STA. 147+50
(IL. RTE. 351)

P.O.T. STA. 8+96.29
(11TH STREET)

P.I. STA. 157+71.81
(IL. RTE. 351)

P.I. STA. 163+45.54
(IL. RTE. 351)

P.C. STA. 156+83.93
(IL. RTE. 351)

P.T. STA. 155+12.70
(IL. RTE. 351)

STATION EQUATION
P.I. STA. 156+43.77 (IL. RTE. 9) =
P.I. STA. 9+96.96 (11TH STREET)

STATION EQUATION
P.O.T. STA. 162+62.16 (BK) =
P.O.T. STA. 162+61.93 (AH)

STATION EQUATION
P.O.T. STA. 149+44.71 (BK) =
P.O.T. STA. 149+48.97 (AH)

STATION EQUATION
P.I. STA. 156+43.77 (IL. RTE. 351) =
P.I. STA. 9+96.96 (11TH STREET)

STATION EQUATION
P.O.T. STA. 162+62.16 (BK) =
P.O.T. STA. 162+61.93 (AH)
(IL. RTE. 351)

NOTE: ALL CENTERLINE CONTROL POINTS ARE
MAG. NAILS UNLESS OTHERWISE NOTED.

ILLINOIS DEPARTMENT OF TRANSPORTATION
ALIGNMENT SCHEMATIC & TIES
FAU RTE. 6108 (IL. RTE. 351)
SEC. (70X, 71X)RS-1, (71X-VBR)DM
LASALLE COUNTY

REVISIONS	
NAME	DATE

SCALE: VERT. _____
HORIZ. _____
DATE 11/19/01 - MDS
DRAWN BY: SUTHEARD
DESIGNED BY: KUNTZMAN
CHECKED BY: COLBROOK
GREENE & BRADFORD, INC.
CONSULTING ENGINEERS
COMPUTER FILE NO. SCHEMATIC.B
PROJECT 01194.B.S
05/07/03-JLJ

\\s001\p1\1\checked.c.dgn 12/2/2004 5:25:18 PM User = gregj