

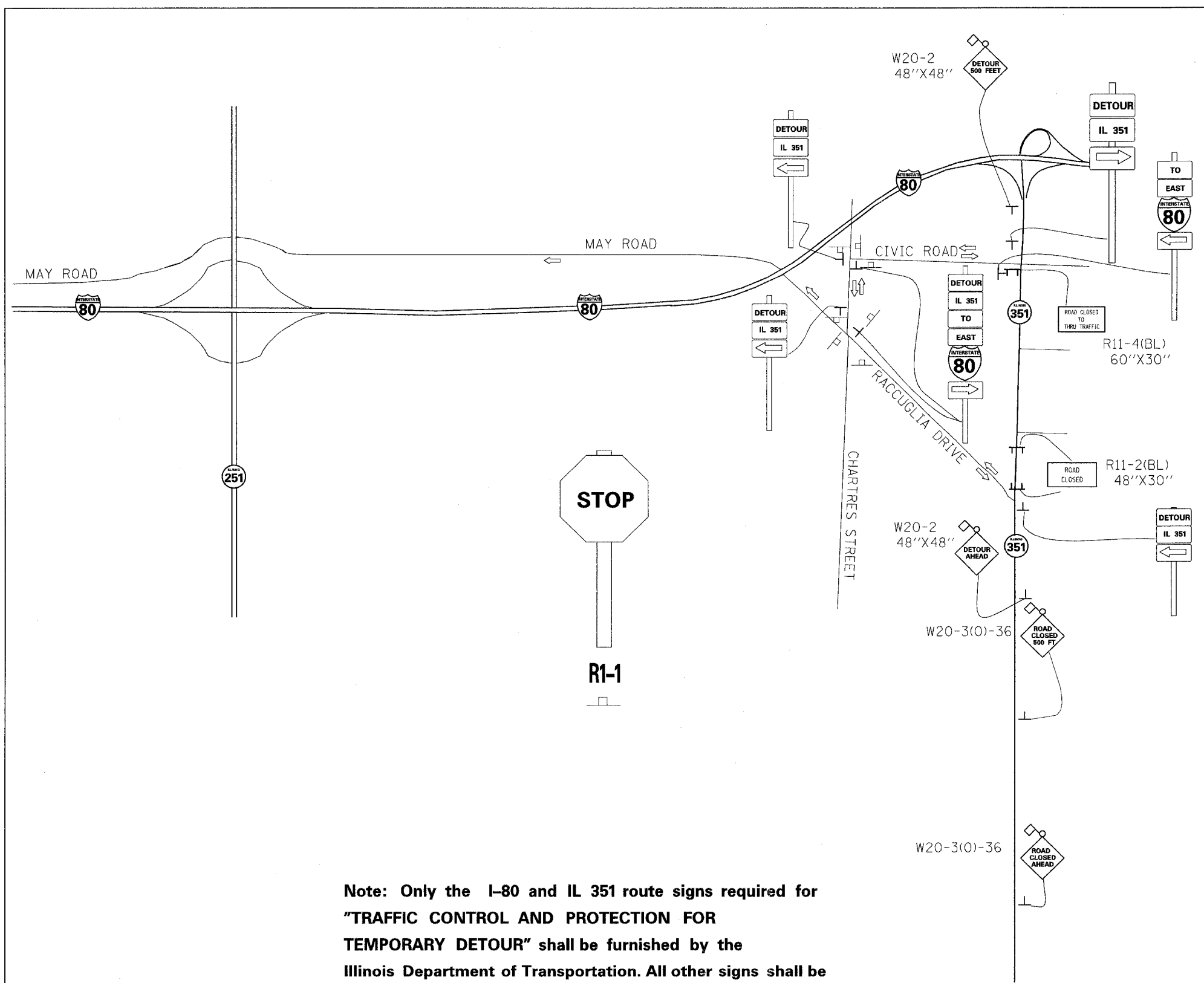





F.A.I. RTE.	SECTION	COUNTY	TOTAL SHEETS	SHEET NO.
6108	***	LA SALLE	679	111
STA.		TO STA.		
FED. ROAD DIST. NO.		ILLINOIS FED. AID PROJECT		
*** (70X,71X)RS-L (71X-V)BRDM		CONTRACT NO. 66225		

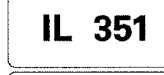

-  M4-8(O) 24"X12"
  -  M3-4(BL) 24"X12" OR M3-2(BL) 24"X12"
  -  M1-100(BL) 30"X24"
  -  M4-5(BL) 24"X12"
  -  M1-1 24"X24"
  -  M6-1(O) 21"X15" OR M5-1(O)
-  TYPE III BARRICADE\*

### DETOUR SIGNING

\*Place Type III barricades on shoulder except at bridge- barricades shall extend all the way across both lanes at bridge.

Note: Only the I-80 and IL 351 route signs required for "TRAFFIC CONTROL AND PROTECTION FOR TEMPORARY DETOUR" shall be furnished by the Illinois Department of Transportation. All other signs shall be supplied by the Contractor. Contact the Bureau of Operations at (815) 434-8446 three weeks prior to bridge closure.

REVISIONS		ILLINOIS DEPARTMENT OF TRANSPORTATION	
NAME	DATE	<h2>DETOUR SIGNING</h2>	
SCALE:	VERT. DATE	HORIZ.	DRAWN BY
			CHECKED BY

PLOT DATE = 04/15/04  
 PLOT SCALE = 1"=40'  
 PLOT SCALE = 1"=40'  
 REFERENCE = REF