

DESIGN		
INT. DATE	NO.	REASON

PLOTS & CHECKS		
INT. DATE	NO.	REASON

CHECKS		
INT. DATE	NO.	REASON

F.A.U. RTE.	SECTION	COUNTY	TOTAL SHEETS	SHEET NO.
6108	***	LA SALLE	679	114
STA. _____		TO STA. _____		
FED. ROAD DIST. NO. _____		ILLINOIS FED. AID PROJECT		
CONTRACT NO. 66225				

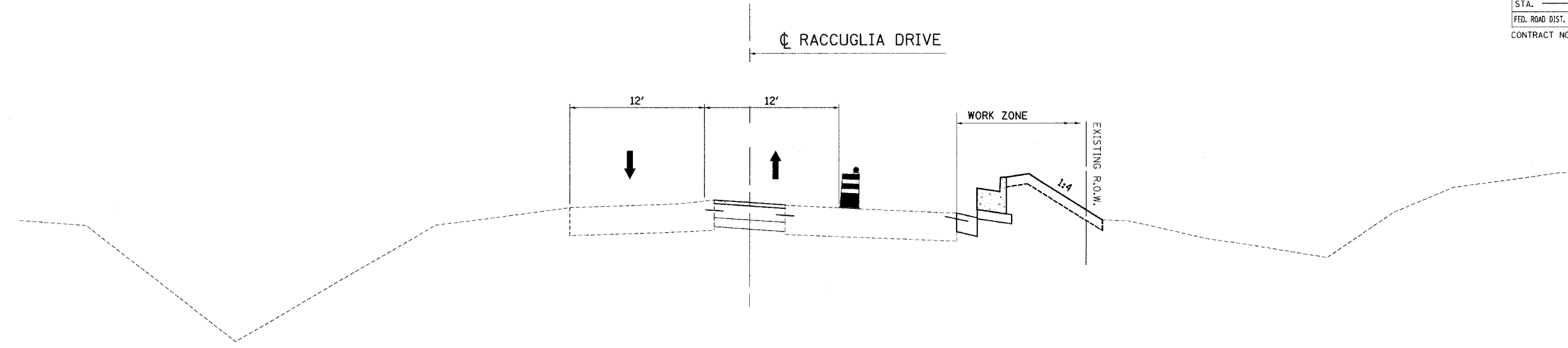

STAGE 2 TYPICAL SECTION
STA. 45+00 TO STA. 48+50 (RACCUGLIA)

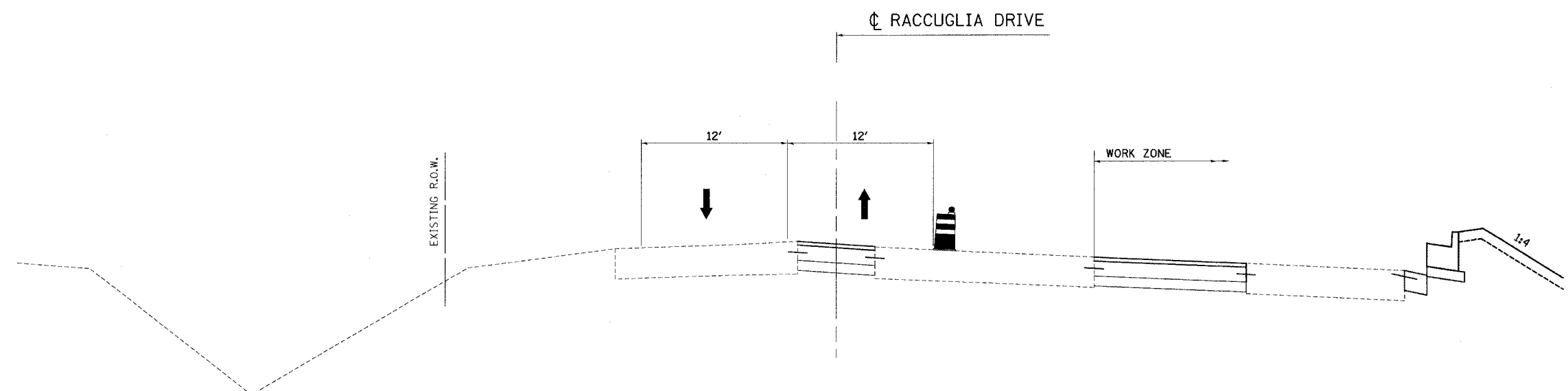

STAGE 2 TYPICAL SECTION
STA. 49+00 TO STA. 50+00 (RACCUGLIA)

ILLINOIS DEPARTMENT OF TRANSPORTATION
STAGE CONSTRUCTION
TYPICAL SECTIONS
FAU 6108 (IL RTE. 351)
SEC. (70X,71X)RS-1, (71X-VBR)DM
LA SALLE COUNTY

REVISIONS	
NAME	DATE

SCALE: VERT. _____
HORIZ. _____
DATE: 03/12/04
DRAWN BY: BISHOP
DESIGNED BY: KUNTZMAN
CHECKED BY: COLBROOK
COMPUTER FILE NO. STAGE TYP 1B
PROJECT: 01194
03/19/04-RPB



IDOTPL-5 1"=5' 8/07/00

FAU 6108 (IL. RTE. 351) LA SALLE COUNTY