

DESIGN		
INT.	DATE	REASON

F.A.U. RTE.	SECTION	COUNTY	TOTAL SHEETS	SHEET NO.
6108	***	LA SALLE	679	141
STA. 159+00		TO STA. 164+00		
FED. ROAD DIST. NO. [ILLINOIS] FED. AID PROJECT				
*** (70X, 71XRS-1, 71X-VBR)DM CONTRACT NO. 66225				

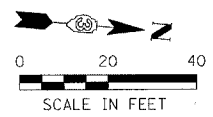

PLOTS & CHECKS		
INT.	DATE	REASON

FILE NAME = #FILES  
 PLOT SCALE = #PLOTTERS  
 PLOT DATE = #DATE  
 PLOT TIME = #TIME  
 OPERATOR = #USERS

CHECKS		
INT.	DATE	REASON

- (B) STA. 159+91.31, 33.09' LT EXISTING MANHOLE STORM RIM = 601.73 FL (E) = 598.80 FL (S) = 598.76 STRUCTURE CONNECTION FL = 598.85
- (50) STA. 162+88.12, 54.97' LT EXISTING MANHOLE STORM RIM = 605.47 MANHOLE TO REMAIN
- (51) STA. 163+20.30, 17.36' LT EXISTING MANHOLE, RIM = 602.61 (FILLED WITH WATER) MANHOLE TO BE REMOVED
- (52) STA. 163+25.45, 20.83' LT. EXISTING STORM INLET EP = 602.73 FL = 595.08 (FILLED WITH WATER) INLET TO BE REMOVED
- (53) STA. 163+57.06, 31.3' LT. EXISTING STORM INLET EP = 602.14 FL = 595.40 (FILLED WITH WATER) INLET TO BE REMOVED
- (54) STA. 162+51.77, 33.35' RT. EXISTING STORM INLET EP = 602.73 FL = 602.81 FL = 599.21 INLET TO BE REMOVED

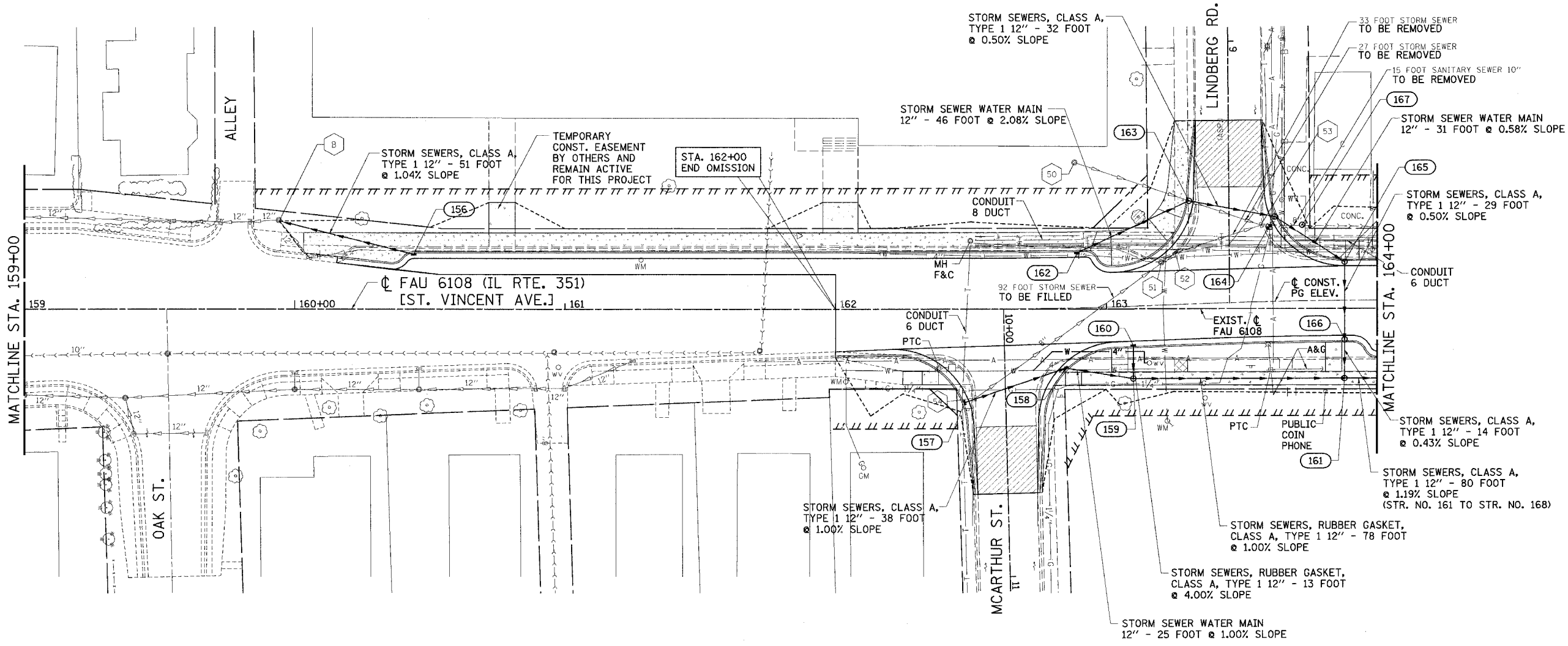

- (156) STA. 160+44, 20.5' LT. INLETS, TYPE A, TYPE 3 FRAME AND GRATE EP = 602.38 FL = 599.38
- (157) STA. 162+47.99, 35' RT. INLETS, TYPE A, TYPE 3 FRAME AND GRATE EP = 603.05 FL = 600.00
- (158) STA. 162+84.94, 22' RT. INLETS, TYPE B, TYPE 3 FRAME AND GRATE EP = 603.05 FL (N) = 599.62 FL (S) = 599.62
- (159) STA. 163+10, 26' RT. MANHOLES, TYPE A, 4'-DIAMETER, TYPE 1 FRAME, CLOSED LID RIM = 603.58 FL (N) = 599.37 FL (S) = 599.37 FL (W) = 599.52
- (160) STA. 163+10, 13.55' RT. INLETS, TYPE A, TYPE 3 FRAME AND GRATE EP = 603.07 FL = 600.04
- (161) STA. 163+88, 26' RT. MANHOLES, TYPE A, 4'-DIAMETER, TYPE 1 FRAME, CLOSED LID RIM = 603.32 FL (S) = 598.59 FL (N) = 598.59 FL (W) = 598.59
- (162) STA. 162+89.07, 20.91' LT. INLETS, TYPE A, TYPE 3 FRAME AND GRATE EP = 603.07 FL = 600.09
- (163) STA. 163+30.48, 40.4' LT. MANHOLES, TYPE A, 4'-DIAMETER, TYPE 15 FRAME AND LID EP = 602.77 FL (S) = 599.14 FL (N) = 599.14
- (164) STA. 163+62.08, 34.47' LT. MANHOLES, TYPE A, 4'-DIAMETER, TYPE 15 FRAME AND LID EP = 602.86 FL (S) = 598.98 FL (NE) = 598.98
- (165) STA. 163+88, 17.46' LT. MANHOLES, TYPE A, 4'-DIAMETER, TYPE 15 FRAME AND LID EP = 602.73 FL (E) = 598.80 FL (SW) = 598.80
- (166) STA. 163+88.00, 11.54' RT. MANHOLES, TYPE A, 4'-DIAMETER, TYPE 15 FRAME AND LID EP = 602.73 FL (E) = 598.65 FL (W) = 598.65
- (167) STA. 163+72.28, 31.37' LT. SANITARY SEWER MANHOLE MANHOLES, TYPE A, 4'-DIAMETER, TYPE 1 FRAME, CLOSED LID EP = 602.80 FL = 594.80±

**CONTAMINATION SITE:**  
 EXCAVATION NOT TO EXCEED LISTED DEPTH UNLESS APPROVED BY ENGINEER.

0'	
2'	
3'	
4'	
6'	

REVISIONS	
NAME	DATE
MABUS	09/08/03

ILLINOIS DEPARTMENT OF TRANSPORTATION  
**DRAINAGE & UTILITIES PLAN**

FAU 6108 (IL. RTE. 351)  
 SECTION (70X, 71XRS-1, (71X-VBR)DM  
 LASALLE COUNTY

SCALE: VERT. \_\_\_\_\_  
 HORIZ. \_\_\_\_\_  
 DATE: 06/30/03

DESIGNED BY: MABUS  
 CHECKED BY: COLBROOK

GREENE & BRADFORD, INC.  
 OF SPRINGFIELD  
 CIVIL ENGINEERS  
 PROFESSIONAL ENGINEERS  
 LICENSE NO. 0687  
 PROFESSIONAL ENGINEERS

COMPUTER FILE NO.  
 SS351B-03  
 PROJECT: 01194\_B.S  
 04/27/04-RPB

IDOTPL-20 1"=20' 8/07/00

DRAINAGE & UTILITIES FAU RTE. 6108 (IL RTE. 351) LASALLE CO.