

DESIGN		
INT.	DATE	REASON

BY		DATE

PLOTS & CHECKS		
INT.	DATE	REASON

BY		DATE

CHECKS		
INT.	DATE	REASON

SECTION	COUNTY	TOTAL SHEETS	SHEET NO.
6108	LA SALLE	679	544
STA. 217+50.00 TO STA. 217+72.55			
FED. ROAD DIST. NO. 70X, 71X, 71RS-1, (71X-VBR)DM			
CONTRACT NO. 66225			

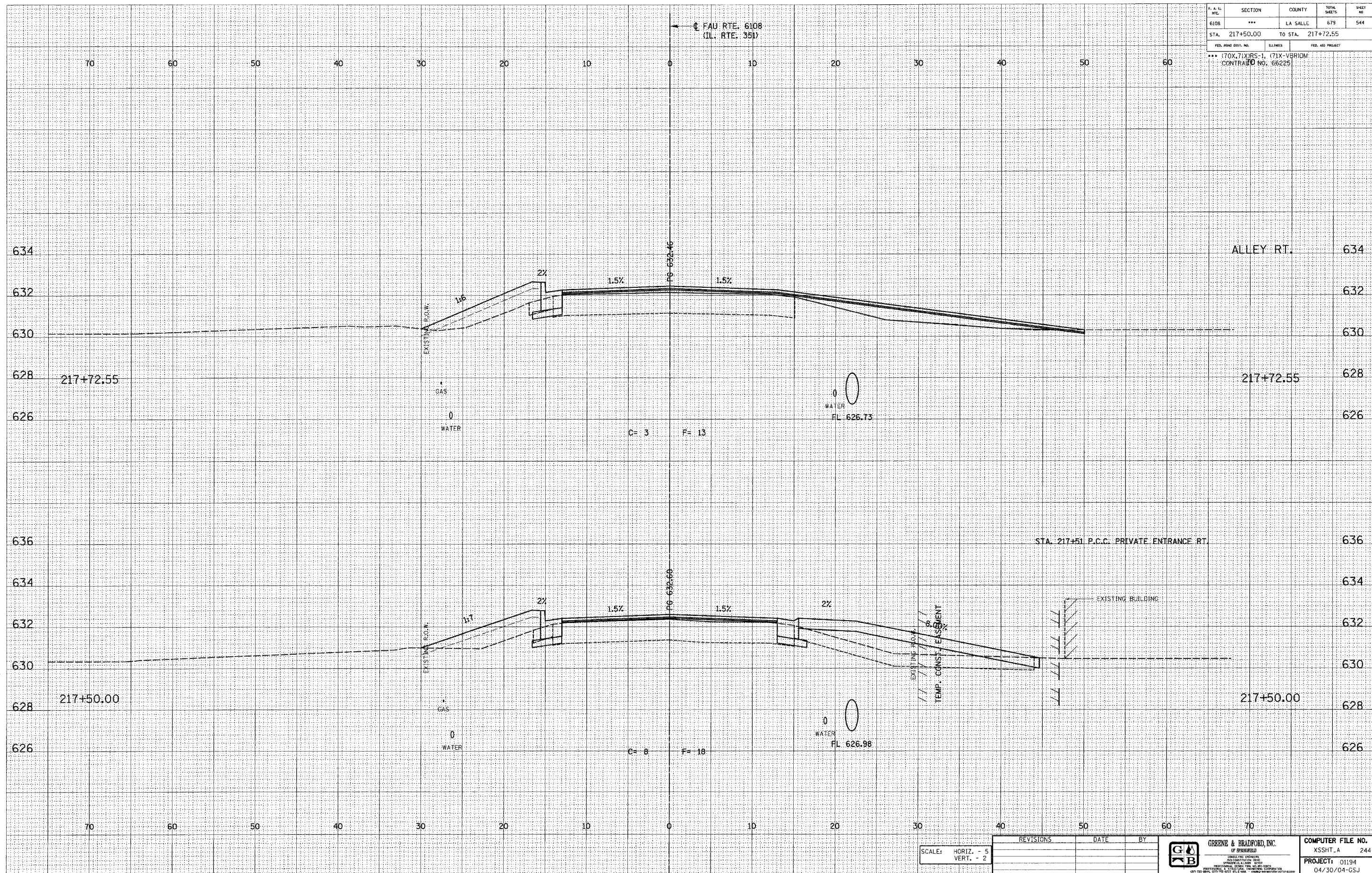

E-XSEC 1st 8/25/98

SCALE: HORIZ. - 5  
VERT. - 2

REVISIONS	DATE	BY

**GREENE & BRADFORD, INC.**  
OF SPRINGFIELD  
SURVEYING ENGINEERS  
REGISTERED PROFESSIONAL ENGINEERS  
STATE OF ILLINOIS  
OFFICE: 1101 S. WASHINGTON ST., SPRINGFIELD, IL 62761  
PHONE: (217) 522-2200 FAX: (217) 522-2201  
WWW.GREENE-AND-BRADFORD.COM

COMPUTER FILE NO.  
XSSHT\_A 244  
PROJECT: 01194  
04/30/04-GSJ

FAU RTE. 6108 (IL. RTE. 351) LA SALLE CO.

\\s00n1\p01\cadd\2004\204\_194.dwg 1/27/2005 2:54:39 PM User: gregj