

P.A.U. SECTION COUNTY TOTAL SHEETS SHEET NO.
6194 (K 109)R, RS-4 KANKAKEE 82 25
STA. TO STA.
FED. ROAD DIST. NO. ILLINOIS FED. AID PROJECT 66402

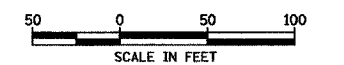

DATE	BY
DATE	BY

DATE	BY
DATE	BY

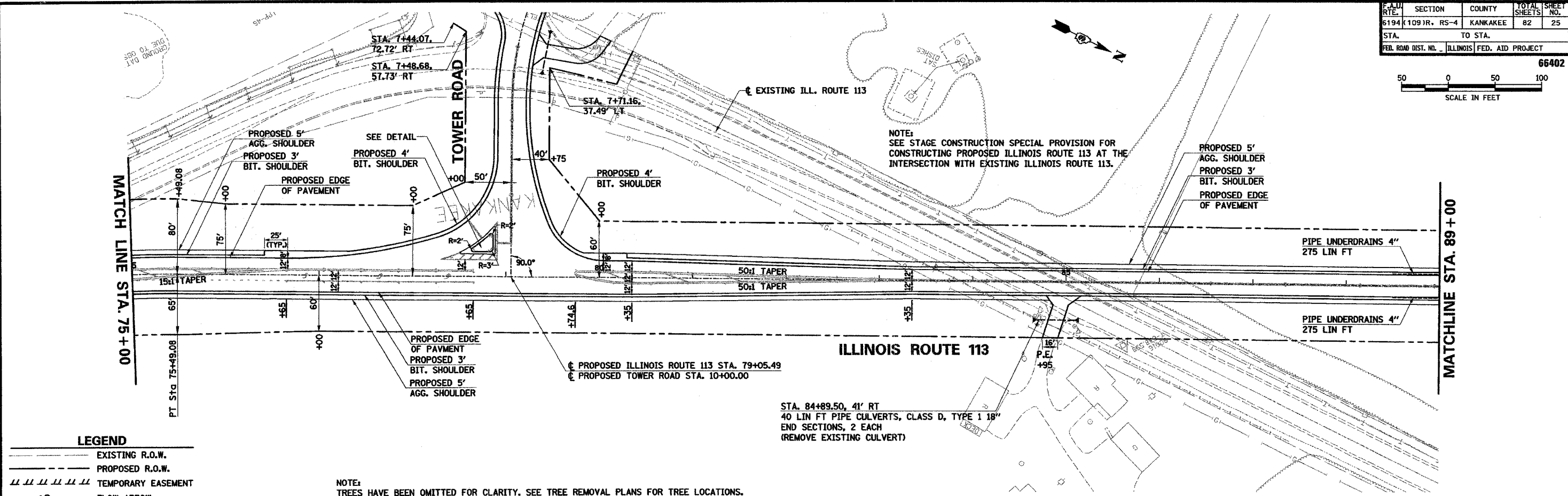

LEGEND

- EXISTING R.O.W.
- PROPOSED R.O.W.
- TEMPORARY EASEMENT
- FLOW ARROW

NOTE:
TREES HAVE BEEN OMITTED FOR CLARITY. SEE TREE REMOVAL PLANS FOR TREE LOCATIONS.

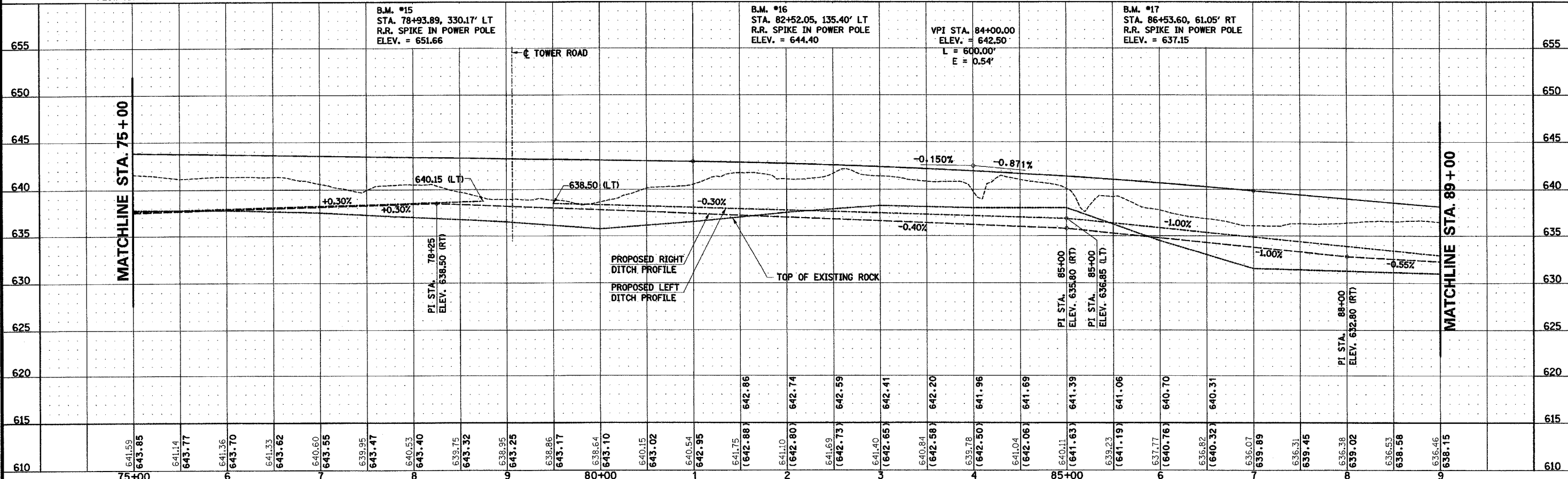

*****DATE*****

ILLINOIS ROUTE 113 STA. 75+00 TO STA. 89+00 - PLAN AND PROFILE