

P.A.U. SECTION COUNTY TOTAL SHEETS SHEET NO.	6194 (109)R, RS-4 KANKAKEE 82 27
STA. TO STA.	
FED. ROAD DIST. NO. ILLINOIS FED. AID PROJECT	66402

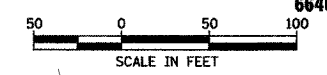

PI STA. = 100+41.18  
 $\Delta = 48^\circ 29' 53''$  (LT)  
 $D = 4^\circ 46' 29''$   
 $R = 1,200.00'$   
 $T = 540.54'$   
 $L = 1,015.74'$   
 $E = 116.12'$   
 $e = 5.9\%$   
 $T.R. = 39'$   
 $S.E. RUNOFF = 151'$   
 $P.C. STA. = 95+00.64$   
 $P.T. STA. = 105+16.38$

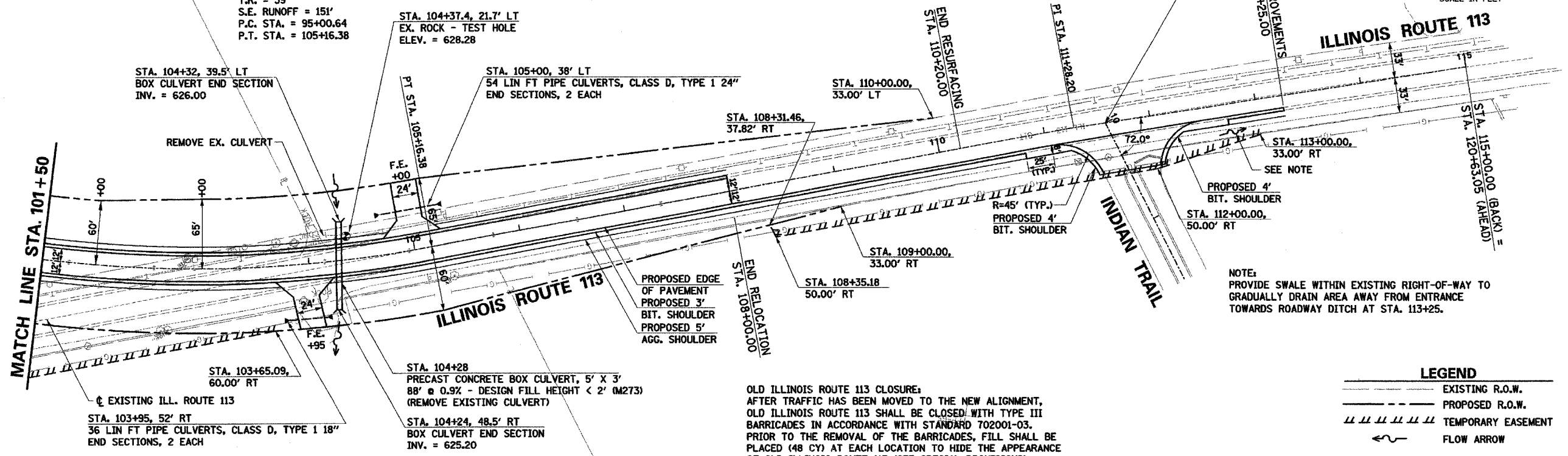

NOTE:  
 PROVIDE SWALE WITHIN EXISTING RIGHT-OF-WAY TO GRADUALLY DRAIN AREA AWAY FROM ENTRANCE TOWARDS ROADWAY DITCH AT STA. 113+25.

**LEGEND**

	EXISTING R.O.W.
	PROPOSED R.O.W.
	TEMPORARY EASEMENT
	FLOW ARROW

OLD ILLINOIS ROUTE 113 CLOSURE:  
 AFTER TRAFFIC HAS BEEN MOVED TO THE NEW ALIGNMENT, OLD ILLINOIS ROUTE 113 SHALL BE CLOSED WITH TYPE III BARRICADES IN ACCORDANCE WITH STANDARD 702001-03. PRIOR TO THE REMOVAL OF THE BARRICADES, FILL SHALL BE PLACED (48 CY) AT EACH LOCATION TO HIDE THE APPEARANCE OF OLD ILLINOIS ROUTE 113 (SEE SPECIAL PROVISIONS).

DATE	
BY	
REVISIONS	
PLANNED	
ALTERNATE	
DESIGNED	
CHECKED	
NOTE BOOK	
NO.	

DATE	
BY	
REVISIONS	
PLANNED	
ALTERNATE	
DESIGNED	
CHECKED	
NOTE BOOK	
NO.	

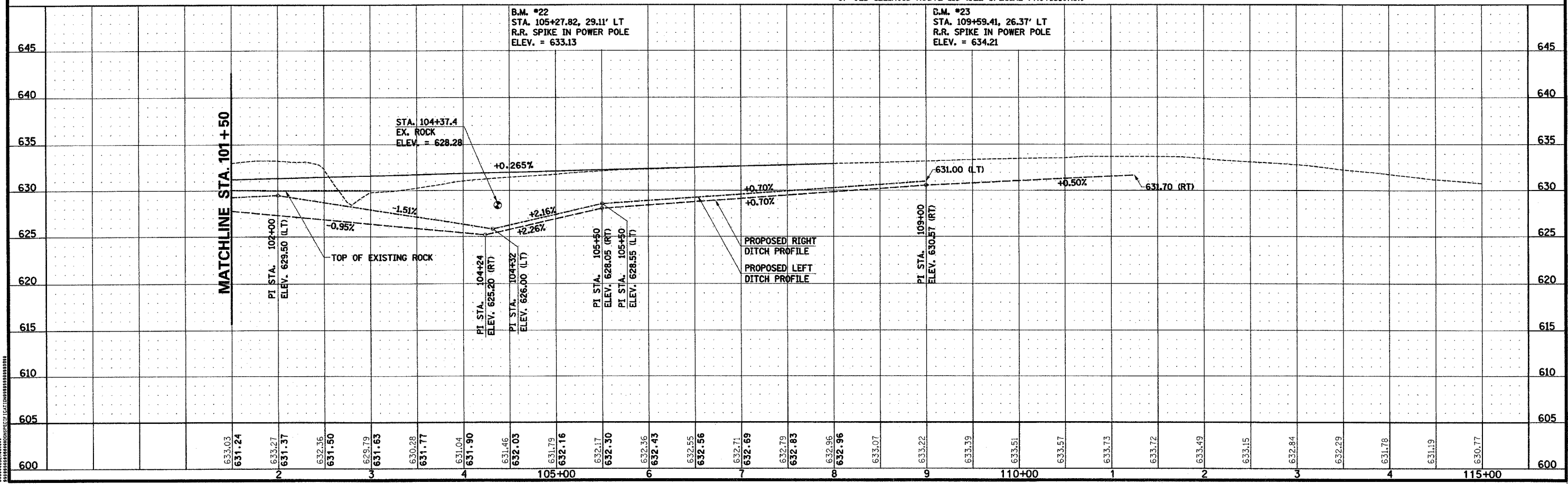

\*\*\*\*\*DATE\*\*\*\*\*

ILLINOIS ROUTE 113 STA. 101+50 TO STA. 108+00 - PLAN AND PROFILE