

| | | | | |
|---------------------|---------|---------------------------|--------------|-----------|
| F.A.S. RTE. | SECTION | COUNTY | TOTAL SHEETS | SHEET NO. |
| 1517 | 1N | MCLEAN | 21 | 11 |
| STA. | | TO STA. | | |
| FED. ROAD DIST. NO. | | ILLINOIS FED. AID PROJECT | | |

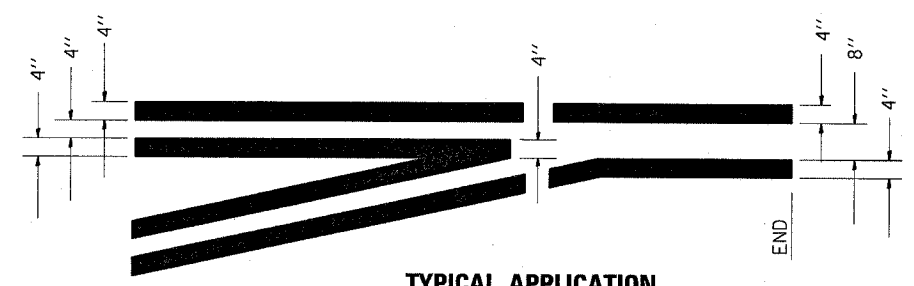
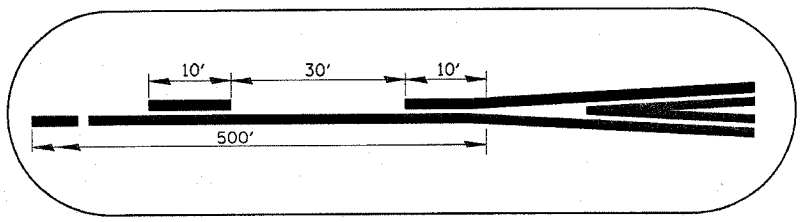
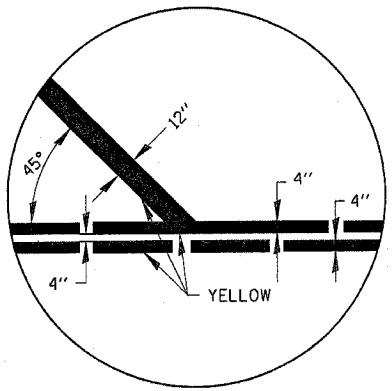

EXISTING HORIZONTAL CURVE DATA
 P.I. STA= 385+58.48
 P.C. STA= 380+47.83
 P.T. STA= 390+64.83
 $\Delta = 12^{\circ}52'55''$
 $T = 510.65'$
 $R = 4523.35'$
 $D = 1^{\circ}16'00''$
 $L = 1017.00'$
 $E = 28.73'$
 $S.E. = 0.021 \text{ FT/FT}$
 $S.E. \text{ ATTAINED STA. } 379+04.50 \text{ TO STA. } 381+19.50$
 $S.E. \text{ REMOVED STA. } 389+93.16 \text{ TO STA. } 392+08.16$

2-CTR. CURVE
 $R1 = 30'$
 $R2 = 175'$
 $O/S = 6.5'$

SEE DETAILS FOR APPROACH PAVEMENT MARKING

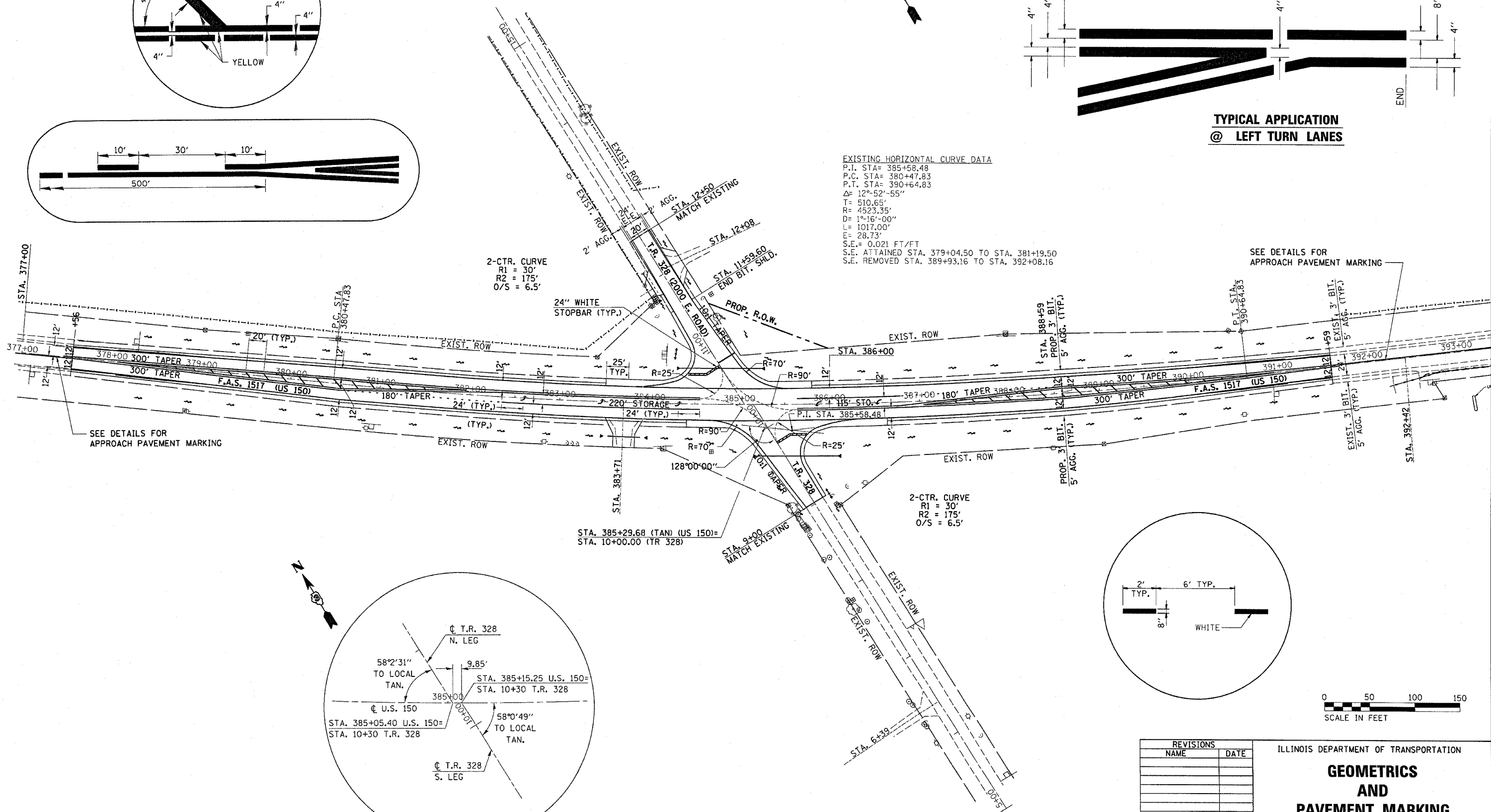

SEE DETAILS FOR APPROACH PAVEMENT MARKING

2-CTR. CURVE
 $R1 = 30'$
 $R2 = 175'$
 $O/S = 6.5'$

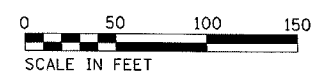
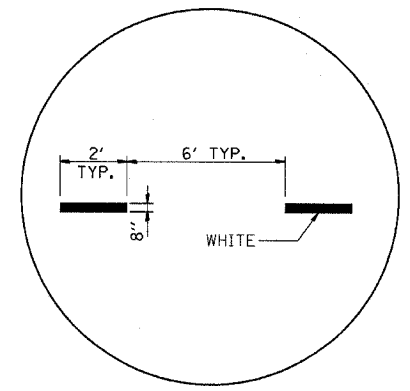
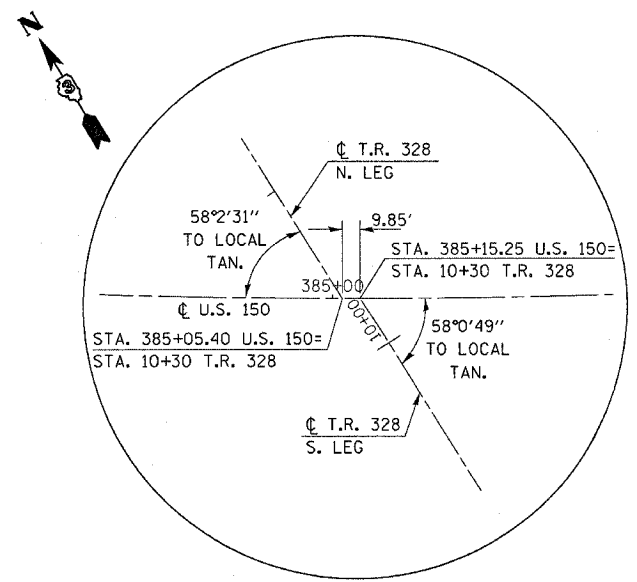

| REVISIONS | |
|-----------|------|
| NAME | DATE |
| | |
| | |
| | |
| | |
| | |
| | |
| | |
| | |
| | |
| | |

ILLINOIS DEPARTMENT OF TRANSPORTATION
GEOMETRICS AND PAVEMENT MARKING
 SCALE: VERT. _____
 DATE _____ HORIZ. _____
 DRAWN BY _____
 CHECKED BY _____