

T11N, R7E, SECTION 27

F.A.I. RTE.	SECTION	COUNTY	TOTAL SHEETS	SHEET NO.
57		**	76	32
STA. 319+00	TO STA. 351+00			
FED. ROAD DIST. NO.	ILLINOIS	FED. AID PROJECT		
CONTRACT NO. 70028				
• (15,18-20) RS-2 (15-22) RS-2				
••COLES & CUMBERLAND				

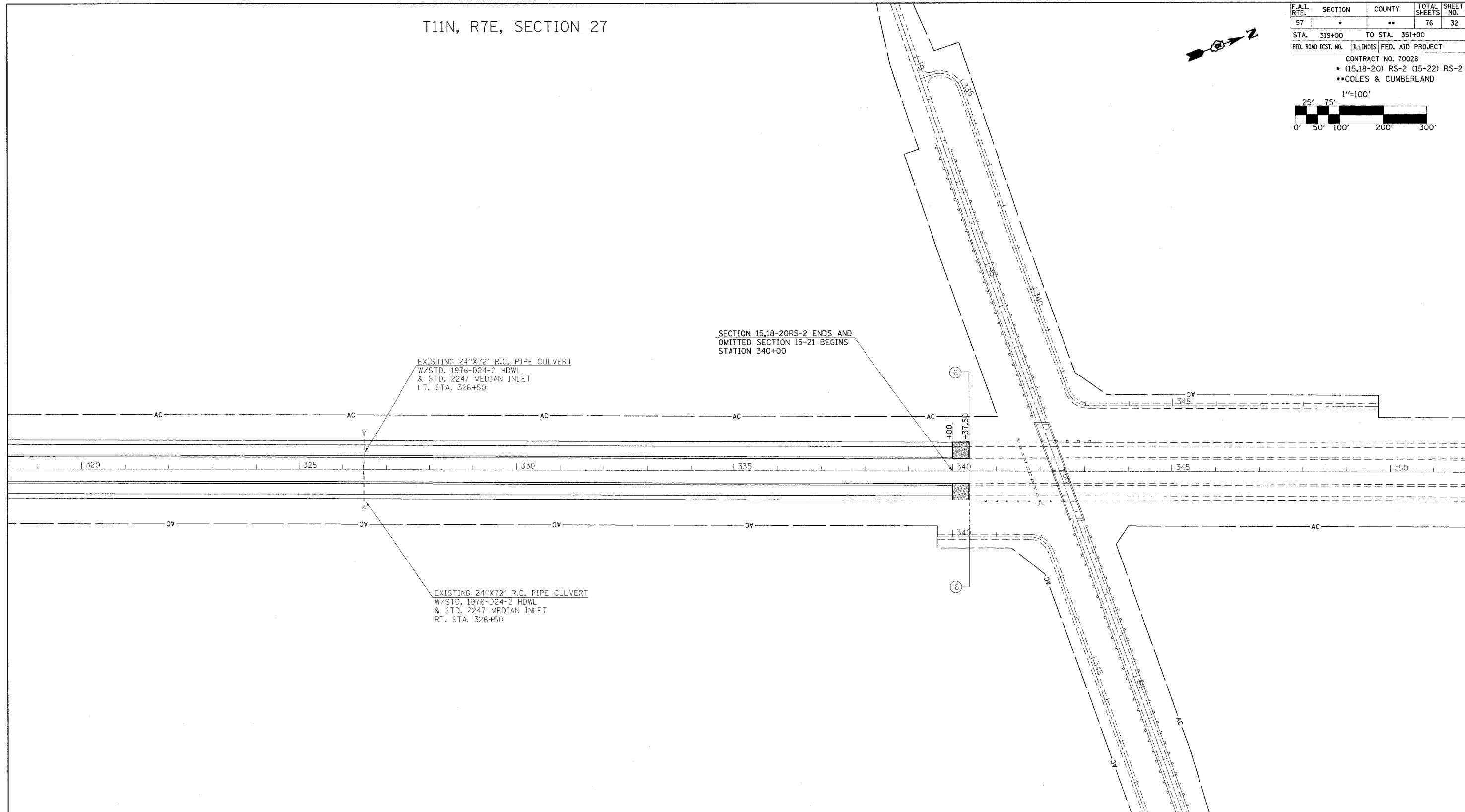
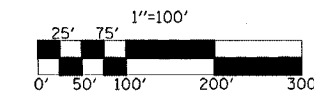

EXISTING 24"X72" R.C. PIPE CULVERT  
W/STD. 1976-D24-2 HDWL  
& STD. 2247 MEDIAN INLET  
LT. STA. 326+50

SECTION 15,18-20RS-2 ENDS AND  
OMITTED SECTION 15-21 BEGINS  
STATION 340+00

EXISTING 24"X72" R.C. PIPE CULVERT  
W/STD. 1976-D24-2 HDWL  
& STD. 2247 MEDIAN INLET  
RT. STA. 326+50

 BITUMINOUS SURFACE REMOVAL, BUTT-JOINT  
(FOR BUTT-JOINT DETAILS SEE SHEET 49.)

REVISIONS		ILLINOIS DEPARTMENT OF TRANSPORTATION
NAME	DATE	

SCALE: \_\_\_\_\_ DATE \_\_\_\_\_ DRAWN BY \_\_\_\_\_ CHECKED BY \_\_\_\_\_