

FAP ROUTE	SECTION	COUNTY	TOTAL SHEETS	SHEET NO
312	71BR	RANDOLPH	13	73
STA.	TO STA.			
CONTRACT NO.: 76125				

**SIGNS REQUIRED**

MAX WIDTH  
9 FT. 6 IN.  
4 MILES AHEAD (3) **ILLINOIS 3** (4)

MAX WIDTH  
9 FT. 6 IN.  
1 MILES AHEAD (2) **NORTH** (3)  
**SOUTH** (1)

MAX WIDTH  
9 FT. 6 IN.  
2 MILES AHEAD (2)

MAX WIDTH  
9 FT. 6 IN.  
6 MILES AHEAD (1)

MAX WIDTH  
9 FT. 6 IN.  
20 MILES AHEAD (1)

PLAN	SURVEYED	BY	DATE
	PLANNED		
	CHECKED		
	BY		
	NO. OF WAY CHECKED		
	NO.		
	CADD FILE NAME		

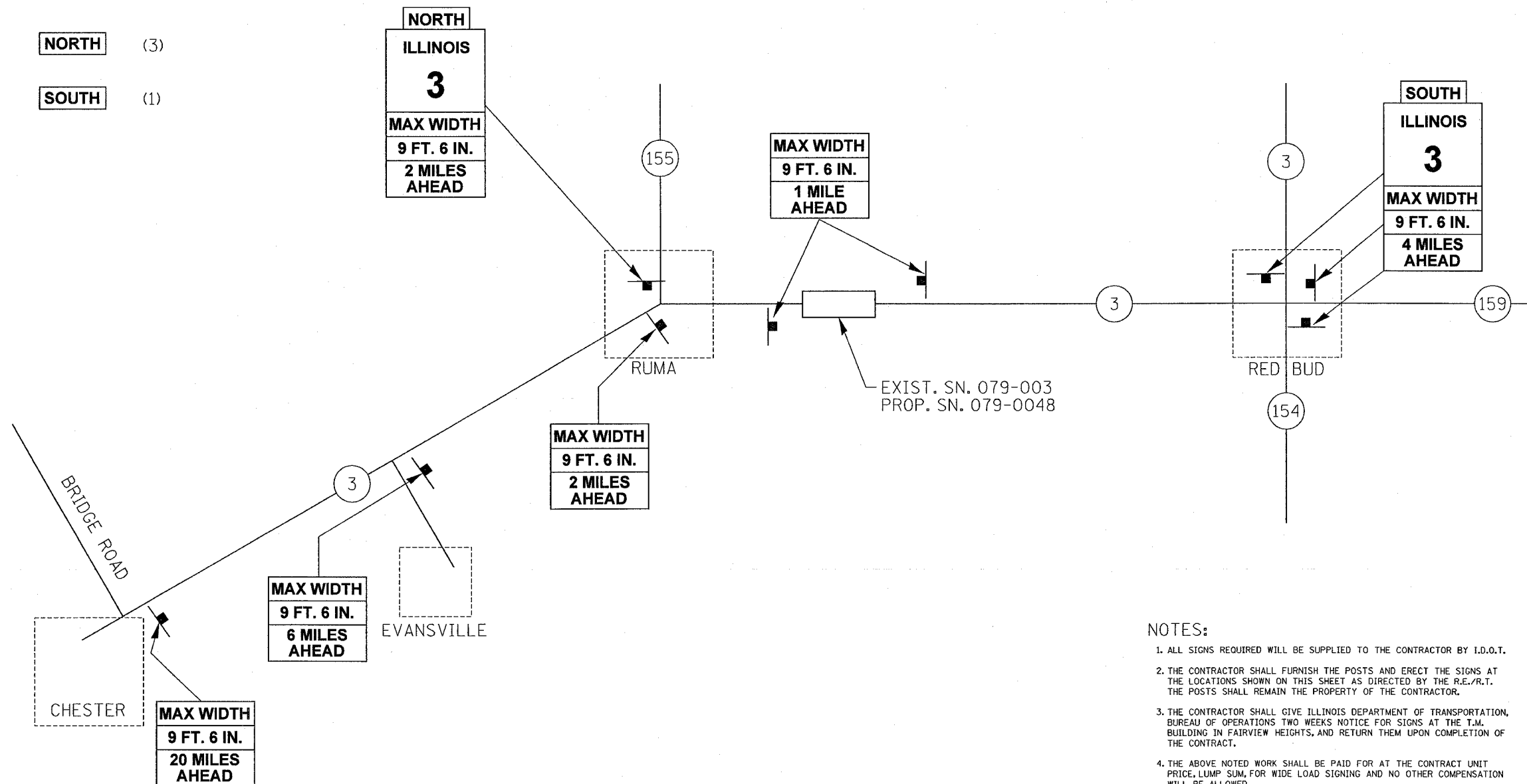

**NOTES:**

1. ALL SIGNS REQUIRED WILL BE SUPPLIED TO THE CONTRACTOR BY I.D.O.T.
2. THE CONTRACTOR SHALL FURNISH THE POSTS AND ERECT THE SIGNS AT THE LOCATIONS SHOWN ON THIS SHEET AS DIRECTED BY THE R.E./R.T. THE POSTS SHALL REMAIN THE PROPERTY OF THE CONTRACTOR.
3. THE CONTRACTOR SHALL GIVE ILLINOIS DEPARTMENT OF TRANSPORTATION, BUREAU OF OPERATIONS TWO WEEKS NOTICE FOR SIGNS AT THE T.M. BUILDING IN FAIRVIEW HEIGHTS, AND RETURN THEM UPON COMPLETION OF THE CONTRACT.
4. THE ABOVE NOTED WORK SHALL BE PAID FOR AT THE CONTRACT UNIT PRICE, LUMP SUM, FOR WIDE LOAD SIGNING AND NO OTHER COMPENSATION WILL BE ALLOWED.
5. SIGN SPACING SHALL BE 400' OR TO FIT FIELD CONDITIONS.
6. THE HEIGHT TO THE BOTTOM OF THE LOWEST SIGN SHALL NOT BE LESS THAN 6'-0".

REVISIONS	
NAME	DATE

ILLINOIS DEPARTMENT OF TRANSPORTATION  
**WIDE LOAD SIGNING LOCATIONS**  
  
FAP ROUTE 312  
SECTION 71BR  
RANDOLPH COUNTY  
SN 079-0048

DRAWN BY: