

FAP ROUTE	SECTION	COUNTY	TOTAL SHEETS	SHEET NO
586	60R-2,37R-1	MADISON	502	102
STA. 566+00		TO STA. 572+00		
CONTRACT NO. 76301				

(31L) INLET TY A W/
 TY 8 FR & GR
 STA. 571+39.8, 30.6' LT
 GRATE ELEV. = 545.10
 FL ELEV. = 543.73

(32L) INLET TY A W/
 TY 3V FR & GR
 STA. 571+39.8, 24.5' LT
 GRATE ELEV. = 545.44
 FL ELEV. = 543.39

FL ELEV = 547.90

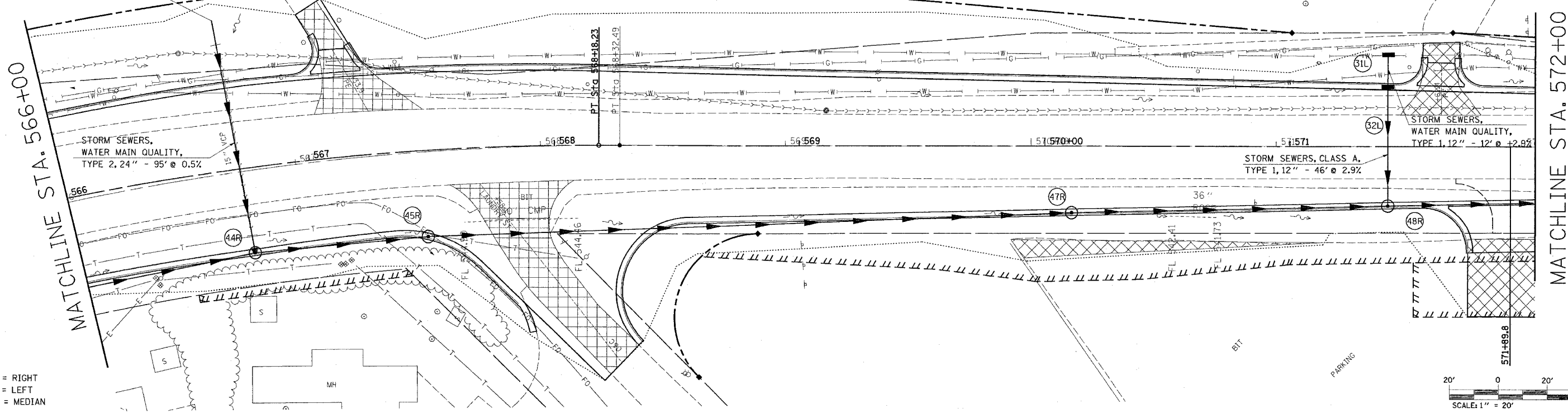

R = RIGHT
 L = LEFT
 M = MEDIAN

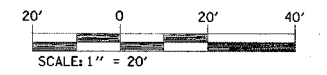

MATCHLINE STA. 572+00

PLAN	SURVEYED	DATE
NO.		
BY		
DATE		

PROFILE	SURVEYED	DATE
NO.		
BY		
DATE		

PROPOSED STORM SEWER PROFILE - RIGHT

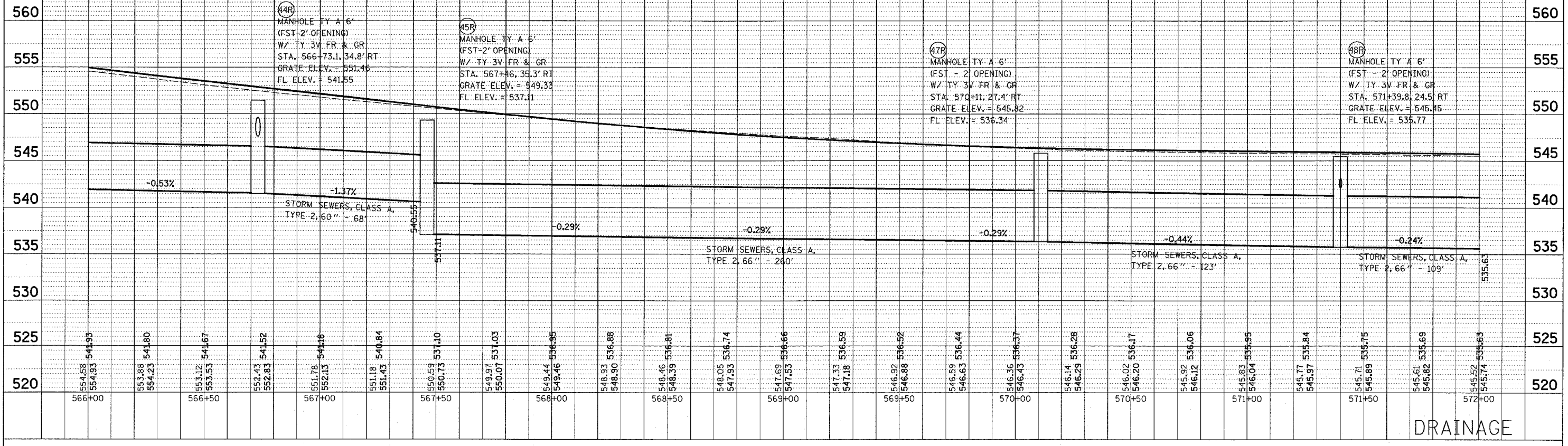

DRAINAGE

12/1/2004
 Wednesday, December 01, 2004 @ 9:57:44 AM
 C:\p\projects\60583\plan\60583.dwg LVI-54-56-63
 C:\p\projects\60583\profile\60583.dwg LVI-54-56-63
 C:\p\projects\60583\plan\60583.dwg LVI-54-56-63
 C:\p\projects\60583\profile\60583.dwg LVI-54-56-63
 C:\p\projects\60583\plan\60583.dwg LVI-54-56-63
 C:\p\projects\60583\profile\60583.dwg LVI-54-56-63